



On-going PROJECTS



SOWPARNIKA SWASTIKA
Bangalore



SOWPARNIKA CHANDRAKANTHA
Off Sarjapur Road, Bangalore



ROYALE SPLENDOUR
Vijayanagar 3rd Stage, Mysore



SOWPARNIKA SAI SRISHTI
Near Hoskote

Completed Projects



SOWPARNIKA SKANDAGIRI
Coimbatore



SOWPARNIKA SAI GOPAL
Coimbatore



SOWPARNIKA SKANDA
Near Hoodi Village



SAI SOWPARNIKA
Near ITPL



SOWPARNIKA ANANDA
Sarjapur Road



SOWPARNIKA SAIKRISHNA
Sarjapur Road, Bangalore



SOWPARNIKA ABODE
AECS Layout, Kundanahalli



SOWPARNIKA USHA KIRAN
AECS Layout, Kundanahalli



Sowparnika Projects and Infrastructure Private Limited

Corporate office: No 750, 1st Main Road 'C' Block, AECS Layout, Bangalore-560037
Tel: 080 42433000. www.sowparnikaprojects.com

Bangalore | Thiruvananthapuram | Coimbatore | Mysore | Changanassery | Tirupur



Affordable Housing of the Year
NDTV Profit Real Estate Awards 2012



WINNER
BEST AFFORDABLE
HOUSING
SOWPARNIKA SAI SRISHTI
BANGALORE
REAL ESTATE AWARDS

Let life take
a meaningful course



Comfortable living is what we all aspire for, and it is best enjoyed in a Sowparnika Sanvi home. Comprising of 216 lavishly crafted apartments in Whitefield, Sowparnika Sanvi is spread over 2 scenic acres. This blissful project offers you many amenities that will make your life a relaxed affair.

Sanvi is another ambitious venture by Sowparnika Projects, South India's premier property developer who is constructing over 2.5 million sq. ft of ongoing projects and has an experience of completing over 2 million sq. ft. of projects, with an impeccable on-time delivery record.



Dictate your future from your luxurious abode

Sanvi is the answer to the home you always desired. With 216 options of 2 & 3 BHK homes of various sizes spread over 2 acres, you will be able to find a home that you can call your own and fall in love with. Sowparnika is well known for its quality construction, impeccable delivery timing and the world-class facilities it provides. With Sowparnika, you will get what you are looking for in a home, and then some more.

Take a pause and smell the flowers

Greenery is an oft-overlooked luxury in present day, and At Sowparnika Sanvi, you will be able to experience it aplenty. With well-kept parks and landscaped gardens, Sowparnika Sanvi provides you with a lush environment to relax and rest.

- Landscaped garden

Flex your sporting muscles

We at Sanvi know you take your fitness seriously; that's why we have left no stone unturned to bring you the best fitness and gaming options. You can work out or do cardio in the gymnasium, go for a refreshing swim, stay active by playing the multitude of indoor games on offer, or try them all.

Rejuvenate at the clubhouse

The clubhouse at Sowparnika Sanvi comes with all the world class amenities you need. Whatever you choose to indulge in, you will surely have a great time relaxing.



Indoor Games



Swimming pool



Gymnasium

Nourish the talents of your children

Sanvi has an exclusive play area for your children, in addition to the parks and gardens. With plenty of space to play around, your kids will surely play better and learn better too.



Club House



Children's play area



Gardens



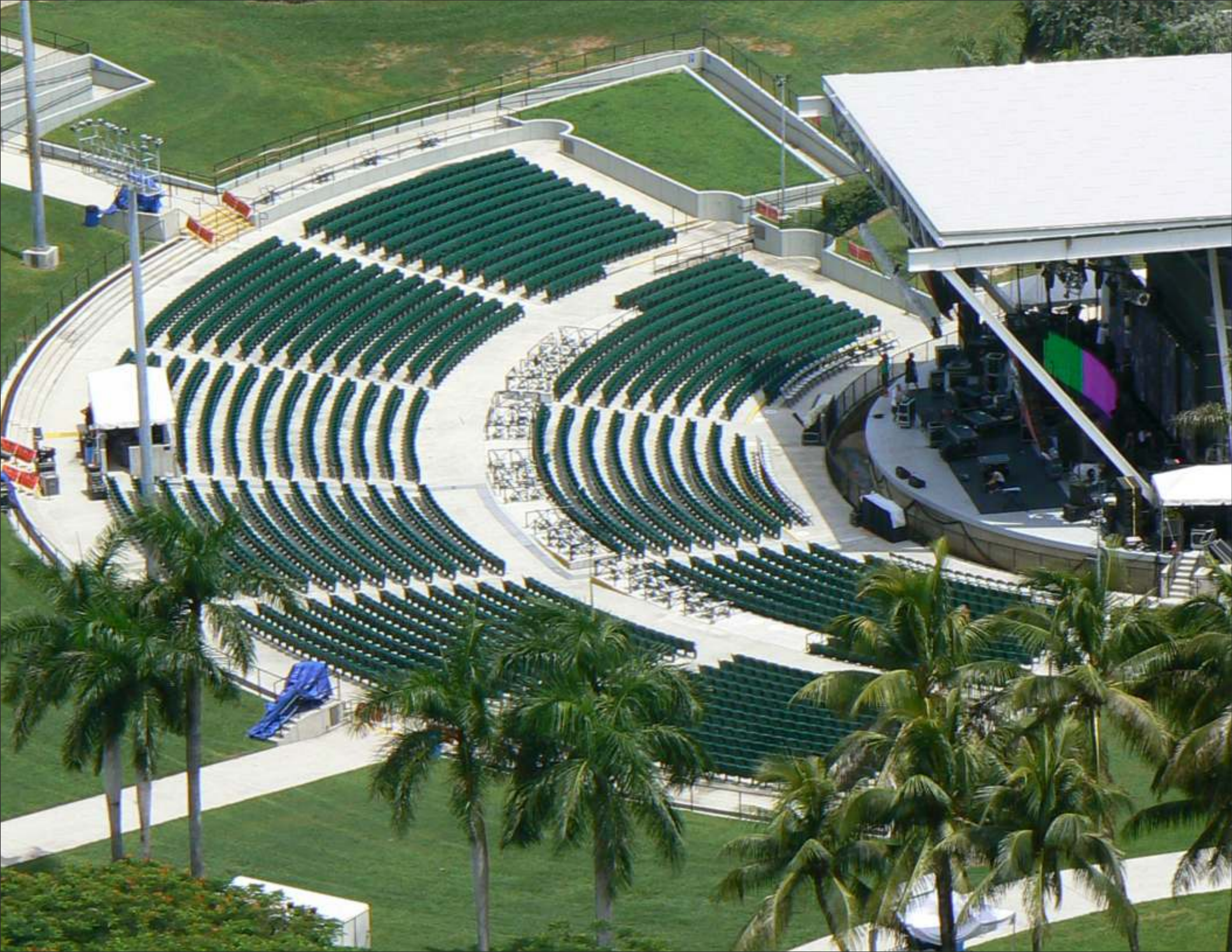

Celebrate and enjoy at the Amphitheatre

Gatherings take a different meaning at the Sanvi amphitheatre. Wide enough to include all your guests and friends, yet private enough to stay intimate. No matter what the occasion is, you are bound to enjoy it better when it is so close to your home, and with your loved ones.

Host a movie marathon without a worry

Now you can do watch whatever you wish to, because 24 hour power back up is standard at Sanvi. Interruptions during a key match or a cozy movie time with your family are a thing of the past now.

Cut short your daily commute

Sowparnika Sanvi project is strategically located in Off – Whitefield Main Road in Ambedkar nagar closer to Hope Farm Signal. Accessible from all the important locations of Bangalore, Also the most convenient place for transportation to major Educational institutions and Hospitals.

Live in an eco-friendly way

With a sewage treatment plant and rain water harvesting option, Sanvi stays true to the principle of causing minimal damage to the nature.



**Experience
the best in class
specifications**

FLOORING

- Vitrified tiles for Living, Dining & Bedrooms.
- Ceramic Tiles for all Toilets, Balconies, Kitchen and Utility Areas.

KITCHEN

- Polished Black Granite counter top.
- Standard size stainless steel sinks with drain board.
- Ceramic Glazed Tiles dado up to 2'0" ht above platform.

WINDOWS

- UPVC - Two track sliding windows with guard bars, plain glass and mesh for living, bedrooms and kitchen.

WALLS

- OBD painting for all interior walls and ceiling.
- Exterior wall surfaces painted with snowcem paint.

DOORS

- Main door frames of Teak Wood, Shutters of teak veneer and melamine polished.
- Inside doors putty finished flush door, Painted with superior quality enamel paint.

ELECTRICAL

- T.V and Telephone points in living room.
- Electrical switches of modular switches.
- One Earth Leakage Circuit Breaker (ELCB) for each flat.
- Earthing with copper wire using loop system.

TOILETS

- Pressure checked plumbing and drainage lines to ensure total leak proof toilets
- JAQUAR basic or equivalent C.P. fittings.
- Good Quality Sanitary Ware.
- Hot and cold Mixed unit with overhead shower
- Provision for Geyser
- Select glazed /ceramic tile dado upto 7' height

Floor plans

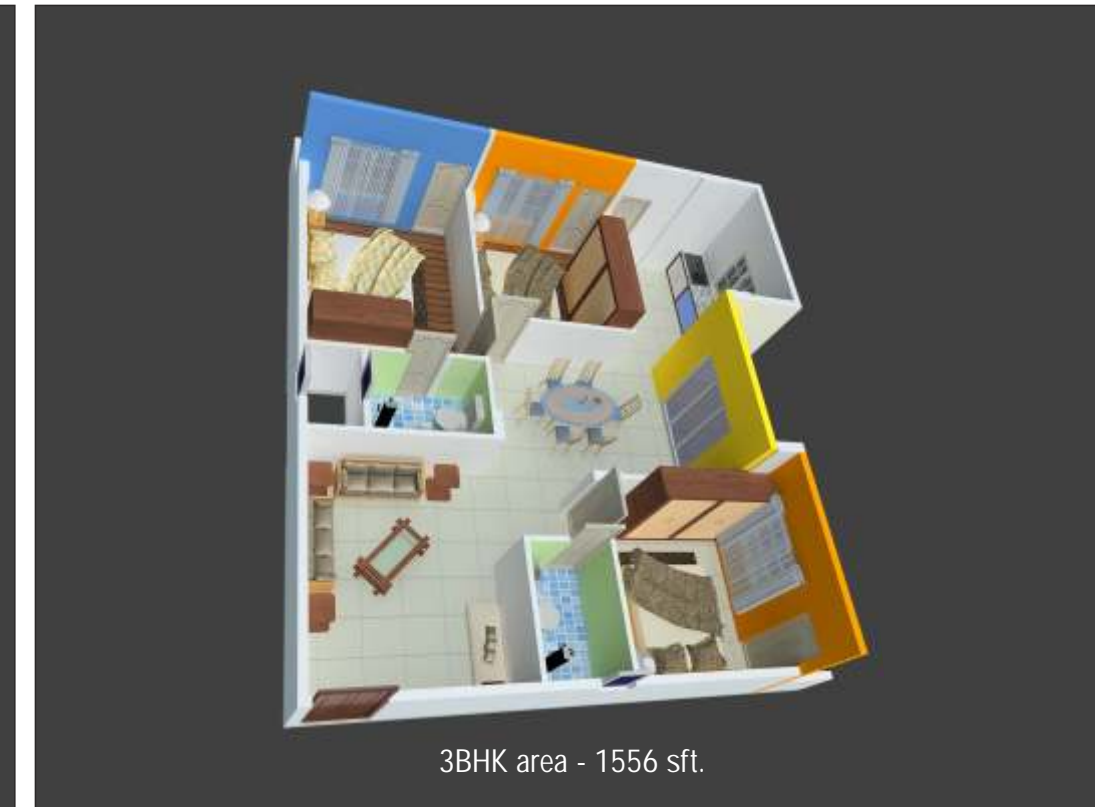

Master plan

