



# *Daffodils*

Hosa road junction

Transforming addresses  
into dream homes



**MSR**

Benchmarks today. Landmarks tomorrow.





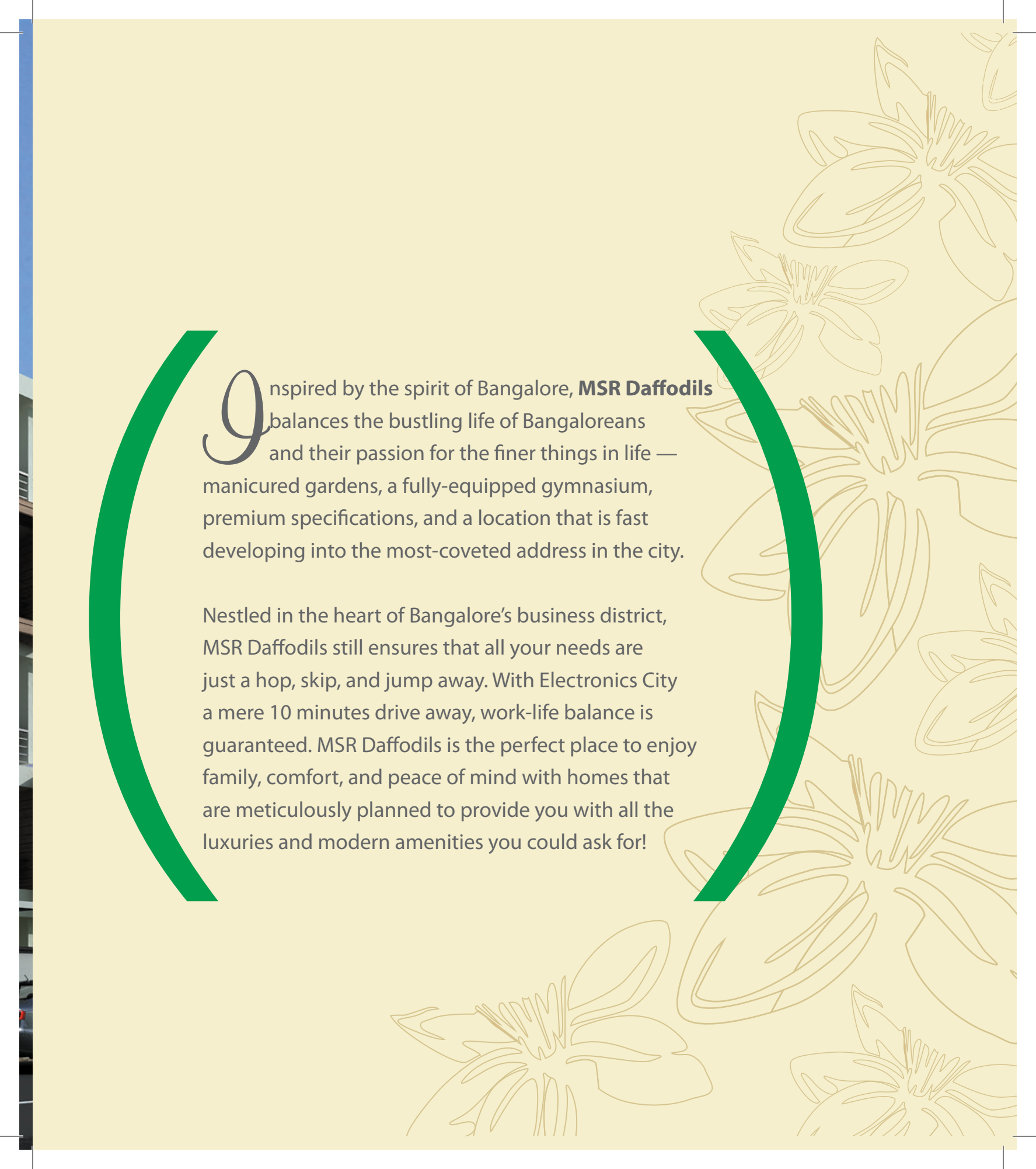

Inspired by the spirit of Bangalore, **MSR Daffodils** balances the bustling life of Bangaloreans and their passion for the finer things in life — manicured gardens, a fully-equipped gymnasium, premium specifications, and a location that is fast developing into the most-coveted address in the city.

Nestled in the heart of Bangalore's business district, MSR Daffodils still ensures that all your needs are just a hop, skip, and jump away. With Electronics City a mere 10 minutes drive away, work-life balance is guaranteed. MSR Daffodils is the perfect place to enjoy family, comfort, and peace of mind with homes that are meticulously planned to provide you with all the luxuries and modern amenities you could ask for!



**Naveen Jayram**

Flat No.Pent-B, MSR Dew Drops

*The buying process was pretty smooth in terms of fulfilling all the formalities, getting the position on time, registration, and even bank-related formalities.*

***Excellent ambience and amenities brings immense joy to everyday living. It is a privilege to be part of MSR Dew Drops.***



## *All at arm's reach*

With every amenity within arm's reach, you won't feel like leaving home. MSR Daffodils enriches your everyday with the best of facilities and amenities:

- A well designed landscape
- Dedicated covered car parking
- Power back-up facility
- Round-the-clock security system
- Intercom for each flat
- 2KV DG back-up for each apartment
- Children's play area
- Vaastu-compliant with good ventilation
- Roof-top gymnasium
- Yoga and aerobic room
- Lifts with adequate capacity



## *Quality living*

MSR Dwellings' key strength is the quality materials it uses to enable quality living. Some of the specifics include:

- RCC framed structure
- High quality plastering
- Premium quality tiles, marble and granite for flooring
- Anti-skid tiles for bathroom
- Plastic emulsion and water-proof paint for walls
- Teak wood main door with antique finish
- 3-track UPVC windows with mosquito mesh
- C.P/ Sanitary Fittings from Johnson/Jaguar/Hindware or equivalent.



# Floor plan

- A mere 10-minute drive away from Electronics City
- Ready For Possession by **December, 2015**
- Approved by BBMP

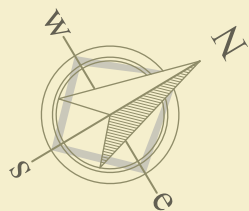



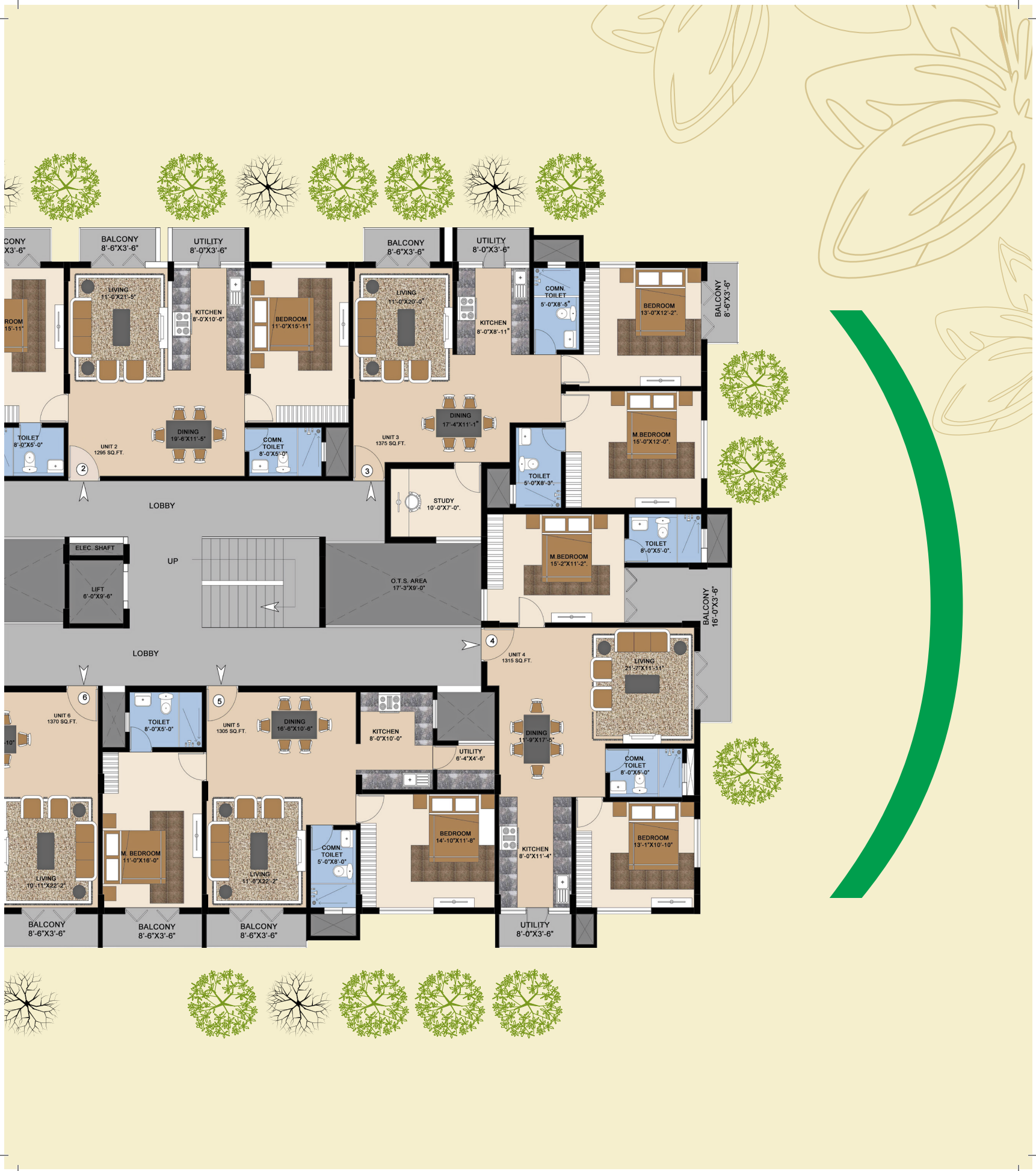

# Flat layouts

## Unit 1

1400sqft  
(2BHK + study)

1. Balcony 8'6"x3'6"
2. Master Bedroom 11'7"x15'11"
3. Bedroom 11'6"x15'11"
4. Toilet 8'1"x5'0"
5. Common Toilet 8'0"x5'0"
6. Living 19'0"x10'11"
7. Dining 9'6"x19'10"
8. Kitchen 9'6"x8'5"
9. Study 8'4"x5'11"
10. Balcony 10'11"x3'6"
11. Utility 8'5"x3'6"

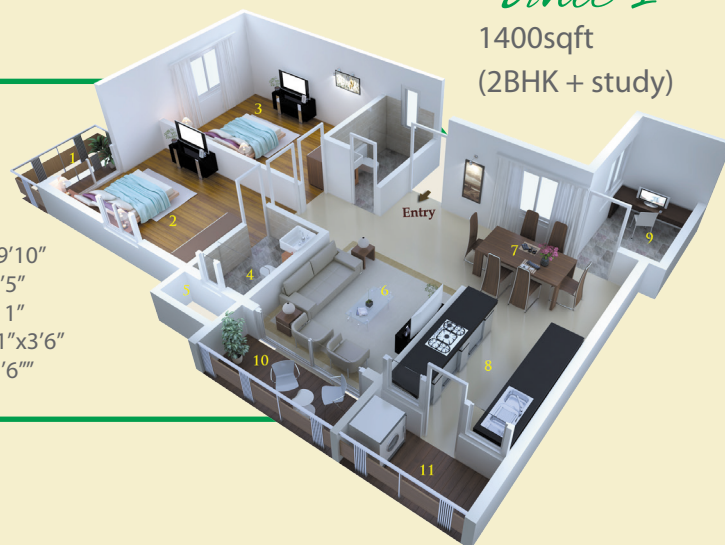

## Unit 2

1295sqft  
(2BHK)

1. Balcony 8'6"x3'6"
2. Master Bedroom 11'2"x15'11"
3. Living 11'0"x21'5"
4. Dining 19'6"x11'5"
5. Kitchen 8'0"x10'6"
6. Toilet 8'0"x5'0"
7. Common Toilet 8'0"x5'0"
8. Bedroom 11'0"x15'11"
9. Balcony 8'6"x3'6"
10. Utility 8'0"x3'6"



1. Dining 17'4"x11'1"
2. Living 11'0"x20'0"
3. Kitchen 8'0"x8'11"
4. Balcony 8'6"x3'6"
5. Utility 8'6"x3'6"
6. Study 10'0"x7'0"
7. Toilet 5'0"x8'3"
8. Common Toilet 5'0"x8'5"
9. Bedroom 13'0"x12'2"
10. Master Bedroom 15'0"x12'0"
11. Balcony 8'6"x3'6"



## Unit 3

1375sqft  
(2BHK + study)



## Unit 4

1315sqft  
(2BHK)



1. Living 21'7"x11'11"
2. Dining 11'9"x17'5"
3. Bedroom 13'1"x10'10"
4. Master Bedroom 15'2"x11'2"
5. Kitchen 8'0"x5'0"
6. Toilet 8'0"x5'0"
7. Balcony 16'6"x3'6"
8. Common Toilet 8'0"x5'0"
9. Utility 8'0"x3'6"

1. Living 11'0"x22'2"
2. Toilet 8'0"x5'8"
3. Dining 16'6"x10'6"
4. Kitchen 8'0"x10'0"
5. Bedroom 14'10"x11'8"
6. Balcony 11'0"x3'6"
7. Balcony 11'0"x3'6"
8. Common Toilet 5'0"x8'0"
9. Utility 6'4"x4'6"
10. Master Bedroom 11'0"x16'0"



## Unit 5

1305sqft  
(2BHK)

## Unit 6

1370sqft  
(2BHK)



1. Master Bedroom 16'0"x14'1"
2. Bedroom 14'5"x11'6"
3. Dining 17'10"x12'10"
4. Living 10'11"x22'2"
5. Kitchen 8'0"x9'4"
6. Common Toilet 5'0"x8'0"
7. Toilet 5'0"x8'9"
8. Balcony 8'6"x3'6"
9. Balcony 10'11"x3'6"
10. Utility 8'0"x3'6"

# Our other projects

## MSR Dew Drops

At MSR Dew Drops, greenery takes on a whole new perspective. Be it the quiet walkways for a retreat, active spaces for recreation, or scenic venues for relaxation, greenery wraps itself around your home — blending the dual roles of beauty and tranquillity. With 45 spacious luxury homes with two magnificent towers, MSR Dew Drops is an exhilarating tribute to the art of fine living.

### Sudhanshu Badola

Flat No. 404, Tower-B, MSR Dew Drops

*I had booked my flat in MSR Dew Drops in June 2013. The promptness and efficiency of the marketing team was impressive. Though society is in the heart of major tech parks, it is very peaceful. Surrounded by greenery, there is good connectivity to schools, malls, and tech parks. **I am very satisfied with the quality of construction, good lighting, and ventilation in the rooms.***



## MSR Lotuss

MSR Lotuss is a hearth for the beautiful and inviting home you can make it. With functionally and aesthetically planned spaces to harbor your own private world of luxury and comfort, the apartments come at an affordable price. Its well-thought-of amenities and conveniences, inside and out, give you everything you wanted and more.





# About MSR

## MSR Dwellings

Triggered by the vision of being the harbinger of change and innovation in the real estate industry, MSR Dwellings was created to improve the quality of living and work spaces in India. The company's transparent, ethical, and value-driven style of working is focused on building long-lasting relationships with clients. Possessing a rare obsession with quality, we are a company that is constantly attempting to perfect the art of perfection - to go the extra mile to offer the most value to our clients and partners.

MSR has dotted Bangalore with several landmark projects.

- 50,000sqft of commercial projects
- Over 30 residential bungalows
- 2 Projects: Dew Drops- 65,000 sq.ft comprising 45 luxury apartments community and Lotuss- 32568 sq.ft comprising of 20 flats community.
- Over 100 super-luxury villas coming up soon at Hoodi, Bangalore

Contrary to popular belief, MSR Dwellings believes affordable luxury is not an oxymoron. Each project, irrespective of its size and nature, is a thoughtful synergy of luxury, quality, comfort, and affordability. Our dedication and merit of good work have given us a reputation of one of the most dependable commercial developers in the city.

MSR Daffodils was created to cater to the ever-growing demand for fine residential developments closer to the workplace. Enjoy the best of both worlds with MSR Dwellings.



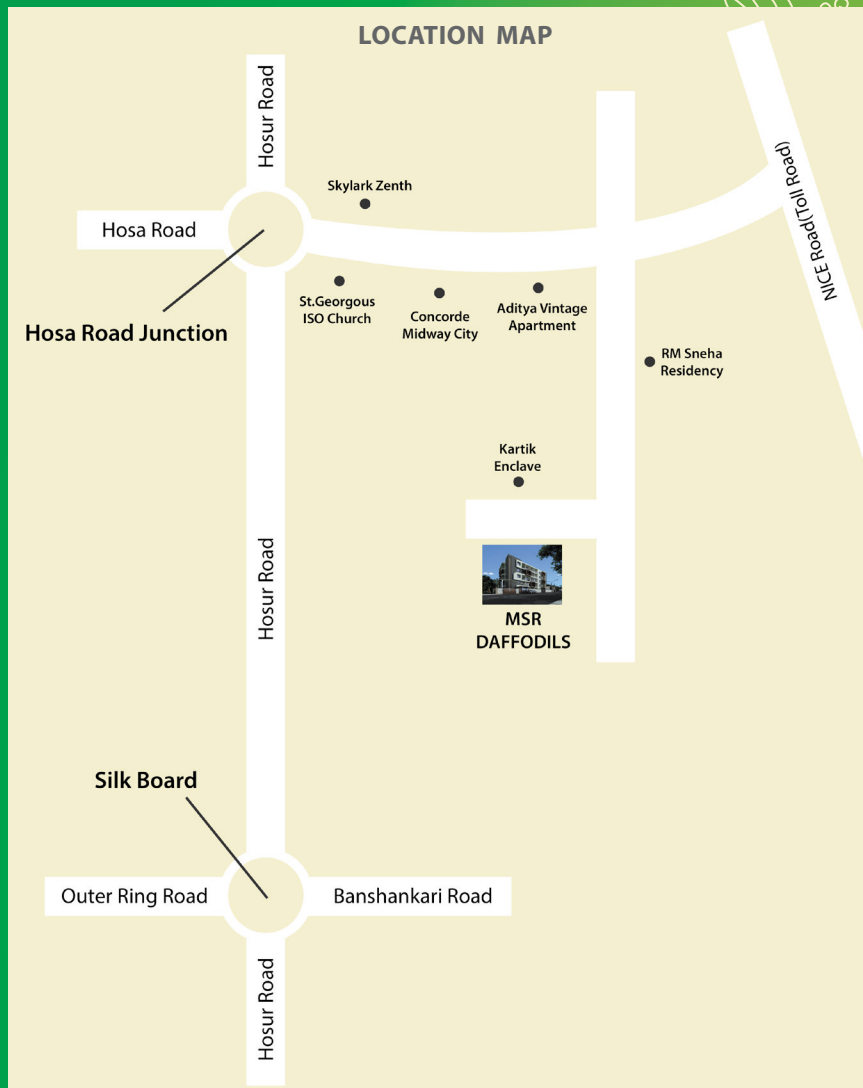

### Ankan Saha

Flat No.401, MSR Lotuss

*Initially, it was the location that was a key attribute in making me decide on this project. Later on, I agreed that **this is money worth spending when compared to other projects of a similar kind.** We like the progress the project is making and are hopeful of its completion on the stated schedule.*



### SITE ADDRESS

#### MSR Daffodils

Survey No. 25/1,  
Basapura Village,  
Begur Hobli,  
Bangalore-560100

### REGISTERED OFFICE

#### MSR Dwellings Pvt. Ltd

# 595 4<sup>th</sup> Floor, 7<sup>th</sup> Main  
(Above State Bank of Travancore)  
Mico Layout, BTM 2<sup>nd</sup> Stage  
Bangalore- 560076

+91 80 26781999

+91 80 26689621

+91 97319 99369

+91 95911 15555

sales@msrdwellings.in

customercare@msrdwellings.in

www.msrdwelling.com