



Experience nature's sublime bliss





Unique

Welcome to 'Sai Krupa's 'Hanging Gardens', an exclusive apartment complex which enjoys the unparalleled advantage of proximity to Electronic City. Strategically located on the mid point of Bangalore City and NICE Ring Road Junction at Electronic city, 'Sai Krupa's 'Hanging Gardens' is spread across four blocks of eight floors each, offering 2 and 3Bhk apartments, with the added benefit of green environs plus a unique feature of individual and private rooftop gardens for the terrace apartments.



Inspired



Unmatched

'Sai Krupa's 'Hanging Gardens' is picturesquely located just a short distance away from Bangalore city and within close proximity to the prestigious Electronic City. This ensures you are close to all the comforts and conveniences of the metro while enjoying the exclusivity of naturally beautiful environs. Schools, Colleges, Hospitals, Shopping Malls, Entertainment Centres, etc., are just 3 kms away.





Panoramic

Distinctive



Elaborate

The layout of 'Sai Krupa's 'Hanging Gardens' provides for ample space between blocks and extensive green areas with around **34%** of covered area- all geared towards keeping the atmosphere pure and healthy and providing residents with a quiet place where they can sit back and relax or take a leisurely stroll. The green areas are aesthetically landscaped with a profusion of plants and water bodies.

Convenience all the way

- Waiting Lobby with Security for each of the four blocks
- Backup generator for common areas and 0.5 KVA for each flat
- Intercom facility from flat to flat and flat to security
- Landscaped open areas
- Rainwater harvesting
- Internet Connectivity
- 24 Hours 3 Tier Security
- Covered Car parking
- Car Wash



Block D



Key Plan

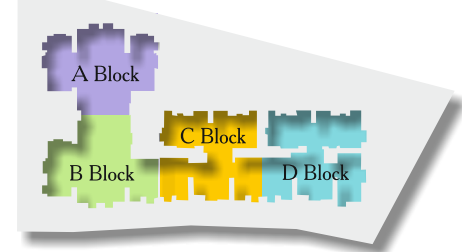

Typical Floor Area Statement
(2nd to 6th floors)

Block A			Block B			Block C			Block D		
Flat No.	Type	Area in Sft.	Flat No.	Type	Area in Sft.	Flat No.	Type	Area in Sft.	Flat No.	Type	Area in Sft.
1	3	1623	6	2	1490	11	2	1350	14	2	1340
2	2	1163	7	3	1616	12	2	1146	15	2	1146
3	2	1160	8	2	1142	13	2	1345	16	3	1420
4	3	1625	9	2	1157	19	3	1653	17	3	1807
5	2	1431	10	2	1343	20	3	1715	18	3	1672

First Floor Area Statement

Block A			Block B			Block C			Block D		
Flat No.	Type	Area in Sft.	Flat No.	Type	Area in Sft.	Flat No.	Type	Area in Sft.	Flat No.	Type	Area in Sft.
1	3	1579	6	2	1490	11	2	1233	14	2	1230
2	2	1104	7	3	1536	12	2	1020	15	2	1146
3	2	1100	8	2	1100	13	2	1235	16	3	1368
4	3	1550	9	2	1111	19	3	1653	17	3	1807
5	2	1432	10	2	1233	20	3	1715	18	3	1672

Block A

Block B

Block C

Block D



Seventh Floor Plan





Key Plan

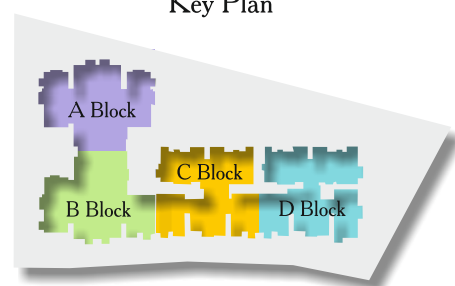

Seventh Floor Area Statement

Block A			Block B			Block C			Block D		
Flat No.	Type	Area in Sft.	Flat No.	Type	Area in Sft.	Flat No.	Type	Area in Sft.	Flat No.	Type	Area in Sft.
1	3	1980	6	3	2070	11	2	1555	14	2	1555
4	3	1980	7	2	1995	13	2	1562	16	3	1625
			10	3	1712	19	3	1653	17	3	1807
						20	3	1715	18	3	1672



Specifications

Structure	: RCC Framed Structure
Super Structure	: Solid block Masonry wall
Doors/Shutters/Hardware	: (i) Main Door : Teak wood door frames with BST or moulded panel doors shutters & Brass hardware (ii) Bedroom/kitchen: Wooden door frames with OST shutters & powder coated hardware (iii) Toilet door: Wooden doorframes with Commercial flush door shutter & powder Coated hardware
Windows	: Powder coated Aluminum windows with MS grills
Flooring	: (i) Living / Dining : Vitrified Tiles (ii) Bedrooms : Vitrified tiles (iii) Toilets : Ceramic tiles with Dodo up to 7 ft (iv) Kitchen : Vitrified tiles
Kitchen	: 20 MM Black granite platform with half round finish stainless steel sink and tiles dado of 2 ft ht
Painting	: (i) Emulsion for inside walls (ii) Apex paint for exterior walls (iii) Enamel paints/polish for doors and windows. (iv) Metal paint for grills
Electrical	: ISI make Finolex copper wiring with Roma or Finolex switches. Genset back up power of 0.5 KVA for flats and common area Lighting, pump and lift
Plumbing & Sanitary	: (i) Porcelain EWC / IWC and wash basin of Parryware or Hindustan make, in pastel colors (ii) Chromium plated fittings of Jaquar or equivalent make (iii) Plumbing materials of ISI make
Lift	: 6-Passenger lift for each building
Water	: Bore well water
Other Amenities	: Swimming pool / Club House /Carwash Center / garden-lawn / landscaping / Water supply facility / security / Sewerage treatment Plant



Sai Krupa Ventures
(A UNIT OF **Sai Soudha Shelters Pvt. Ltd.**)



Trendsetters

Sai Krupa Ventures is committed to bringing you a unique combination of the newest innovations in home building merged with the finest traditions of quality construction. Headed by experienced professionals with a vision to transcend the ordinary, **Sai Krupa Ventures** aims to incorporate green values and environmentally friendly features into their building plans.

Past Ventures



SKV's Wilmott



SKV's Sai Rukimini



SKV's Royal Pavilion



SKV's Sulochana Sadan



SKV's Park View



SKV's Spandana



SKV's Adams Arcade



Kokala Residency