

GREEN
IS NOT
JUST A
COLOUR

IT'S AN
EXPERIENCE

ORCHID
GREENS

2 & 3 bhk lifestyle apartments

ORCHID
GREENS

AN EXPERIENCE OF LIVING A SMOOTHER, HEALTHIER & HAPPIER LIFE



EXPERIENCE THE GRANDEUR



GROUND FLOOR PLAN

LEGEND FOR AMENITIES

- 1. GUARD HOUSE
- 2. ADEQUATE PARKING
- 3. 2 STOREY CLUB HOUSE
- 4. INDOOR SPORTS
- 5. CHANGE ROOM
- 6. CELEBRATION GARDEN
- 7. POOL
- 8. WAY TO PHASE II DEVELOPMENT



FIRST FLOOR PLAN

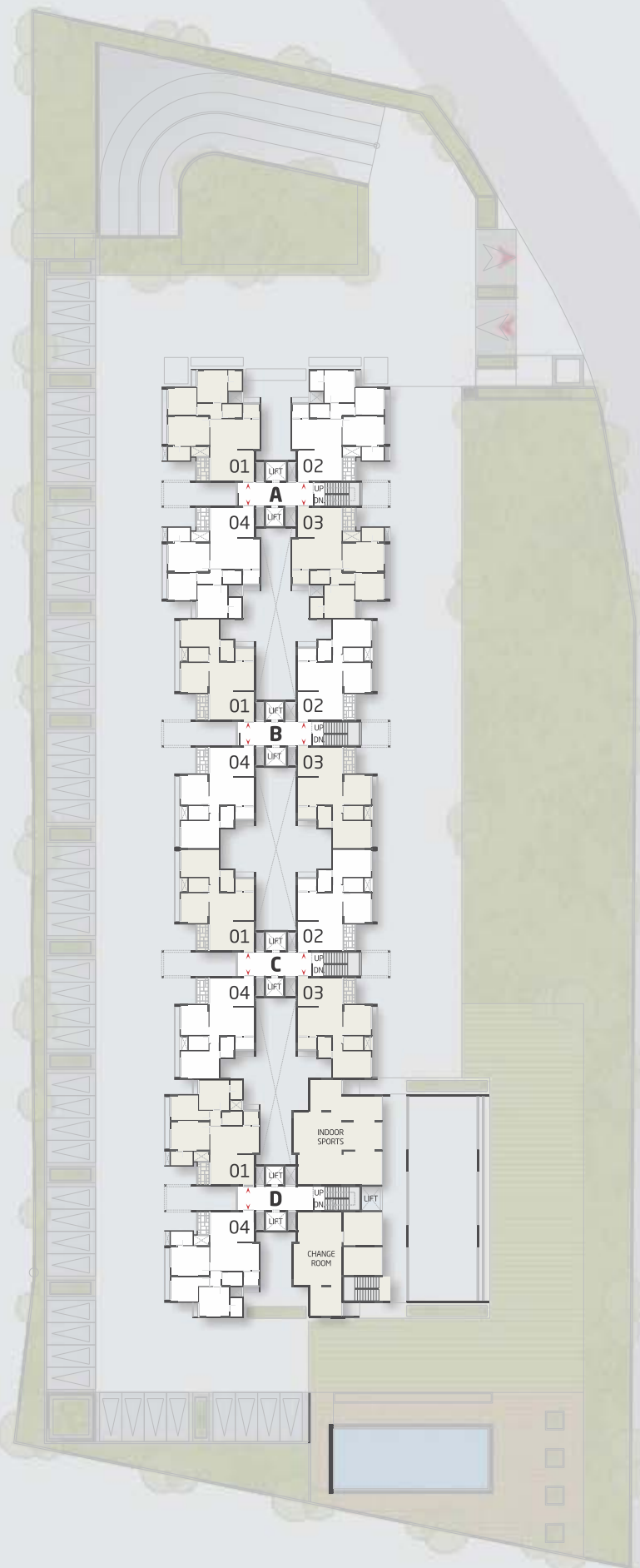



ORCHID
GREENS

Orchid Greens is meticulously planned including all the comforts, luxuries and privileges you could ask for. A club house that pampers you in style, a lavish swimming pool, a world class gym and yoga center. All in the serene environs and comfort of your own privileged world.

CLUBHOUSE AMENITIES

- SWIMMING POOL
- INDOOR GAMES
- STEAM ROOM
- MULTIPURPOSE HALL
- FITNESS CENTRE
- YOGA CENTER

3bhk
1450 SQ.FT. (S.B.UP)

BLOCK : D-01, 02, 03 & 04

NO	SPACES	AREA
1	DRAWING ROOM	11'0" X 16'0"
1A	VARANDAH	8'2" X 4'0"
2	DINING ROOM	10'6" X 10'0"
2A	POWDER ROOM	5'0" X 7'5"
3	KITCHEN	10'2" X 8'0"
3A	KITCHEN YARD	5'2" X 5'10"
4	BEDROOM-1	11'0" X 14'2"
4A	TOILET	5'0" X 8'0"
5	BEDROOM-2	9'0" X 10'0"
6	BEDROOM-3	11'0" X 11'0"
6A	TOILET	7'0" X 4'6"

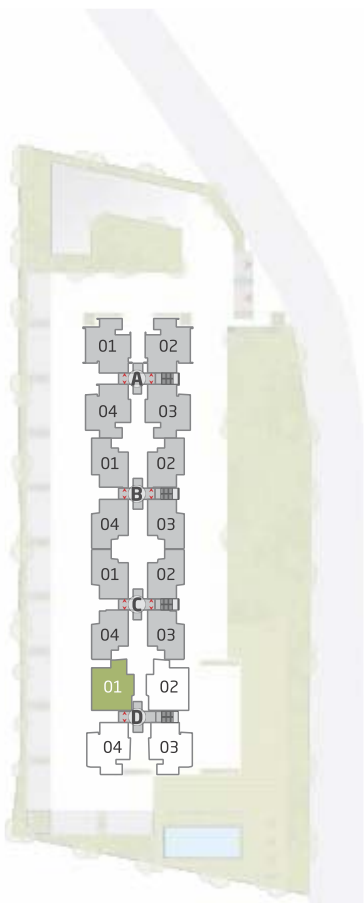

3bhk
1561 SQ.FT. (S.B.UP)

BLOCK : A-01, 02, 03 & 04

NO	SPACES	AREA
1	DRAWING ROOM	11'0" X 16'0"
1A	VARANDAH	8'4" X 4'6"
2	DINING ROOM	11'6" X 10'0"
2A	POWDER ROOM	5'0" X 7'2"
3	KITCHEN	11'2" X 8'1"
3A	KITCHEN YARD	5'2" X 6'0"
4	M.BEDROOM-1	12'0" X 11'0"
4A	TOILET	7'6" X 5'0"
5	M.BEDROOM-2	10'0" X 10'5"
6	M.BEDROOM-3	11'0" X 15'1"
6A	TOILET	5'0" X 8'0"

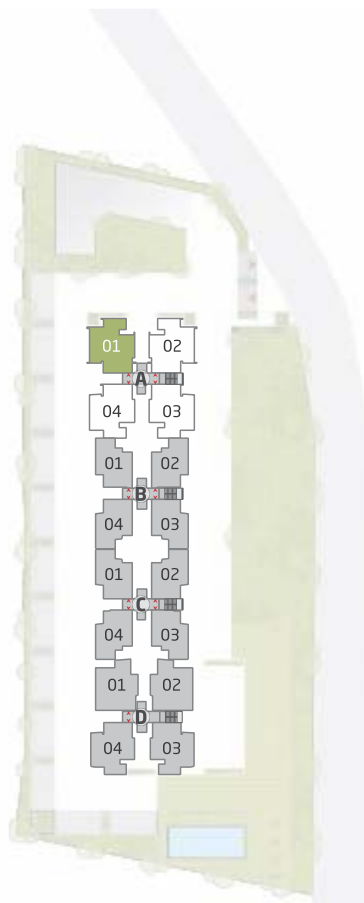



EXPERIENCE THE LUXURY

ORCHID
GREENS

2bhk

1180 SQ.FT. (S.B.UP)

BLOCK : **B**-01, 02, 03 & 04
 BLOCK : **C**-01, 02, 03 & 04

NO	SPACES	AREA
1	DRAWING ROOM	10'6" X 16'3"
1A	VARANDAH	9'6" X 4'0"
2	DINING ROOM	10'6" X 8'9"
2A	POWDER ROOM	5'0" X 7'3"
3	KITCHEN	10'7" X 7'6"
3A	KITCHEN YARD	4'7" X 6'9"
4	BEDROOM-1	10'0" X 14'0"
4A	TOILET	5'2" X 8'0"
5	BEDROOM-2	11'0" X 10'2"

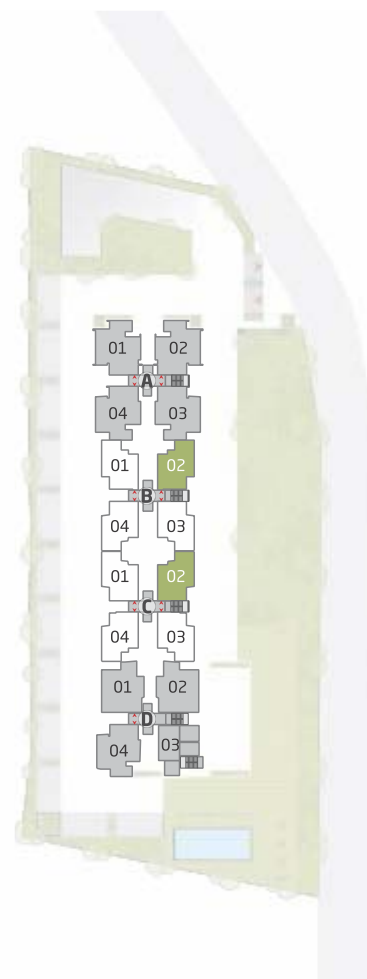

AN
EXPERIENCE
WORTH LIVING !

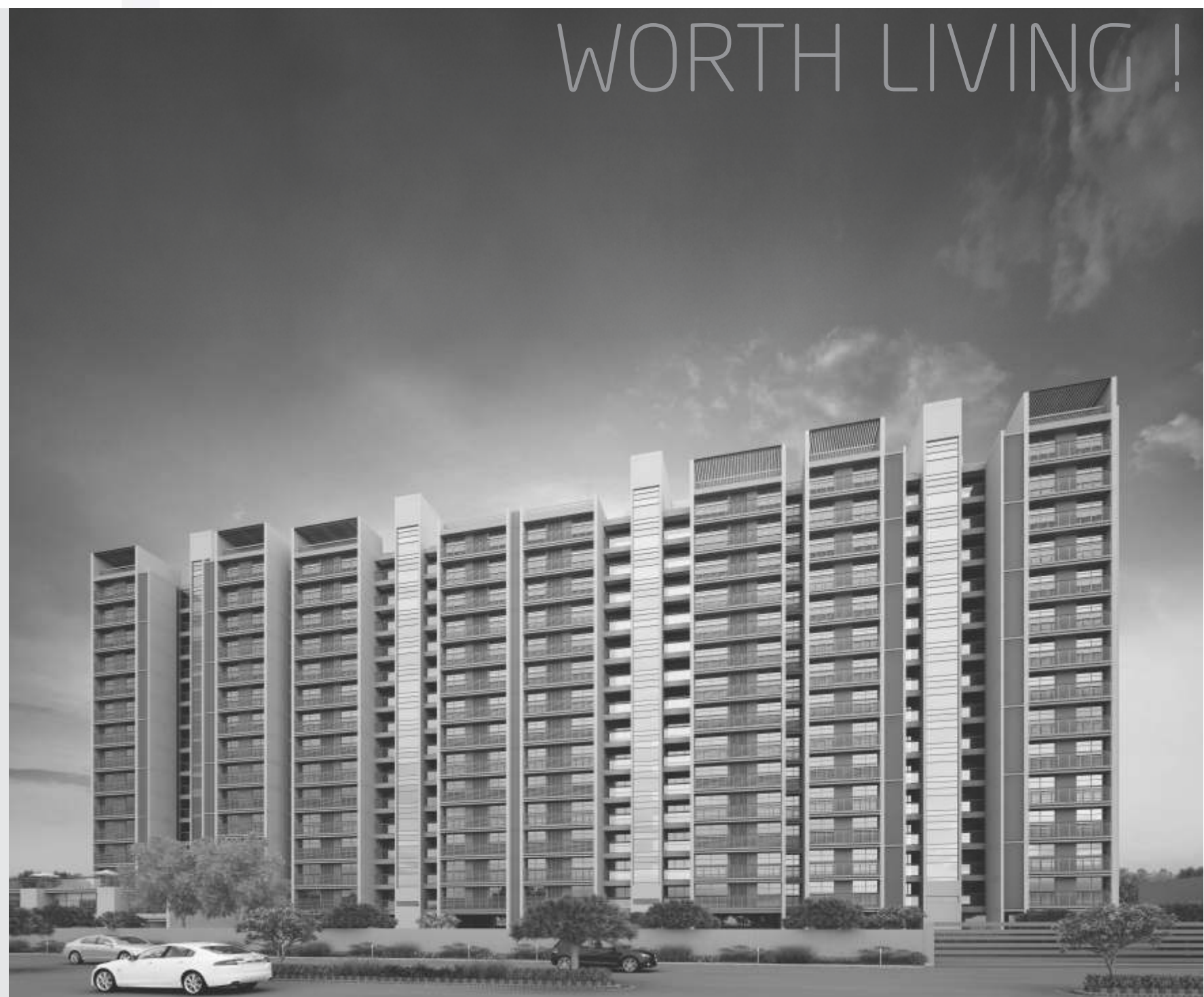

SPECIFICATIONS

WALL FINISHING

- Internal Walls and Ceiling finished with Oil Bound Distemper
- External Walls painted with weather coat /weather shield paints

FLOORING

- Vitrified Tiles for complete flat
- Ceramic tiles for balconies and utility areas
- Lobbies with rustic/ vitrified tiles
- Staircases with Polished kota stone / granite

DOORS & WINDOWS

- Main doors with teak wood frames and teak finish flush doors
- Other doors with sal wood frames with moulded panel doors
- Powder coated aluminium / UPVC windows

KITCHEN

- Granite counter with single drain board sink
- Cladding with ceramic tiles 2' above the kitchen platform

TOILETS

- Ceramic Tiles dado upto 7' height
- Grid False Ceiling
- Counter Basin / Wall hung basin
- C P fittings of Jaquar or equivalent
- EWC and Ceramic basins of Cera or equivalent in all toilets

ELECTRICAL

- 2 BHK : 4 Kw KPTCL supply & .75 Kw DG back up
- 3 BHK : 5 Kw KPTCL supply & 1 Kw DG back up
- 100% DG back up for pumps, lifts and common area

WATER SUPPLY

- CPVC line for water supply
- UPVC / PVC lines for soil, drainage and external lines
- Sewage Treatment Plant
- Rain water harvesting system

LIFTS

- One - 8 Passenger Lift & Second - 15 Passenger Lift

SPECIAL NOTES :

- The developers reserve the rights to change or revise or make any modifications, additions, omissions or alterations in the scheme as a whole or any part there of or any details there in, at their sole discretion without any prior notice. Such changes would be binding to all the members.
- All the architectural and interior views in brochure are computer graphic simulated interpretation of the actual property.
- All the dimensions given are approximate & from unfinished surfaces.
- This brochure is just for an easy presentation of the project and should not be treated as a legal document.
- Additional details as per attached leaflet here with.

ARCHITECT
APURVA AMIN ARCHITECTS

STRUCTURAL CONSULTANT
DUCON

ORCHID
GREENS

KEY MAP





**Goyal
& Co.**



**HARIYANA
GROUP**

creating landmarks since 1971

BANGALORE . AHMEDABAD . MUMBAI

PROJECT PARTNER



VALUE AND ASSETS
Holdings Private Limited

📍 206, Barton Centre, MG Road, Bangalore 560001

☎ **+91 80888 33000, +91 80888 66000**

✉ orchidgreens@goyalco.com

www.goyalco.com