



**SITE ADDRESS:**

SKYWATER

Gat No. 60, Baudhi Road, Wagholi, Pune.

Call: +91 - 88884 33336 / 88884 33337 / 88886 60022

Website: [www.ravinandalandmarks.com](http://www.ravinandalandmarks.com) | E-mail: [sales@ravinandalandmarks.com](mailto:sales@ravinandalandmarks.com)

**HEAD OFFICE:**

RAVINANDA LANDMARKS

37, Times Square, Pune - Satara Road, Pune.

NOTE : This Brochure is purely conceptual and is designed in good faith to give you a fair and overall view of the project and is not a legal offering, nor will it be part of any agreement. Photographs are not necessarily comprehensive or current. Nothing contained in this brochure will take precedence in the final agreement. Number of buildings, areas, flats/suits, amenities, specifications, floors, roads, open space etc. may be revised. Promoters reserve the right to amend layouts, plans, elevations, designs, specifications, amenities, areas etc. without notice. The use of clubhouse shall be strictly in accordance with the rules and regulations. "Future Development" may consist of highrise buildings.



The water legacy



A woman with long brown hair, wearing a teal strapless dress with a black belt and large yellow flower earrings, sits on a wooden pier. Her right leg is extended into the water. A pair of purple shoes sits on the pier next to her. The pier is made of light-colored wooden planks and extends from the bottom left towards the center. The water is a deep, calm green, reflecting the surrounding environment. In the background, there are dark, silhouetted trees and foliage along the far bank.

# A place that showcases your being

Nestled amidst scenic beauty, our project stands as a true reflection of a comfort zone that blends harmoniously with fast paced lifestyles.

At Skywater, we retain the trees and greenery within the landscape thus bringing you one step closer to nature. A well-designed scheme, along with a classic location and complete planning with all elegant facilities makes it stand a class apart.





## Showcasing the finest side of your lifestyle

We strive to create a space that is variably different from the normal residential features with a better ambience and favorable atmosphere, whilst imbibing a vibrant and creative environment.

Live and capture moments in 21st century personalized homes, Skywater is your space that we have created keeping in mind your ambitions, luxuries, necessities and above all moments that make your life.

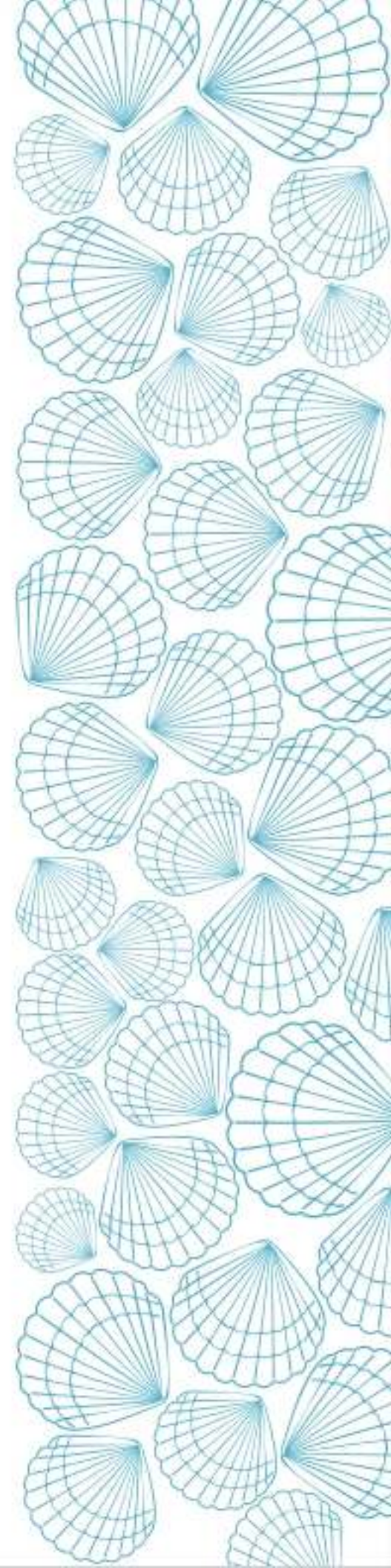



# Relax. Rejuvenate. Relive.

Fresh outdoor space designed to be your zone one can take long walks or indulge into an evening conversation at this precinct.

A multipurpose play and the seating area for all, for leisure and newer ideas of playoffs, alongside the children's play area, a well landscaped garden and walking pathways cater to your health and fitness.

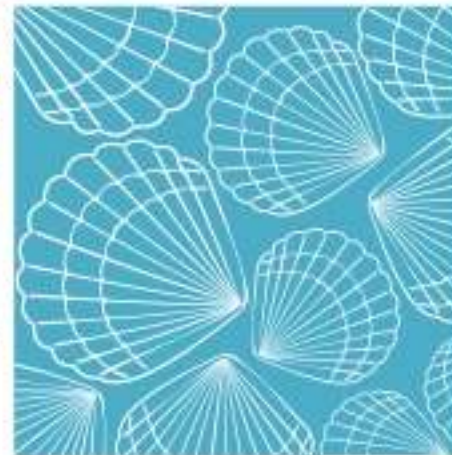



## 1½ BHK Apartments



A: Living    C: Kitchen    E: Terrace    G: Master Toilet    I: Common Toilet  
 B: Dining    D: Dry Balcony    F: Master Bedroom    H: Kids Bedroom

## 2 BHK Apartments

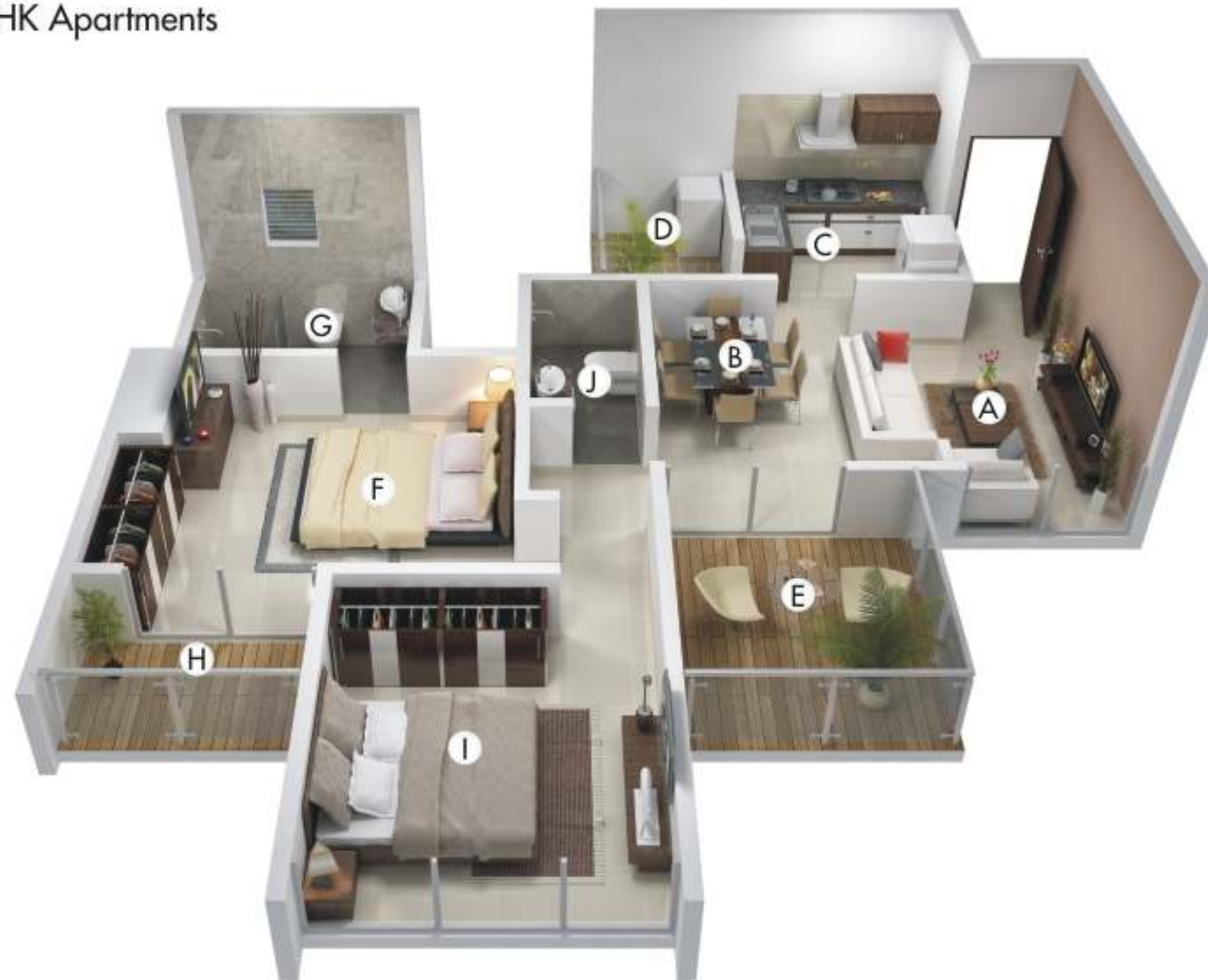

A: Living    C: Kitchen    E: Terrace    G: Master Toilet    I: Guest Bedroom  
 B: Dining    D: Dry Balcony    F: Master Bedroom    H: Terrace    J: Common Bathroom



# Breathe into the freshness of the environment.

Skywater highlights the serene and calm side of Pune where you enjoy sunrise over the lush green surroundings, the cool evenings and take in the peacefulness of the night. Enjoy a hot cup of coffee in the cool evenings amidst the calm surrounding and enjoy the paradise of spending time with yourself and the nature and experience calmness it brings to you, preparing you for tomorrow.







SKY/WATER  
WATER FRONT HOMES



# Where Nature is your next door neighbour!

A fine cultured neighbourhood, amidst green surroundings and upcoming localities, your home suits your modern day living. Modern design and structure that blends beautifully, striking a perfect balance of nature all at the same time.

Enter into a world of your own at Skywater, premium and personalized apartments with every amenity to suit your economic lifestyles, is your new age home.

## Amenities



- Jogging track
- Children's play area
- Garden area
- Gymnasium
- Carrom
- Chess
- Table tennis
- Fully automatic lifts

- Interconnected intercom system
- Planning as per "Vastu Shastra"
- Entrance with passenger drop-off & waiting area
- Seismic resistant design
- Concrete / Paved internal roads
- Demarcated parking for visitors
- Car washing area

- 100% power back-up for common areas
- L.P.G reticulated pipe system
- Fire fighting system
- Rain water harvesting
- Sanitation facility for drivers and servants







## Architecture that sets you apart

We strive to create a space that is variably different from the normal residential features with a better ambience and favourable atmosphere, whilst imbibing a vibrant and creative environment. Live and capture moments in 21st century homes.

Amidst nature equipped with all modern amenities, Skywater has all the facilities to give you a comfortable living. A perfect place for a relaxed evening with your family without having to drive miles; now rejuvenate at your doorstep while kids enjoy at the car free zone near the Children's Park.





## Specifications

### Structure & Masonry

- Earthquake resistant R.C.C. frame structure.
- Sand faced plaster for external walls.
- Gypsum/POP finish or comparative.

### Electrical Fittings

- Adequate electrical points.
- A/C points in master bedroom & living.
- Concealed flame retained copper wiring.
- Miniature circuit breakers.
- Good quality branded modular switches.
- T.V. & Telephone points in living as well as master bedroom.
- Provision of electrical point for Inverter backup.

### Kitchen

- Water filter and exhaust fan in kitchen.
- Granite kitchen platform with stainless steel sink.
- Glazed tile dado up to lintel.
- Concealed plumbing with hot and cold water.
- Provision for electrical and plumbing point for washing machine in dry balcony.

### Lift

- Standard make elevator with generator backup.

### Flooring

- 800 x 800 vitrified tiles in living.
- 600 x 600 for kitchen & bedrooms.
- Rustic flooring in attached terraces, dry balcony & toilets.

### Door

- Attractive main entrance door with good quality fittings.
- Laminated doors for bedrooms.
- Laminated Flush doors for bathrooms.

### Windows

- Powder-coated aluminum sliding windows.
- Oil painted M.S. safety grills.
- Granite sill for all windows.
- Mosquito net for bedroom and living windows.
- Glass railing for terraces.

### Bathroom

- Cera or equivalent good quality branded sanitary ware.
- Exhaust fan in bathrooms.
- Wall and basin mixer.
- Wall-hung commode.
- Jaguar or Equivalent CP fittings.

### Painting

- External paint - Acrylic.
- Internal paint - Emulsion.



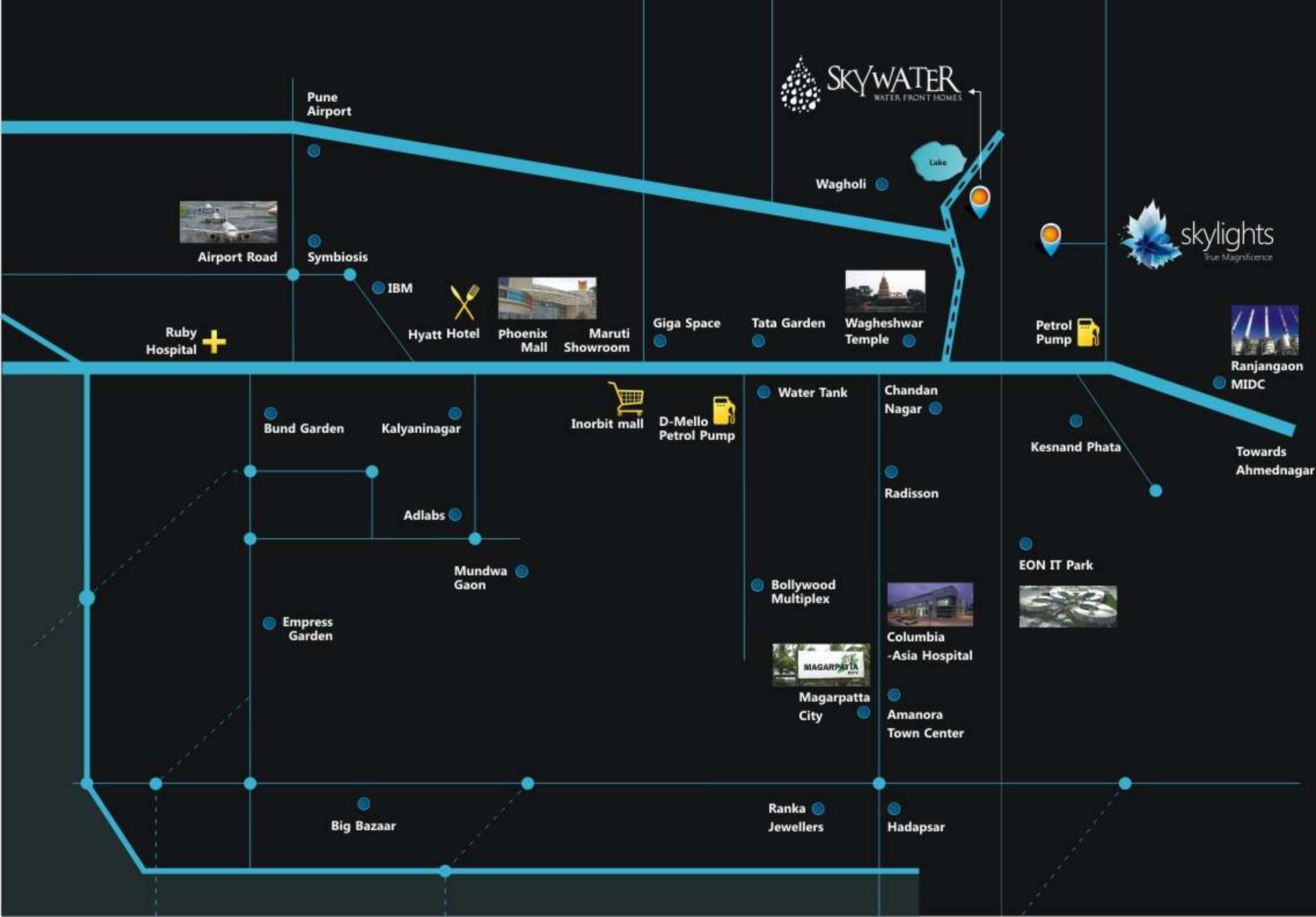

Architect  
Cubix Architect

R.C.C. Consultant  
Structural Vizion

Landscaped Designer  
Mahesh Chinchalkar & Associates

Legal Advisor  
F.M. Oswal

Pune Station	18 Mins.
Pune Airport	10 Mins.
Kharadi IT Park	10 Mins.
Columbia-Asia Hospital	11 Mins.
Kalyani Nagar	13 Mins.
Koregaon Park	14 Mins.
Magarpatta City	15 Mins.
Ranjangaon MIDC	30 Mins.
Hotel Hyatt	9 Mins.
Hotel Radisson	12 Mins.
Inorbit Mall	8 Mins.
Phoenix Mall	9 Mins.