



GM GROUP
always with you...



Turn
your
Dreams
into
Real



Meena
Paradise

Kaikhali, Gopalpur - House



About Us

Over twenty five years ago a few enterprising men kindled the fire of progress and made excellence their commitment and growth their goal. Accomplishing this noble objective called for Indefatigable determination, fine tuned policies, dedicated manpower and world class technology to shape the future.

Real Estate Development

The principal activity of the GM Group is development of residential and commercial buildings.

The Group is well known and recognized by the style and name of GM Group and has been at the helm of the real estate industry for over two decades. Projects span the major Metros and outskirts . The combined real estate value of the projects developed would run Into several thousands rupees, a substantial sum by any national or international standard.

Some of the major landmarks stand proud testimony to the development activities of the Group - Meena Residency, Meena Ganga, Meena Florence, Meena Green are just a few of them Prestigious completed residential projects In Kolkata are Madhu Apartments, Meena View, Meena Vatika and many more.

Ethically GM Group associates only reputed vendors who have proven track record. As a result buyers need not fear any compromisation on the quality of construction when they buy property from us.

GM Group having a exceptional database & professional contacts assure a choice of properties to fit in the budget, in Kolkata & suburbs.



Location Map

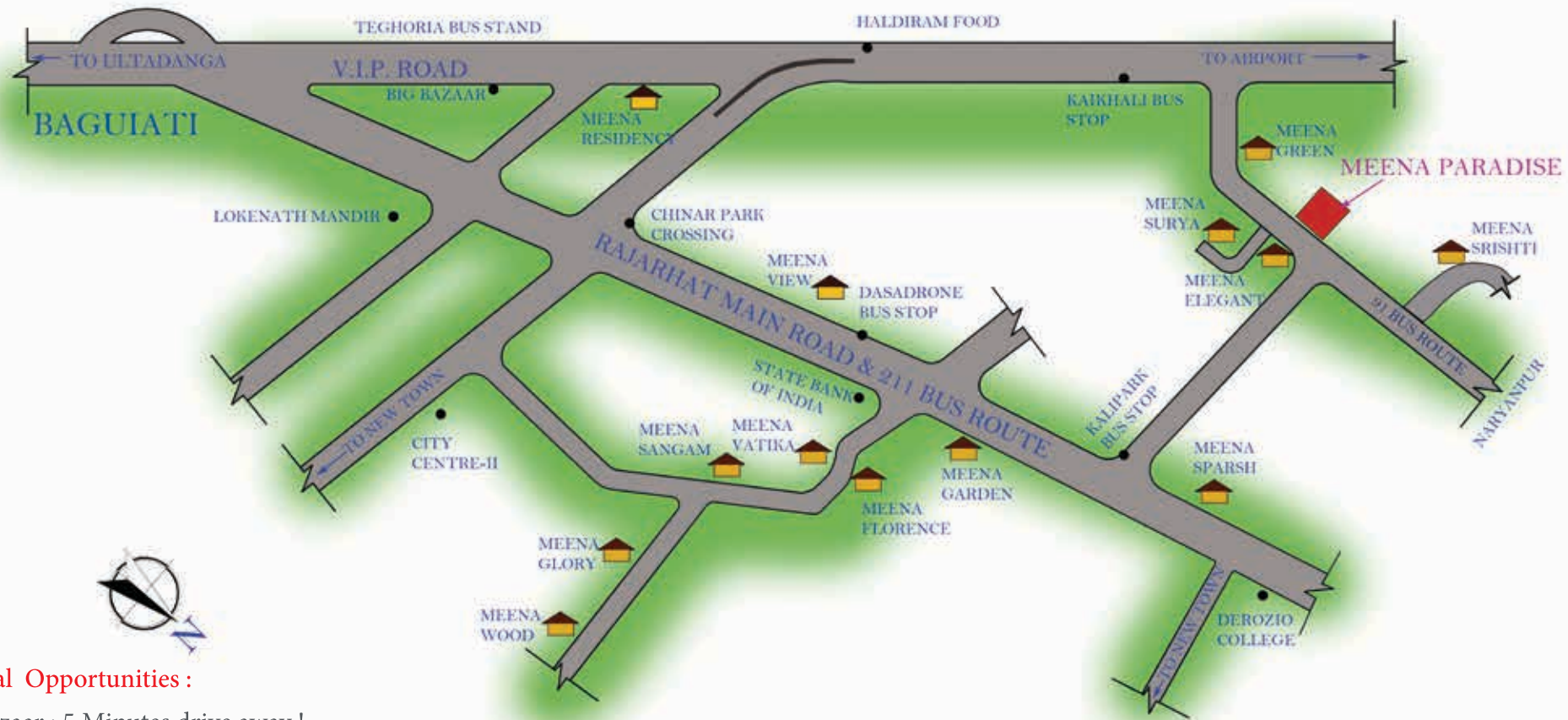

Locational Opportunities :

- 📍 Big Bazaar : 5 Minutes drive away !
- 📍 Haldiram Food : 5 Minutes drive away !
- 📍 Ultadanga : 15 Minutes drive away !
- 📍 New Town City Centre-II : 2 Minutes drive away !
- 📍 Airport : 10 Minutes drive away !

Master Plan

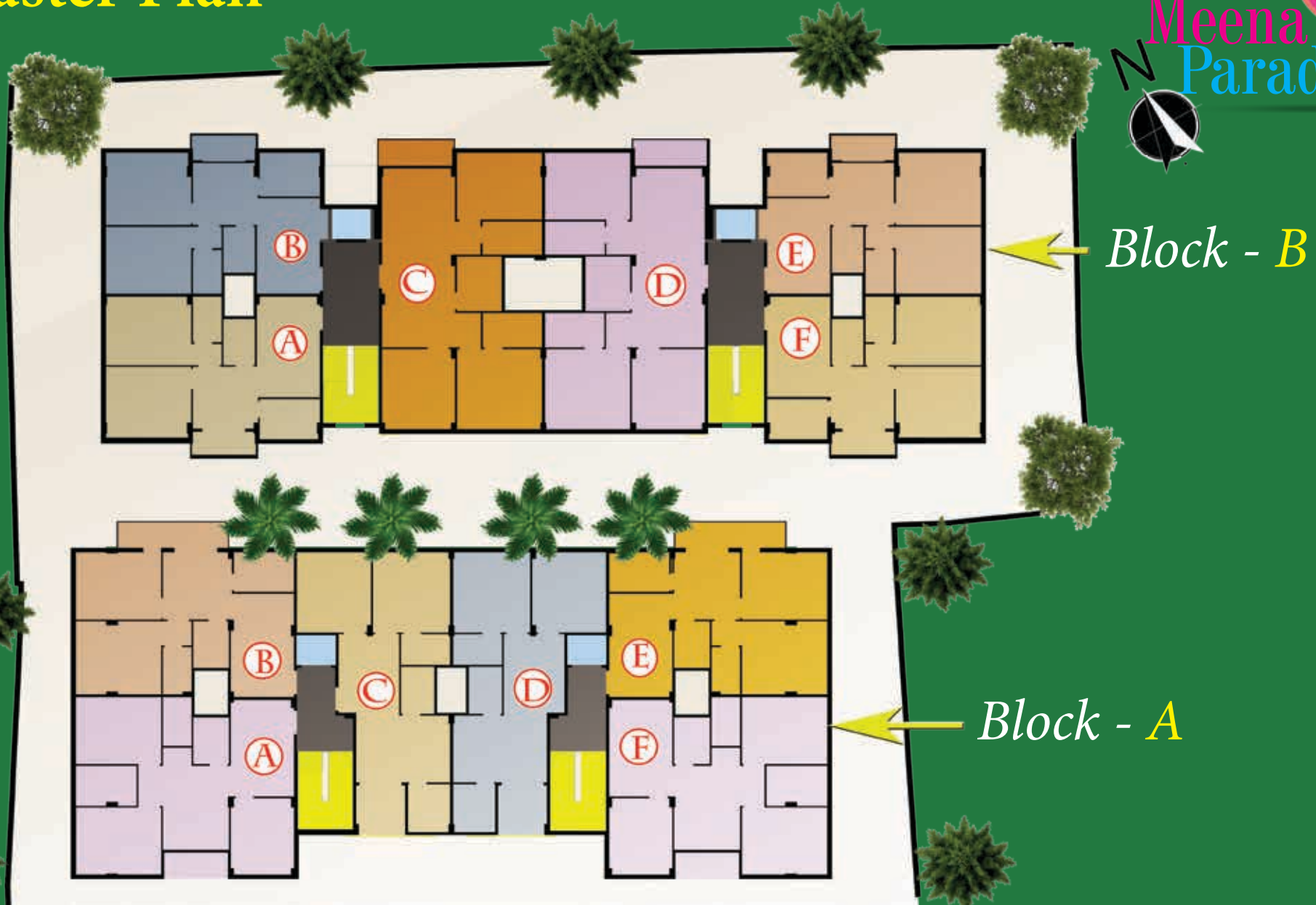

91 BUS ROUTE (MAIN ROAD)

3D VIEW OF
INTERIOR



Meena
Paradise





Meena Paradise



Block - A

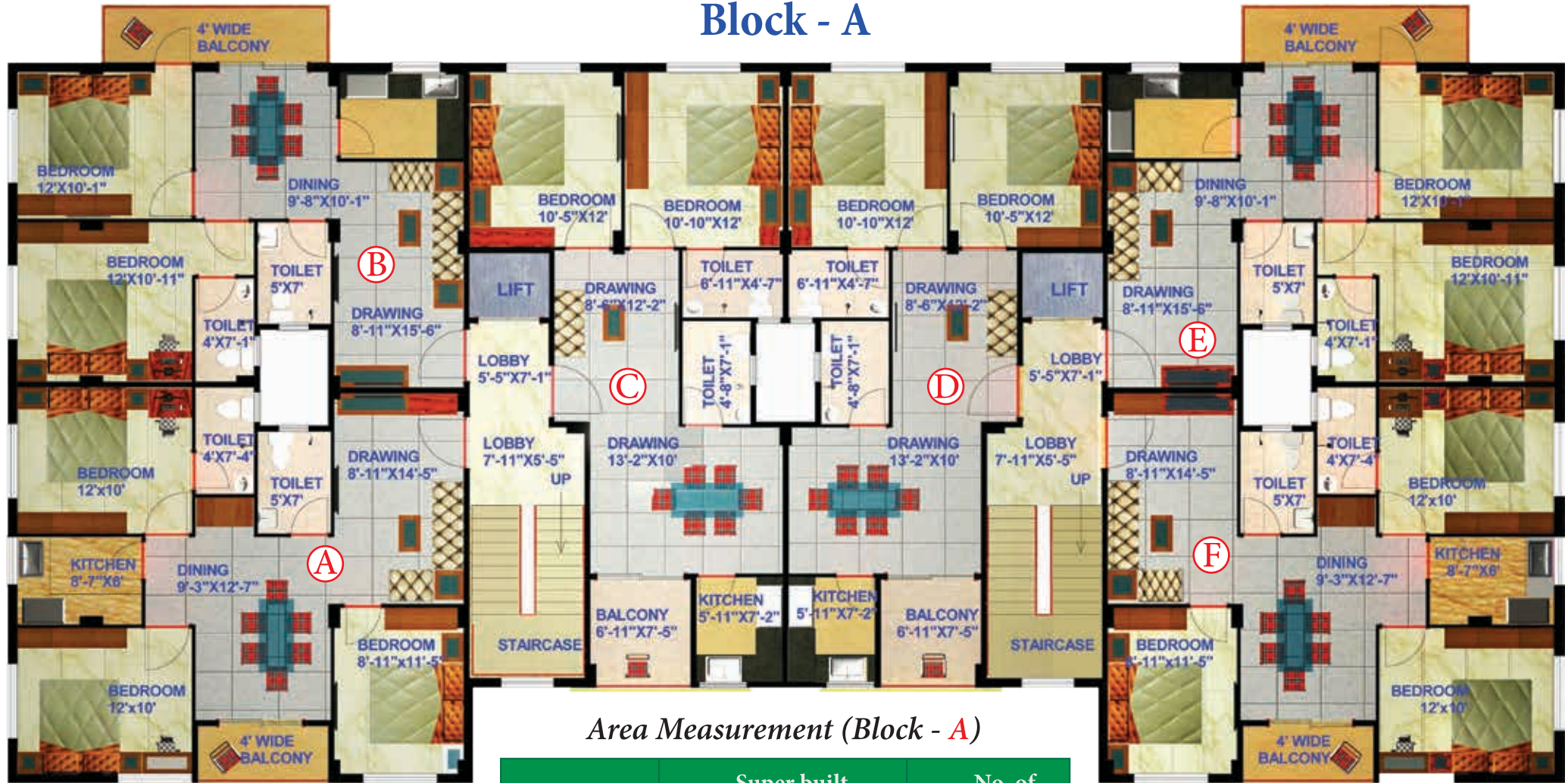

Area Measurement (Block - A)

Type of flat	Super built up area (sqft)	No. of rooms
A	1160	3 BHK
B	1020	2 BHK
C	966	2 BHK
D	966	2 BHK
E	1020	2 BHK
F	1160	3 BHK

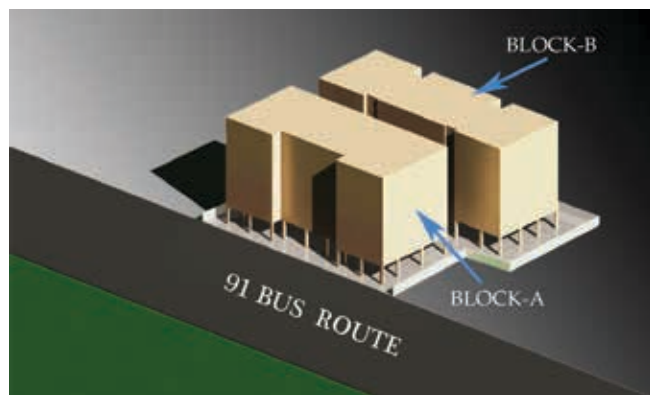

Block - B

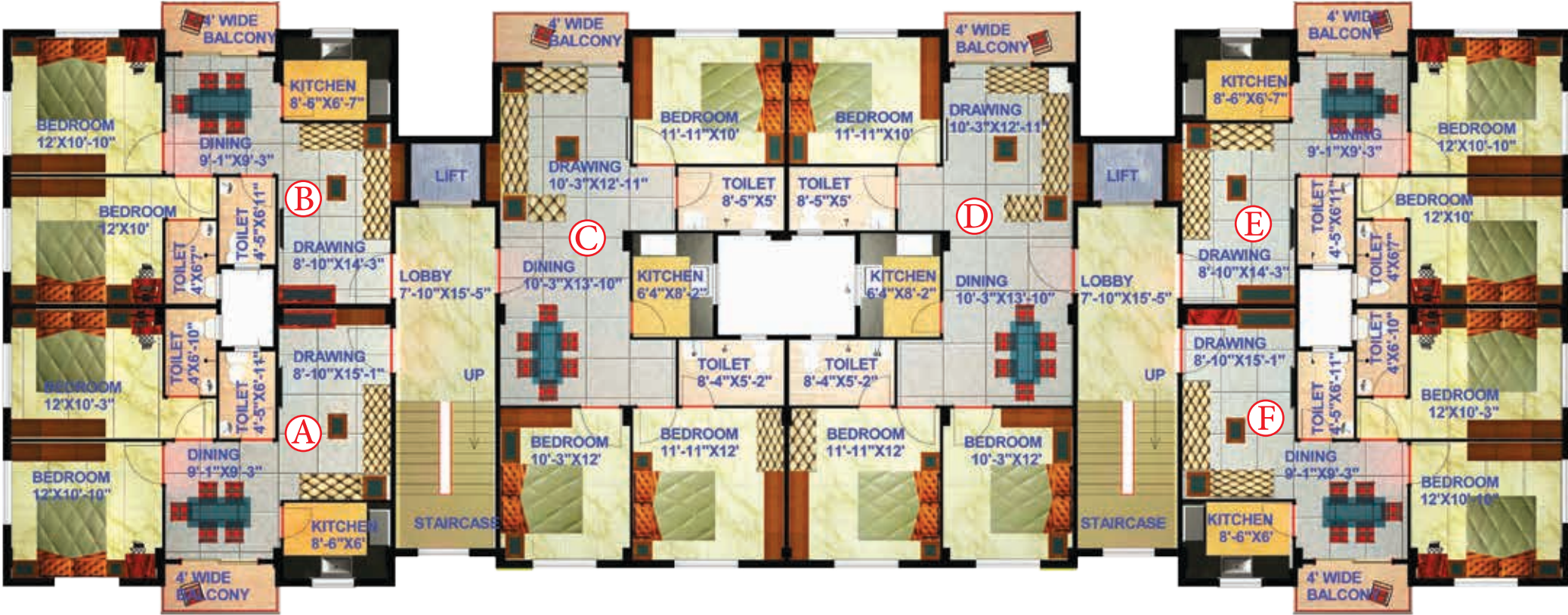

Area Measurement (Block - B)

Type of flat	Super built up area (sqft)	No. of rooms
A	965	2 BHK
B	970	2 BHK
C	1331	3 BHK
D	1331	3 BHK
E	970	2 BHK
F	965	2 BHK

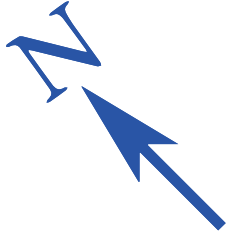
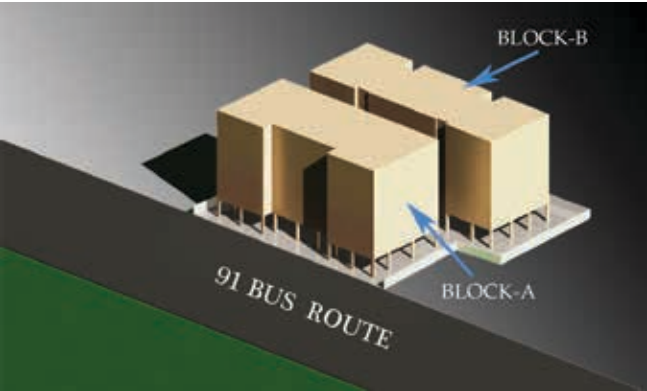

Building Specification

Structure

RCC Frame Structure

Elevation

A Unique blend of ornamental & modern Architecture

Exterior

Blending of Weather-proof paint & other decorative finish

Flooring

Quality Vitrified 2ft x 2ft flooring in living, dining, kitchen & all the bedrooms

Electricals

- 🔦 Copper wiring of good make in concealed conduits
- 🔦 MCB of Havells or equivalent
- 🔦 Telephone ,TV Cable point in living / dining
- 🔦 Geysers point in both toilet
- 🔦 Sufficient light & fan points
- 🔦 Modular switches of good make

Lift

Lift of reputed make in each block

Water Supply

24 hrs uninterrupted supply from deep boring

Staircase & Lobby

Spacious staircase, elegant lobby and all floor corridors with marble

Kitchen

Black Granite top platform with stainless steel sink of reputed make & glazed tiles upto 3ft above the platform

Toilet

- 🔦 Anti skid tiles of good make in all the toilets
- 🔦 Ceramic tiles of good make upto 60 inches
- 🔦 Provision for hot & cold water supply in both toilets
- 🔦 European style sanitary fittings of good make
- 🔦 Elegant CP Fittings of Essco Or Equivalent

Windows

Anodized Aluminium Windows

Doors

Good quality white colour paint flush doors in all rooms

Amenities

- 🏠 Roof Top Garden
- 📞 Video Door Phone
- 🏠 Fully AC Community Hall
- 🎮 Games Room For Children
- 🏋️ Gymnasium
- 🕒 24 hrs Security
- 🔋 Power Backup





Projects Completed

- | | |
|---|---|
| <input checked="" type="checkbox"/> Meena Super Market | <input checked="" type="checkbox"/> Meena Florence |
| <input checked="" type="checkbox"/> Aradhana Apartment | <input checked="" type="checkbox"/> Meena Vatika |
| <input checked="" type="checkbox"/> Kamal Apartment | <input checked="" type="checkbox"/> Meena View |
| <input checked="" type="checkbox"/> Jyoti Apartment | <input checked="" type="checkbox"/> Meena Garden |
| <input checked="" type="checkbox"/> Pooja Apartment | <input checked="" type="checkbox"/> Meena Residency |
| <input checked="" type="checkbox"/> Krishnakunj Apartment | <input checked="" type="checkbox"/> Meena Ganga |
| <input checked="" type="checkbox"/> Radhakunj Apartment | |
| <input checked="" type="checkbox"/> Pranati Apartment | |
| <input checked="" type="checkbox"/> Maya Apartment | |
| <input checked="" type="checkbox"/> Jaya Apartment | |
| <input checked="" type="checkbox"/> Nilava Apartment | |
| <input checked="" type="checkbox"/> Madhuban Apartment | |
| <input checked="" type="checkbox"/> Mousumi Apartment | |
| <input checked="" type="checkbox"/> Manisha Apartment | |
| <input checked="" type="checkbox"/> Mayur Apartment | |
| <input checked="" type="checkbox"/> Manashi Apartment | |
| <input checked="" type="checkbox"/> Madhu Apartment | |
| <input checked="" type="checkbox"/> Megha Enclave | |
| <input checked="" type="checkbox"/> Bharatiya Enclave | |
| <input checked="" type="checkbox"/> Meena Siddhi | |



Upcoming Projects

Meena Sparsh	Rajarhat
Meena Orchid	Mahisbathan, Sec-V
Meena City	Airport
Meena Uddayan	Beliaghata
Meena Height	Agarpara (B.T. Road)
Meena Icon Sodepur	(B.T. Road)



Current Projects



Meena Glory



Meena Sparsh



Meena Wood



Meena Paradise



Meena Sangam



Meena Srishti



Meena Icon



Meena Pearl



GM GROUP

always with you...

AB-9, Salt Lake City, Sector-I, Kolkata 700 064

Ph.: +91 33 2334 8782 / 2358 6037

(M) : +91 8336087402 / 9830150306 / 8336087405 / 8336087404

Mail us at: gmab_9@rediffmail.com / sales@gmgroup.co.in / Sujit_spa@yahoo.co.in

Website : www.gmggroups.co.in

This brochure is not a legal document. It describes the conceptual plan and purpose of the project and is subject to change