



a perfect blend of
contemporary design for
QUALITY LIVING ...



SMR  **Astra**



SMR ASTRA
makes sure every
moment that you
spend in its enfold
is priceless.

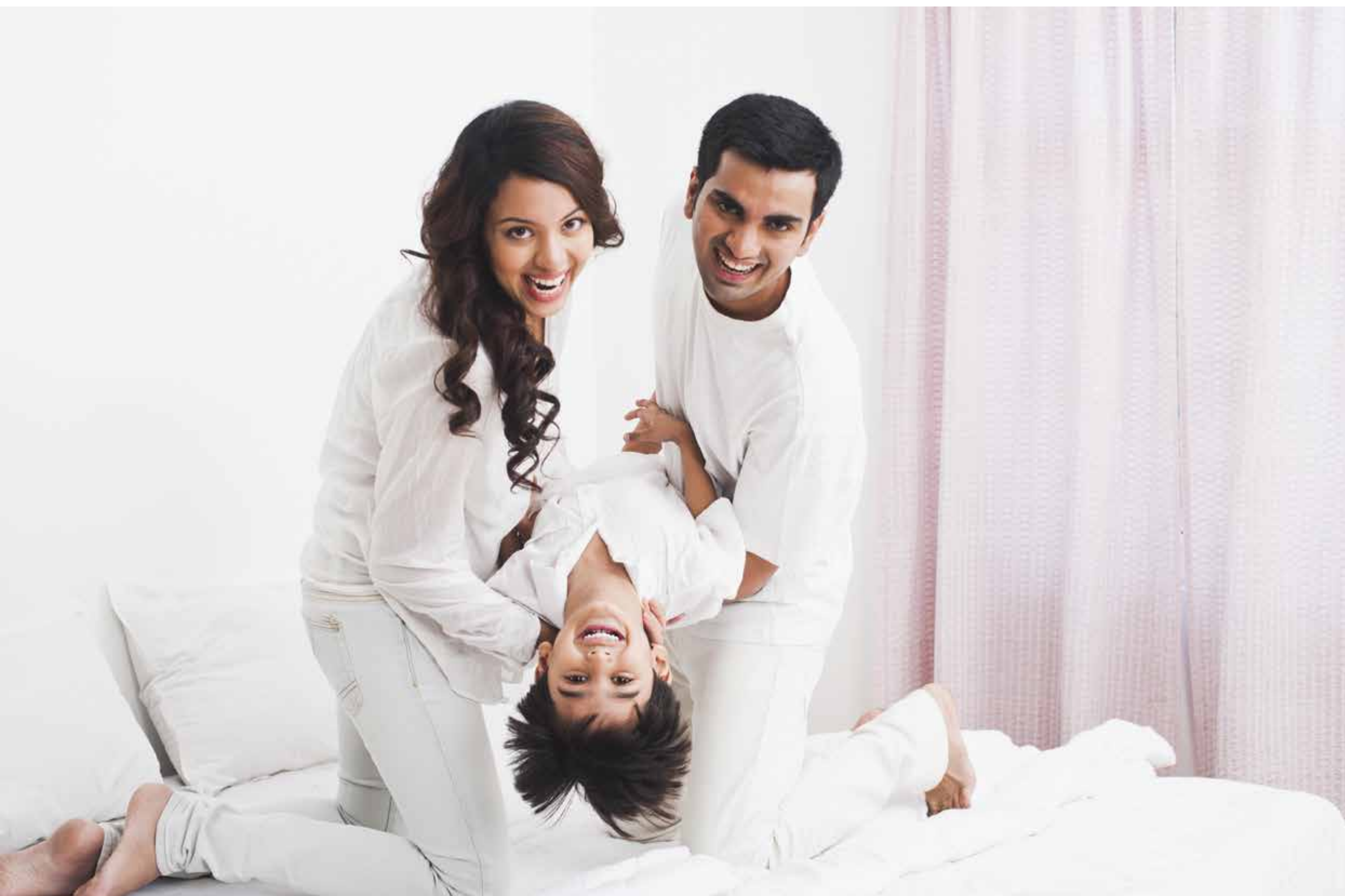

Demonstrating
contemporary
elegance, both outside
and inside.

Established with a vision of providing expert real estate solutions across a range of sectors, SMR ASTRA is the real estate venture of SMR INFRA. All the projects are designed with the highest quality standards, keeping in mind the modern lifestyle. A relationship of trust is the core value on which the foundation of SMR INFRA is built.

Epitomizing a perfect blend of contemporary design and quality construction, 'SMR ASTRA' is an integrated residential complex at Boisar in Thane district. Elegantly crafted apartments equipped with modern amenities and impressive features make a perfect dream home.

In today's world, what's more exclusive than a plush address is its readiness! While everyone else is only offering grand and lavish spaces, we are ready with the larger than life amenities.

Ambrosia welcomes you with a ready-to-use well equipped Gym and Multi purpose hall.

Get ready to be envied upon!



Typical Floor Plan

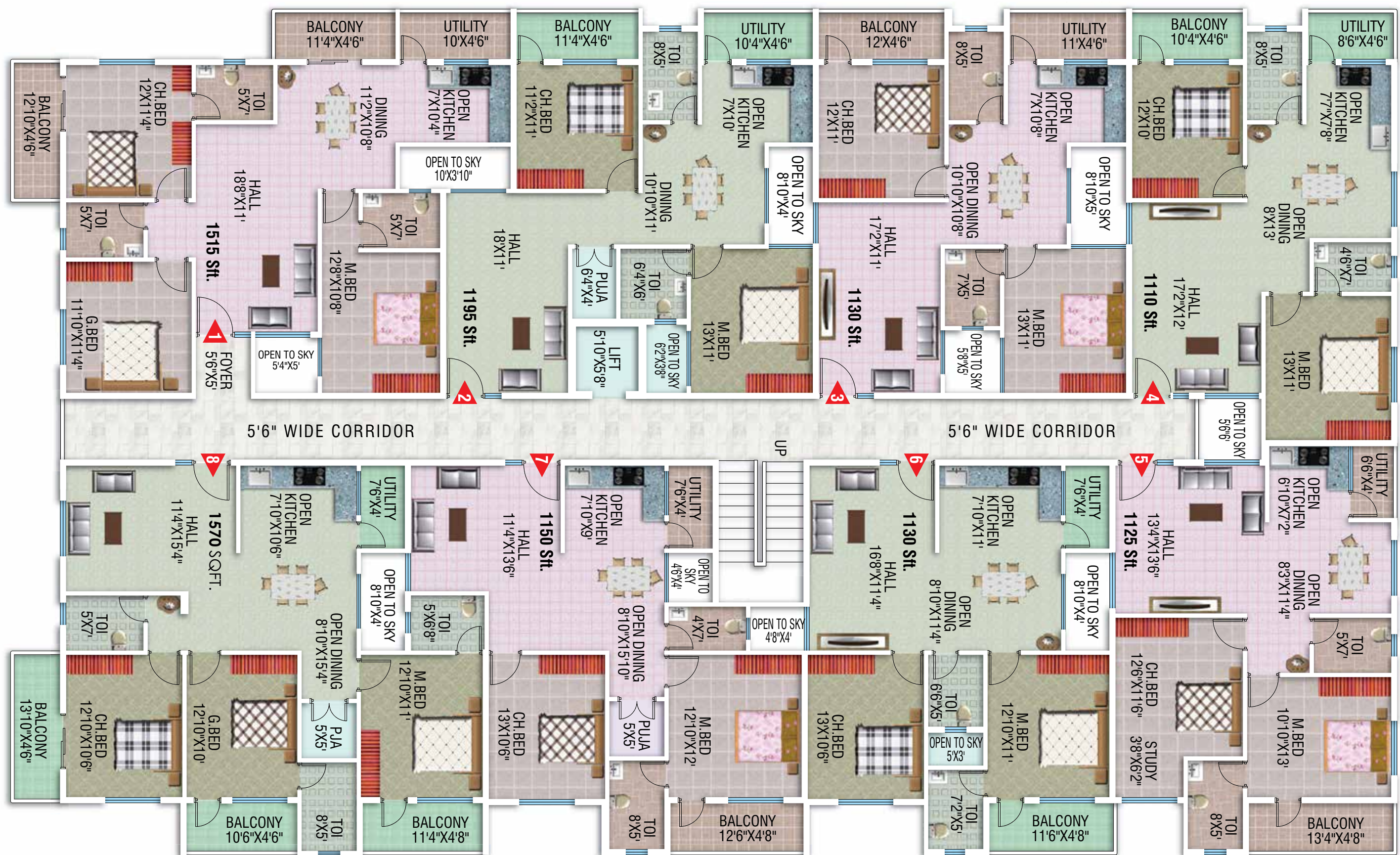

Flat No.	1	2	3	4	5	6	7	8
Total Area in Sft.	1515	1195	1130	1110	1125	1130	1150	1570

AMENITIES

- Multi purpose hall with guest room
- Fully equipped gym / health club
- Intercom
- E-Security with surveillance camera for 24 Hours
- Solar water heating facility in all bathrooms
- Rain water harvesting

HIGHLIGHTS

- All apartments designed according to Vaastu Shastra norms
- Close proximity to schools, hospitals metro station and multiplexes
- Ample water, electricity and emergency back-up



SPECIFICATIONS

STRUCTURE

RCC framed structure on footing / piles over hard strata with plinth beams for extra safety by using steel and cement of reputed make.

SUPER STRUCTURE

Advanced technology light weight 4”&6” solid cement blocks.



PAINTING

- External :** Texture paint with two coats of acrylic exterior emulsion.
- Internal :** Base coat with Birla/JK wall putty and two coats of premium emulsion paint over smooth putty finish.



PLASTERING

- Internal :** Double coat cement plaster for walls and single coat cement plastering for ceilings.
- External :** Double coat plaster for external walls, RCC and masonry surfaces.



Plumbing & Sanitary

- A. CP fittings of Jaquar or its equivalent make.
- B. All bathrooms consists of best quality sanitary fixtures
- C. Single lever fixtures with wall mixer cum shower for all bathrooms.
- D. Seperate piping for solar water, borewells & for Kavery water.

Electrical

- A. Concealed copper wiring of 'Lap India'/ Finolex or its equivalent make.
- Modular switches of ISO make Legrand or its equivalent make with adequate points.
- B. Plug points for T.V. and power outlets for AC in all rooms.
- C. Power plug for cooking range, chimney, refrigerator, microwave ovens, mixer / grinders in kitchen, washing machine in utility area



DOOR'S

- Main Door :** Teak wood frames (french window) with teak vineer doors aesthetically designed with melamine polishing and designer hardware of reputed make
- Bedroom Doors :** Teak wood frames with teak vineer doors aesthetically designed.



- Balcony/Bathroom Doors :** Sal wood frames with designer skin / flush door shutters.

FLOORING

- Living / Dining:** 1mt.x1mt. vitrified tiles.
- Bedrooms:** 2ft.x2ft. vitrified tiles.
- Bathrooms:** Anti-skid ceramic tiles / glazed tile cladding upto lintel level of reputed make.
- Kitchen :** A. Vitrified tiles B. Granite platform with stainless steel sink
- Common Areas :** Granite flooring in common areas and staircase.



Windows & French doors

UPVC windows and french door systems of reputed make and safety M.S grills with enamel paint finish.

Communication system

Provision for cable connection in all bedrooms and living room. Provision for Internet connection in every flat.

Power backup

Crompton/Kirloskar or its equivalent make generator to 100% power backup to all common amenities and limited power to individual flats.

LIFT

Automatic lift of ISO make OTIS/KONE or its equivalent.

WINDOWS

Three track UPVC windows with musquito mesh.

DISCLAIMER: The information herein i.e. specifications, designs, dimensions etc. are subjected to change without notifications as may be required by the relevant authorities or the assigned architect and cannot form a part of an offer or contract unless specially covered in the contract. Whilst every care is taken in providing this information. The owner, the developer and the managers cannot be held liable for variations. All illustrations and pictures are artists impressions only.

Location Plan

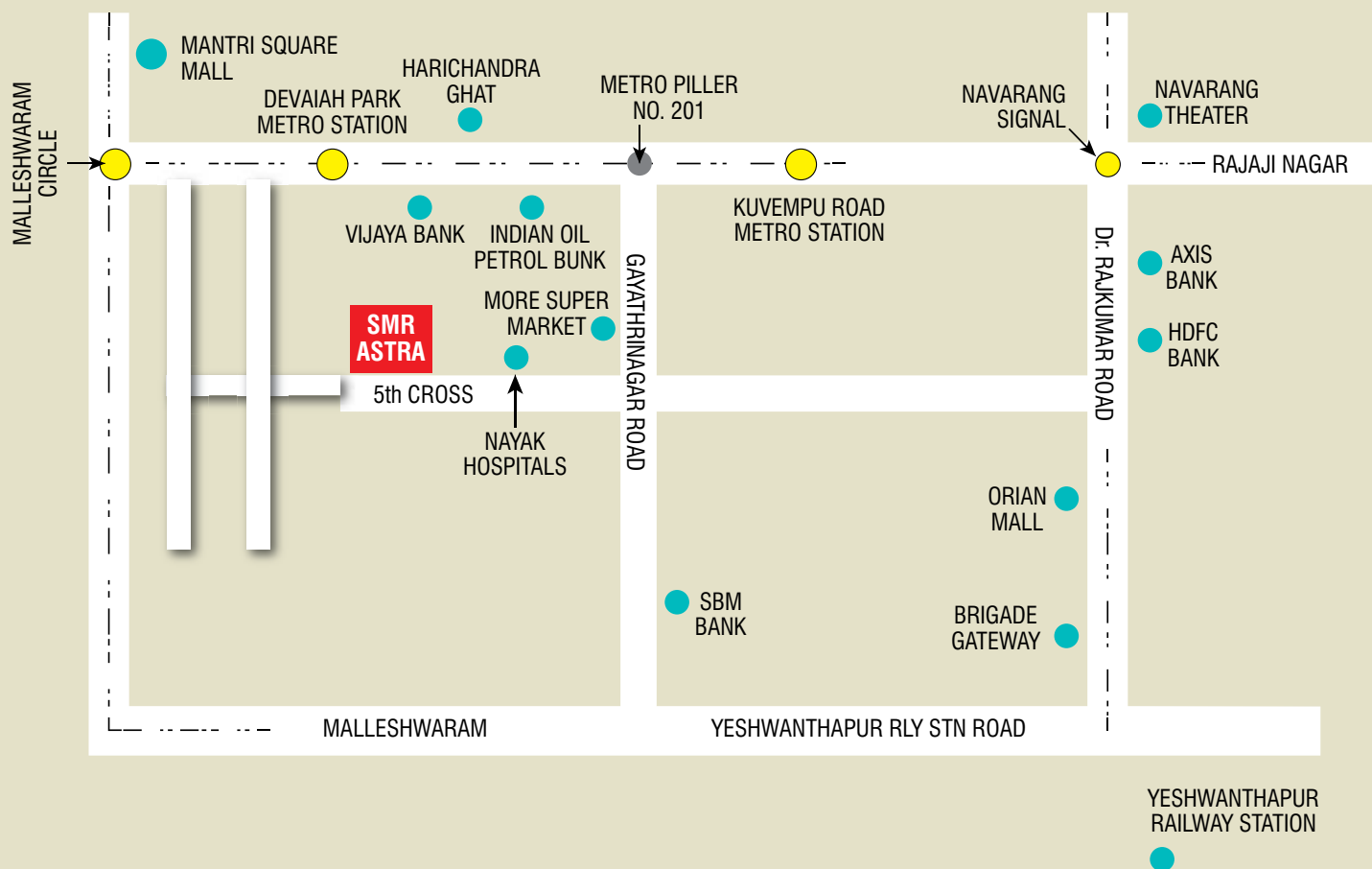

SMR INFRA

No.30&31, Hongasandra, behind HDFC bank lane
Bommanahalli, Bangalore- 560 068

Ph No: 9902265999, 7411880088

E-mail: smrhomesbgl@gmail.com
www.smrproperties.com

Architects
SREE GANESH ASSOCIATES
Ph: 98666 53017

Structural Engineers
MADHAVA RAO
Ph: 9849479319

Legal Adviser
Mr.A.Vijaya Saradhi, Advocate
Ph: 93412 58884