



OM SHRINIWAS DEVELOPERS

Site Add : Sr. No. 15/2/1+15/2/4 Near JSPM College, Handewadi Chowk, Hadapsar, Pune-411028

Contact: 777 603 4000 / 5000 | Email : sales@venkateshclassic.com

Office Add. : 1994, Sadashiv Peth, Madiwale Colony, Bajirao Road, Pune 411030

CREDITS

Architect :
AR. AMIT AVINASHE
Mob. +91 9730021649

R. C. C. Consultant :
HANSAL PARIKH & ASSOCIATES
Mob. +91 9890046867

Legal Advisor :
ADV. BHALCHANDRA NIKTE
Mob. +91 9822034081

Exclusively
Marketed by:
NORTHPOINT



VENKATESH
— CLASSIC —
1 & 2 BHK COZY HOMES

LIVE A FUSION OF
CLASSIC VALUES
CONTEMPORARY LIFE

www.venkateshclassic.com



WELCOME HOME TO JOYFUL LIVING

The modern day life is getting fast paced and taking us miles away from a harmonized and balanced living. At Venkatesh Classic, we aim to bridge that vital gap and offer you a brilliant fusion of classic values and contemporary life. Right here, you will experience a never before symphony of convenience, luxury, well planned lifestyle spaces, contented family life and rewarding social life. Our homes are thoughtfully designed to bring your dreams to life. The project is meticulously planned to offer you refreshing ambiance, delightful recreational amenities and greater access to lifestyle essentials and work places. It's a place that inspires you to spend quality time with family, broaden your social bonds and lead a joyful way of life. Come over, step into your dream home and watch your dreams coming alive.



VENKATESH CLASSIC



AMENITIES



Children's play area



Jogging track



Sewage treatment plant



Landscaped garden



Senior sit out area



Rainwater harvesting



Splash pool



Video door phone



Fire fighting system



Clubhouse



Garbage chute



Concrete road



Gymnasium



Solar water heating system



Street light



Indoor game



Intercom facility



Three automatic lifts
for each building



Yoga area



Common dish



Power back-up for lift
and common area
& many more...



Outdoor exercise zone



Vermicomposting







SPECIFICATIONS



FLOORING

- Vitrified flooring in all rooms and anti - skid flooring for terrace and bathroom



KITCHEN

- Granite kitchen platform with carysil granite sink
- Designer wall tiles up to lintel level



TOILETS

- Branded sanitary ware • Concealed plumbing with branded C. P. fittings
- Designer wall tiles up to lintel level



DOORS & WINDOWS

- Wooden safety door • Laminated / Moulded main entrance door Internal water proof Flush doors in every room with elegant handles and locks • Powder coated aluminum sliding windows with mosquito mesh • Granite / Marble door frames for toilet and wooden door frames for main door & bedrooms



WALLS & PAINTS

- Gypsum finished internal walls
- Premium quality paint on internal & plaster on external walls



ELECTRIFICATION

- Concealed FRLS copper wiring • Branded electrical fittings • Provision for inverter • Provision for A.C in Master bed room • Provision for Water purifier and exhaust fan • Provision for Washing machine in dry balcony • T.V. and Telephone point in living and master bedroom



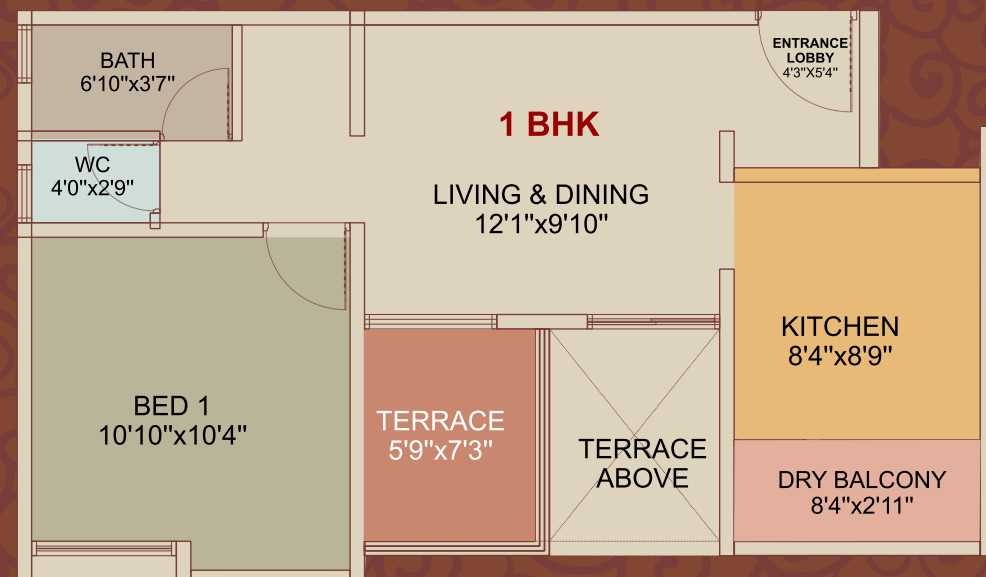

1BHK



2BHK

LOCATION MAP

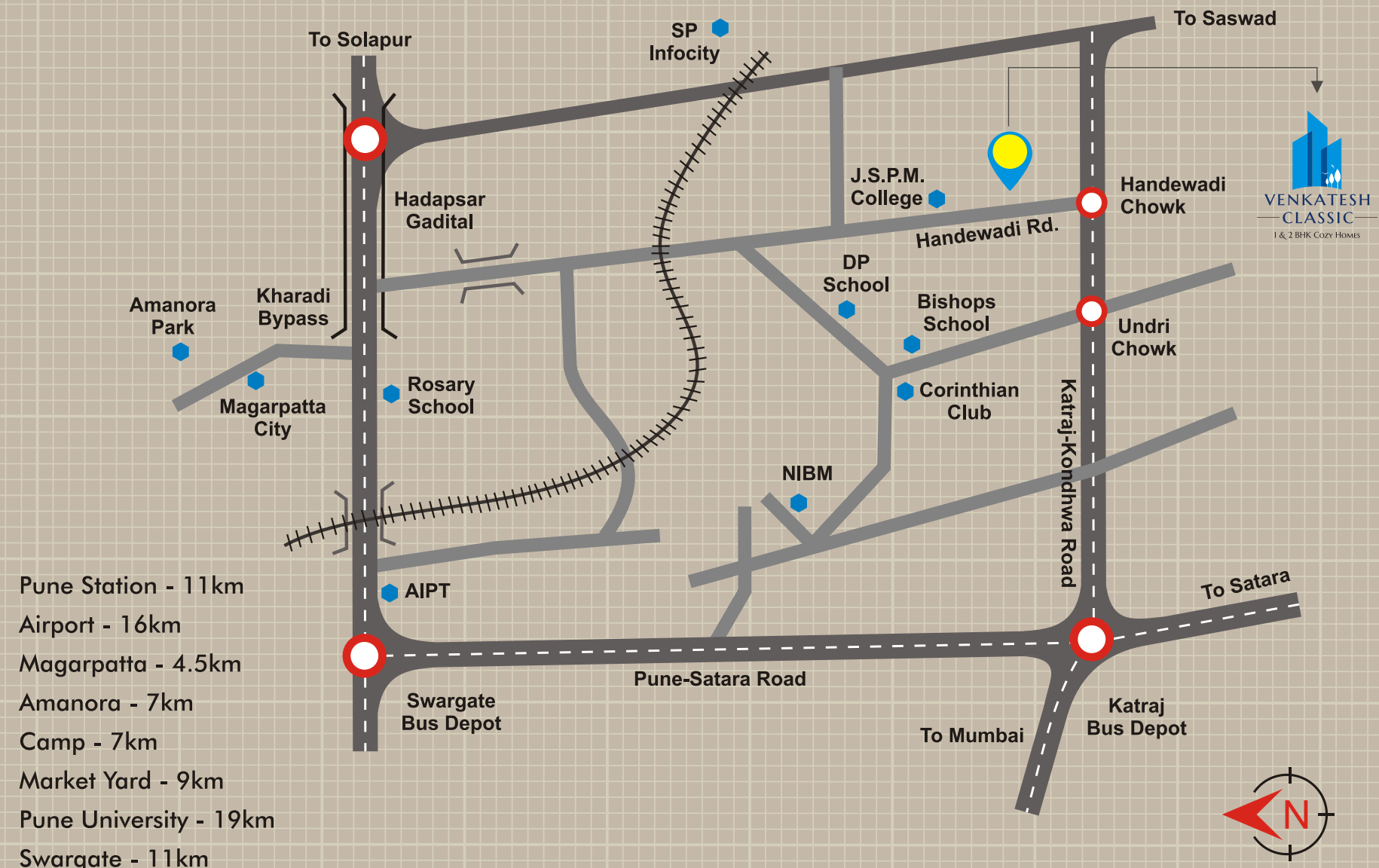

AN ADDRESS OF A GLORIOUS TOMORROW

Today Handewadi is one of the fastest growing localities in the vicinity of Pune. It's one of the preferred destinations of IT professionals due to its proximity to the IT park at Magarpatta and SP Infocity. Apart from that, it is conveniently close to Hadapsar that gives you access to malls, multiplexes, schools, colleges, hospitals, restaurants, market, banks & ATMs. So be it work or leisure, you are never far from all that you need to live a happy and comfortable life.

COMPLETED PROJECTS



CASAPOLI - WAKAD



CASA IMPERIA - WAKAD



AMBER CLASSIC - AMBEGAON



LA VALLE CASA -
CHANDANI CHOWK - BAVDHAN



COSMOS - BANER



THE MINT - BANER