



# GOVIANU

## HMT MAIN ROAD



CONTACT : - +91 8088 330 330

WEBSITE : [www.govianu.com](http://www.govianu.com)

EMAIL : [Info@govianu.com](mailto:Info@govianu.com)



---

# **EXCLUSIVE LIFESTYLE, ELITE NEIGHBOURHOODS, SUPREME CONSTRUCTION QUALITY**

---



GOVIANU has emerged as one of the most respected general contracting firms in the area of commercial and private constructions. The company has already proven its ability to take on large complex projects and complete them on time, on budget and at the highest level of quality. Over the last decade, the Govianu Group has firmly established itself as one of the leading developers of real estate in Bangalore by imprinting its indelible mark across all asset classes.

Founded in 2010, with the spirit of innovation at its core, GOVIANU always strives for quality, customer focus, robust engineering, uncompromising business ethics and steadfast commitment to timeless values and total transparency in every aspect of its business. These exceptional attributes have made Govianu progress consistently. The company already has several successful completed and ongoing projects in Bangalore, Mysore, Chikmagalur and Tumkur to its credit, and currently has one million sq. ft. under various stages of construction in residential, commercial and hospitality sectors. Innovation in our offerings combined with an emphasis on contemporary architecture, strong project execution and quality construction have helped us transform into a respectful brand that contributes to the fine art of living.

# GOVIANU HMT

GOVIANU HMT at Jalahalli is a one-of-a-kind residential tower nestled in one of the most peaceful neighborhoods of the city, yet just minutes away from everything you need. An elite neighbourhood, sprawling living spaces, view of the endless greenery and luxurious amenities that match your lifestyle - this is the life at 'Govianu HMT'.

With carefully crafted 3BHK homes ensuring maximum natural light, well-ventilated, extensive rooms & lavish balconies, we at Govianu invite you to experience the best of luxury living, just minutes away from Peenya and Outer Ring Road. Meticulously designed with premium specifications, these limited edition homes are a sanctum of style and perfection.

GOVIANU HMT is very conveniently located just behind Peenya Metro Station, offering excellent connectivity to the entire city. Popular shopping malls, hospitals, public transportation, and education centers are in close proximity to the property. With modern amenities, modern security systems and spacious covered parking, we have taken utmost care to ensure your retreat is as exclusive as your lifestyle.

Carve your own personal getaway at Govianu HMT. Come explore our world and become a part of our ever-growing family while we build your personalized dream home upon years of experience and trust.





# PROJECT HIGHLIGHTS

- » NUMBER OF FLOORS : PARKING + 11
- » NUMBER OF FLATS : 66
- » ONLY 6 FLATS PER FLOOR
- » 1 CAR PARKING PER UNIT
- » 100% VAASTU COMPLAINT
- » LAVISH SIZE ROOMS
- » TEAK WOOD MAIN DOORS
- » SPACIOUS BALCONIES
- » PREMIUM MATERIALS AND HIGH- END FINISHES.
- » COVERED CAR PARK
- » LED LIGHTING FIXTURES
- » GROHE SANITARY FIXTURES

# AMENITIES

-  24X7 100% POWER BACKUP
-  LUSH GREEN ENVIRONMENT WITH MANICURED GARDEN
-  24X7 CCTV SURVEILLANCE
-  ROUND THE CLOCK SECURITY
-  VISITER LOUNGE
-  KIDS PLAY AREA
-  WELL EQUIPPED GYM
-  JOGGING TRACK
-  24X7 WATER SUPPLY CAUVERY AND BOREWELL

## UNIT 2

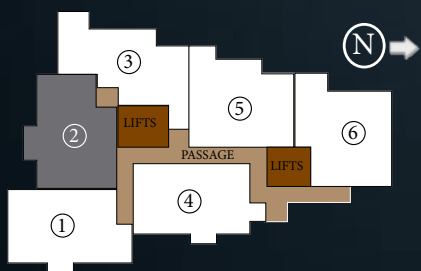

NORTH  
FACING

- |                             |                                |
|-----------------------------|--------------------------------|
| 1. FOYER<br>7'6" X 7'0"     | 8. BEDROOM 2<br>11'6" X 12'6"  |
| 2. LIVING<br>14'0" X 20'0"  | 9. A. TOILET 2<br>7'0" X 7'0"  |
| 3. KITCHEN<br>12'6" X 10'0" | 10. BEDROOM 3<br>11'6" X 12'6" |
| 4. UTILITY<br>8'0" X 5'6"   | 11. WARDROBE<br>9'0" X 5'6"    |
| 5. C.TOILET<br>7'0" X 5'6"  | 12. M.BEDROOM<br>13'0" X 14'6" |
| 6. DINING<br>9'6" X 13'0"   | 13. M. TOILET<br>9'0" X 5'6"   |
| 7. BALCONY<br>14'0" X 4'6"  | 14. BALCONY<br>13'0" X 3'6"    |





- |                                 |                                 |
|---------------------------------|---------------------------------|
| 1. FOYER<br>9'0" X 6'0"         | 8. C. TOILET<br>5'6" X 8'0"     |
| 2. LIVING ROOM<br>13'3" X 18'0" | 9. BEDROOM 2<br>12'6" X 11'0"   |
| 3. KITCHEN<br>8'0" X 10'6"      | 10. A. TOILET 2<br>9'0" X 5'0"  |
| 4. UTILITY<br>4'8" X 10'0"      | 11. WARDROBE<br>5'4" X 9'8"     |
| 5. DINING<br>11'0" X 10'0"      | 12. M. TOILET<br>5'4" X 9'0"    |
| 6. BALCONY<br>6'4" X 10'0"      | 13. M. BEDROOM<br>15'6" X 13'0" |
| 7. BEDROOM 3<br>11'0" X 12'6"   | 14. BALCONY<br>4'0" X 13'4"     |

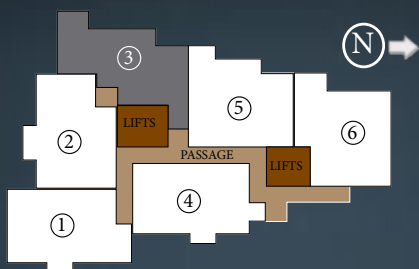

## UNIT 3



EAST  
FACING



EAST  
FACING



## UNIT 5

- |                               |                                 |
|-------------------------------|---------------------------------|
| 1. LIVING<br>13'3" X 17'6"    | 8. BEDROOM 2<br>11'6" X 13'0"   |
| 2. KITCHEN<br>11'0" X 8'0"    | 9. A. TOILET<br>8'6" X 5'0"     |
| 3. UTILITY<br>8'6" X 5'0"     | 10. WARDROBE<br>10'0" X 5'6"    |
| 4. DINING<br>19'0" X 10'0"    | 11. M. TOILET<br>9'0" X 5'6"    |
| 5. BALCONY<br>5'4" X 9'0"     | 12. M. BEDROOM<br>15'0" X 13'0" |
| 6. C. TOILET<br>5'0" X 8'6"   | 13. BALCONY<br>5'0" X 10'6"     |
| 7. BEDROOM 3<br>11'0" X 12'6" |                                 |

- |                             |                                 |
|-----------------------------|---------------------------------|
| 1. FOYER<br>10'6" X 5'6"    | 8. BEDROOM 2<br>12'0" X 12'6"   |
| 2. KITCHEN<br>10'6" X 8'0"  | 9. A. TOILET<br>6'0" X 7'0"     |
| 3. UTILITY<br>4'6" X 9'6"   | 10. BEDROOM 3<br>11'6" X 12'6"  |
| 4. LIVING<br>14'0" X 15'0"  | 11. WARDROBE<br>10'8" X 6'0"    |
| 5. BALCONY<br>14'0" X 4'0"  | 12. M. TOILET<br>5'6" X 9'0"    |
| 6. DINING<br>13'0" X 10'6"  | 13. M. BEDROOM<br>15'0" X 13'6" |
| 7. C. TOILET<br>8'6" X 5'0" | 14. BALCONY<br>3'6" X 13'6"     |



## UNIT 6



EAST  
FACING 1



# KEY PLAN



## TRANSPORT

- HMT Kias Bus Stop - 5 min
- Yeshwanthpur Railway Station - 15 min
- Peenya Metro Station - 15 min
- Kempegowda International Airport - 35 min

## NEAR BY LANDMARKS

- Peenya Metro - 7 min
- Brigade Rubix - 5 min
- IKEA - 30 min
- Ramaiah Institute of Technology - 20 min
- Iskcon Temple - 25 min
- Orchids The International School - 10 min
- Metro Peenya Depot - 5 min
- Tata Aquila Heights - 5 min
- NACIN - 3 min
- BEL circle - 7 min

## SHOPPING AND ENTERTAINMENT

- Orion Mall - 15 min
- Esteem Mall - 20 min
- Vaishnavi Sapphire Centre - 20 min
- Metro - 15 min

## HEALTH CARE

- HMT Hospital - 5 min
- BEL Hospital - 10 min
- Ramaiah Memorial Hospital - 20 min
- Bangalore Baptist Hospital - 25 min

# LOCATION MAP

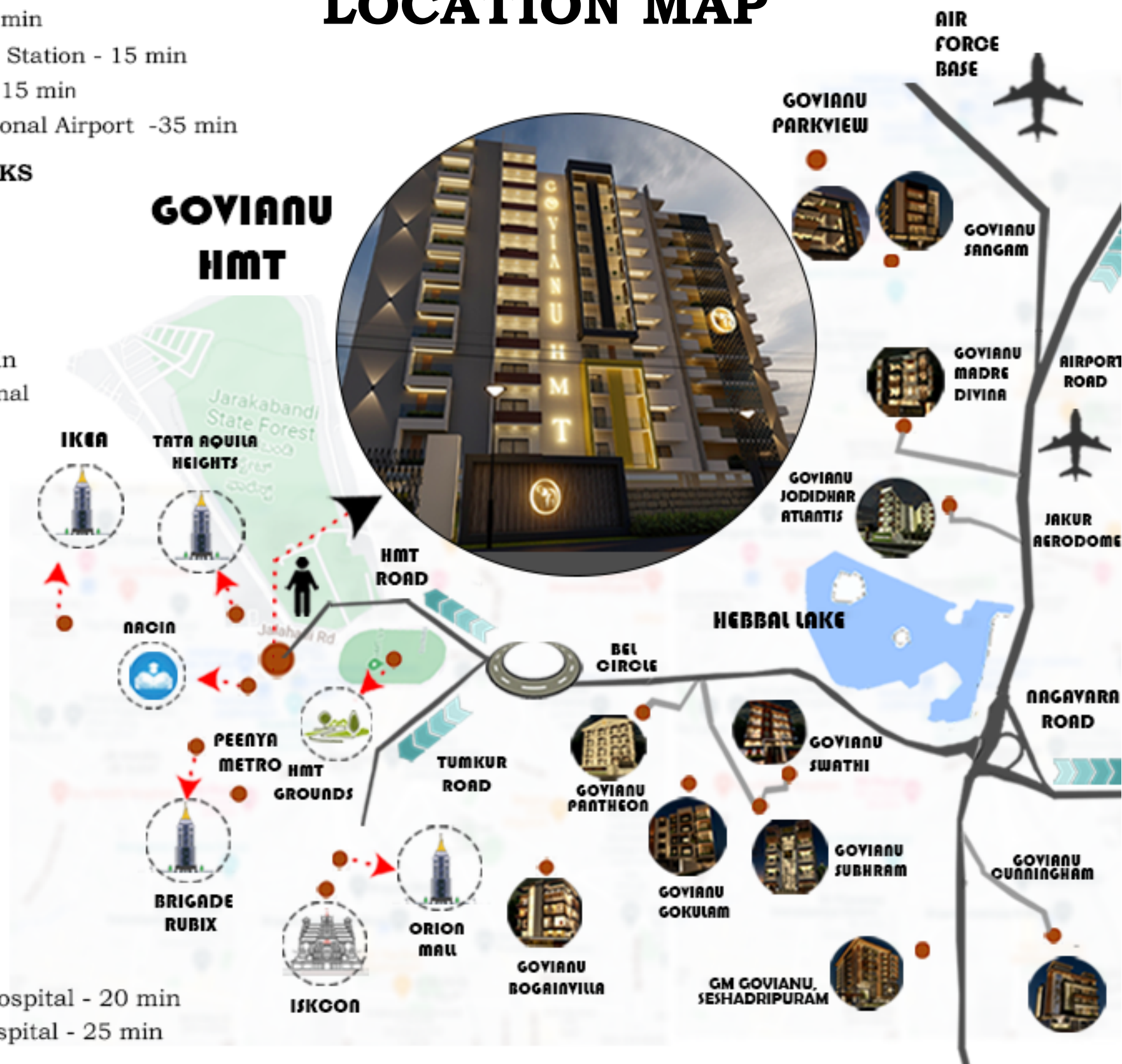





JUDICIAL LAYOUT,  
BENGALURU

GOVIANU MADRE DIVINA



YELAHANKA,  
BENGALURU

GOVIANU PARKVIEW



SAHAKARNAGAR,  
BENGALURU

GOVIANU JODIDHAR ATLANTIS



SANJAY NAGAR,  
BENGALURU

GOVIANU GOKULAM



CUNNINGHAM ROAD,  
BENGALURU

GOVIANU CUNNINGHAM



DOLLAR'S COLONY,  
BENGALURU

GOVIANU BOUGAINVILLA



ITTIGE GUDU,  
MYSORE

GOVIANU GURIKAR LUXURIA



YELAHANKA,  
BENGALURU

GOVIANU SANGAM



SESHADRIPURAM,  
BENGALURU

GM GOVIANU

# GOVIANU



DOLLAR'S COLONY,  
BENGALURU

GOVIANU PANTHEON



SANJAY NAGAR,  
BENGALURU

GOVIANU SUBHRAM



VIJAYANAGAR,  
BENGALURU

GOVIANU NAKSHATHRA



SANJAY NAGAR,  
BENGALURU

GOVIANU SWATHI



MALLESHWARAM,  
BENGALURU

GOVIANU MARGOSA



JOLDHAL,  
CHIKMAGULUR

GOVIANU CHIKMAGULUR RESORT



YESHWANTPUR,  
BENGALURU

GOVIANU ACE GRAND



BENSON TOWN,  
BENGALURU

GOVIANU BENSON



BENSON TOWN,  
BENGALURU

GOVIANU GRACE GARDEN





# GOVIANU

## HMT MAIN ROAD



CONTACT : - +91 8088 330 330

WEBSITE : [www.govianu.com](http://www.govianu.com)

EMAIL : [Info@govianu.com](mailto:Info@govianu.com)