



*It's time to experience  
'Eternal Peace'*



Presenting



*Sky Twins*

connect with your inner self  
7 Kondhwa

Explore the Hidden Secrets of

*7 Kondhwa*

Kondhwa, Pune's most sought after locale is a place that offers a mix of both worlds i.e. the development of a metro city and serenity of a country side retreat. Strategically located in close proximity to Hadapsar, Camp & Koregoan Park, living at Kondhwa is absolutely convenient.



# Experience *Zen Living*

Zen living is all about being in sync with your inner self and this level of deep connection takes us one step closer to achieve happiness.

Happiness is everything. If we are happy, it means that our environment and surroundings are working to keep us calm, composed and relaxed. Now it's time for you to experience peace like never before at Sky Twins, 7 Kondhwa.







## *A Glimpse* of Zen Living

Meditation is the crux of Zen living. At Sky Twins an ambience of tranquility and serenity exists all over the complex, thus giving you the opportunity to establish a relationship with your inner self and come closer to finding the peace that you have always longed for.



## A Jewel in the *Crown*

Design is everything and having said this, the entrance of the project has been embellished with breathtaking aesthetics so that anybody who enters the premises will be welcomed by a Zen aura. Also each strikingly white building stands tall amidst the spectacular greenery thus looking like a pearl.







## 16 Storeys of *Luxury*

Sculpted for perfection, Sky Twins is all set to become a residential landmark. Elevated 16 storeys high, every apartment is bound to receive its fair and abundant share of fresh oxygen and warm sunshine. The project's strategic construction amidst pristine surroundings and an alluring environment will give its residents an experience like never before.



Your home, within  
*a Paradise*





# The Habitat of *Rejuvenation*

All apartments at Sky Twins have a compact and cosy terrace that face the lush greenery of the neighbouring areas. The beautiful wilderness will engulf you with its refreshing effect and make you feel renewed & energized.







Spaces of *Elegance*

Living Room



## The Zone of *Self-Reclamation*



The bedroom is one place where you get to be yourself and enjoy complete privacy. At Sky Twins the bedrooms in all the apartments have been designed to create a sense of tranquillity and peacefulness.



Bedroom



2 BHK Apartments



A: Entrance Lobby  
B: Living Room  
C: Terrace  
D: Kitchen  
E: Dry Terrace  
F: Dining Area  
G: Common Toilet  
H: Childrens Bedroom  
I: Master Bedroom  
J: Master Toilet

2.5 BHK Apartments



A: Entrance Lobby  
B: Living Room  
C: Guest Bedroom  
D: Guest Bedroom Terrace  
E: Terrace  
F: Kitchen  
G: Dry Terrace  
H: Dining Area  
I: Common toilet  
J: Children's Bedroom  
K: Master Bedroom  
L: Master Toilet





Kitchen



Washroom

## SPECIFICATIONS

### Structure

- RCC framed earthquake resistance structure
- Internal gypsum/POP finish or equivalent
- Fire fighting systems

### Doors

- 8 feet height laminated main entrance door
- Laminated doors for bedrooms
- Laminated flush doors for toilet

### Windows

- Aluminum powder coated windows
- Granite sills for all windows
- M.S. safety grills

### Electrical Fittings

- Concealed wiring and good quality branded modular switches
- Provisions for split Air Conditioning in master bedroom and living room
- Provision for telephone in living and master bedroom
- Shuttered plug socket to avoid accidental contacts
- Miniature circuit breakers
- Exhaust fan in all toilets and kitchen
- Provision for Inverter backup

### Kitchen

- Granite kitchen platform with stainless steel sink
- Decorative dado tiles upto lintel level
- Dry terrace with provision for washing machine's inlet & outlet exhaust fan
- Water filter
- Concealed plumbing with hot and cold water outlets

### Bathrooms

- Jaguar or equivalent premium CP fittings with concealed plumbing
- Designer glazed dado tiles up to lintel level in all bathrooms
- Good quality branded sanitary ware
- Wall hung commode

### Flooring

- 800 x 800 vitrified tile flooring in living
- 600 x 600 vitrified in kitchen and bedrooms
- 600 x 300 vitrified tiles for toilet walls
- Anti-skid flooring in toilets
- Attached terraces and dry balconies

### Finishes

- Gypsum finishing to all internal walls
- Emulsion paint to internal walls
- Acrylic paint to external walls





# *The Zen Garden*

for soothing your mind, body and soul







Jogging Track

## *A Pulsating Experience*

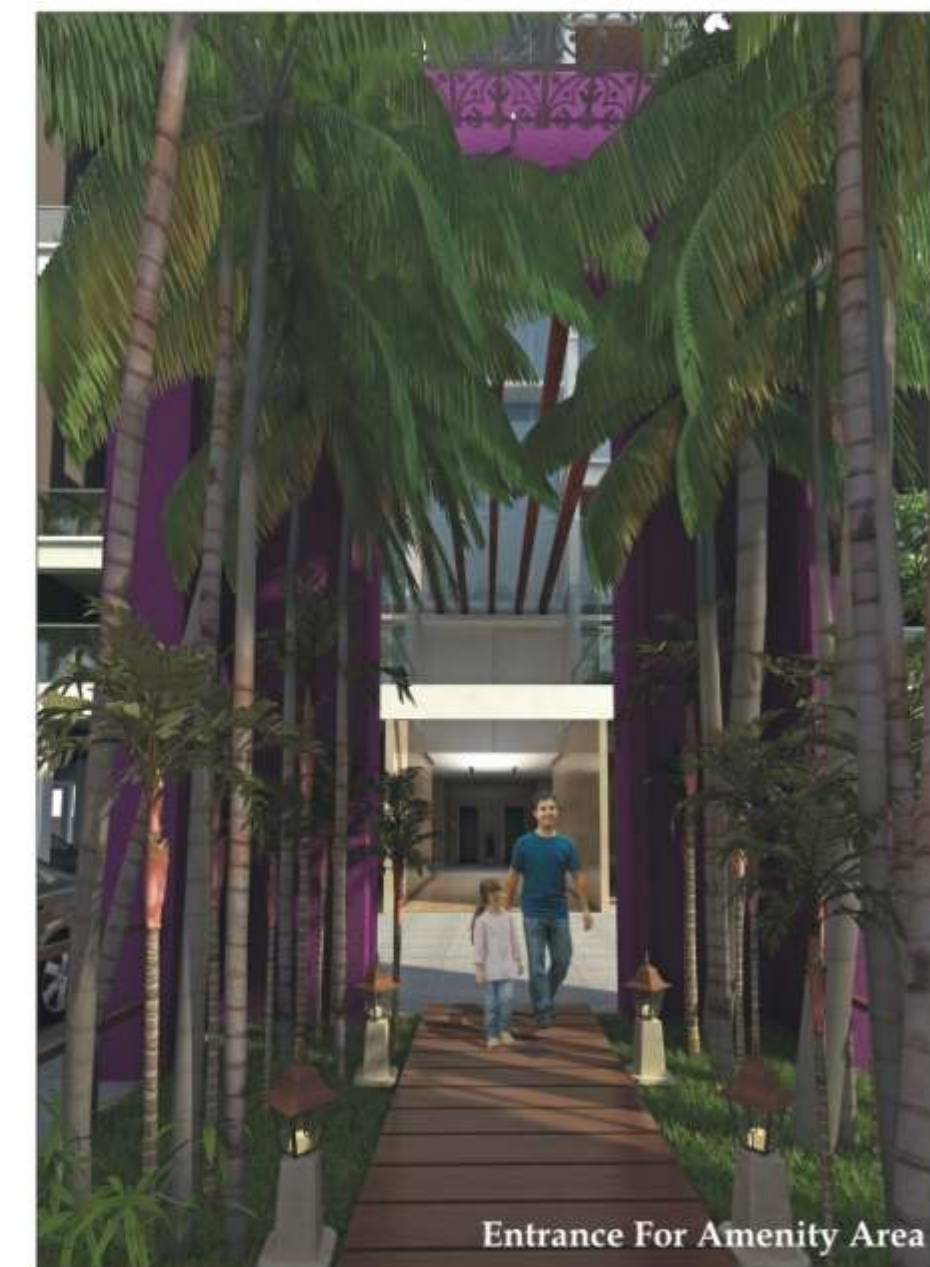

Entrance For Amenity Area

Enter the sleek and swanky club house and you'll automatically become upbeat and energetic. At Sky Twins, a gymnasium and various outdoor sports amenities have been added so that you can enjoy a healthy lifestyle. Also a landscaped jogging track has been designed for the ones who love to indulge in some cardio activity.





The Hot Spot of  
*Good Health*

Club House





A vibrant, sunlit garden scene featuring a large, curved swimming pool in the foreground. The pool is surrounded by a paved deck with a geometric pattern. To the left, a wooden pergola with climbing vines frames the view. The garden is filled with tropical plants, including tall palm trees and flowering shrubs. In the background, modern apartment buildings are visible through the foliage. Several people are walking along a path near the pool, and a small gazebo with a tiled roof stands in the distance.

## Explore the fun of *Zen Living*

Built on a large green area and embraced by some of the finest everyday amenities, Sky Twins is a paradise of modern and peaceful living. The excellent planning and layout of space within the complex and apartments is sure to give a feeling of abundance & extravagance. So whenever you need to recharge and unwind, your home is one place that will make you feel reborn and provide you with all nourishment you need.

Water Body





Embrace Peace,  
*Cherish Joy*



An authentic zen gazebo located in the amenity area is a perfect place to spend time with your friends and loved ones.

Also if you want some time by yourself to think and reflect then this spot offers you all the peace and silence to do so.





## Celebrate in *Style*

The perfect social life is incomplete without celebrations. The open air party deck along with a photo wall and garden is the most suited place to host parties and celebrate festivities. Designed to handle a considerably large group of people, one can celebrate the way they want and rejoice the moments of joy and happiness.



Party Lawn With Stage





Landscaped Garden With Acupressure track

## Amenities For *Grandiose Living*



Gymnasium

### AMENITIES

- Jogging track
- Children's play area
- Sand-pit area
- Garden area
- Party lawn
- Decorative gazebos
- Amphitheater
- Acupressure track
- Gymnasium.
- Half basket ball court
- Club house
- Table tennis / pool table.
- Carrom
- Chess
- Entrance with passenger drop-off & waiting area
- 100% power back-up for common areas
- L.P.G reticulated pipe system
- Automatic lifts with 24 hour power backup
- Seismic resistant design
- Separate sanitation facility for drivers and servants
- Dedicated car washing area
- Intercom system







Bishops School	9 Mins.	Corianthan Club	9 Mins.	Camp	9 Mins.
Vibgyor School	6 Mins.	Market Yard	5 Mins.	Hadapsar	13 Mins.
Delhi Public School	9 Mins.	Lullanagar	4 Mins.	Noble Hospital	13 Mins.
Sinhgad Institutes	5 Mins.	NIBM Road	3 Mins.	Pune-Mumbai Express Way	12 Mins.
Bharti Vidyapeeth	13 Mins.	Swargate	13 Mins.	( Via Katraj )	



Wagholi

**skylights**  
True Magnificence  
1, 1½ & 2 BHK Luxurious Apartments



Wagholi

**SKYWATER**  
WATER FRONT HOMES  
1, 1½ & 2 BHK  
Water Front Homes

Kondhwa Annexe

**Sky Square**  
2 & 2.5 BHK Residential  
& Built-To-Suit Commercial Spaces



**Sky Twins**  
connect with your inner self  
7 Kondhwa





**RAVINANDA**  
LANDMARKS

**Site Address**

S. No. 7, Sky Twins, Dharmawat Nagar, Next To Sai Service Station, Kondhwa (BK), Pune.

**Call:** 8381 00 3000 | 8381 00 4000

**Website:** [www.ravinandalandmarks.com](http://www.ravinandalandmarks.com)

**Website:** [skytwins@ravinandalandmarks.com](mailto:skytwins@ravinandalandmarks.com)

**Head Office**

Ravinanda Landmarks, 38 Vastushree Complex, Market Yard, Pune 37

NOTE : This Brochure is purely conceptual and is designed in good faith to give you a fair and overall view of the project and is not a legal offering, nor will it be part of any agreement. Photographs are not necessarily comprehensive or current. Nothing contained in this brochure will take precedence in the final agreement. Number of buildings, areas, flats/units, amenities, specifications, floors, roads, open space etc. may be revised.