

TRIDENT 9

2 BHK You-Centric Homes | Baner Annexe

Welcome Home ▲▲▲

An invigorating journey is about to begin!

INSPIRED BY YOU. CRAFTED FOR YOU!

Welcome home at Trident 9. Your own fascinating world awaits you here. Situated amidst the plush locality of Baner-annexe. And nestled in a picturesque backdrop of serene vistas. Get the best of both worlds while embarking on an enriching lifestyle. The lavish apartments of Trident 9 have been designed keeping you in mind. The set of exciting amenities offered, is just to add more charming colours to your wonderful living experience. And the top of the line luxuries have been created to comfort your mind, body and soul. Because, nothing but you, are the inspiration behind this immaculately crafted project.

Welcome aboard to this invigorating journey...

2 BHK You-Centric Homes | Baner Annexe





Your world of lifetime happiness



Presenting - You-centric homes!



A PROJECT LIKE NO OTHER. A CREATION BEYOND COMPARE.

Spread over a large expanse, Trident 9, is an origin of prosperity. Gracefully adorned by the finest quality construction and a plethora of exciting amenities, this project would certainly be a breathtaking creation. Comfortable & Spacious 2 BHK homesuites here have been designed to suit all your needs, to fulfill all your aspirations. With state-of-the-art architecture and smart layout planning, this creation is an icon in making. Very soon, it will be renowned as a landmark in the vicinity.

Own this prestigious address now...





ARTISTIC IMPRESSIONS

LEISURELY DELIGHTS FOR JOYFUL EXUBERANCE

AMENITIES ▶

- ▶ GRAND ENTRANCE GATE
- ▶ CLUB HOUSE
- ▶ GYM
- ▶ SECURITY CABIN



YOU-CENTRIC AMENITIES & VALUE-ADDS TO ELEVATE THE LIFESTYLE QUOTIENT



CLUB HOUSE

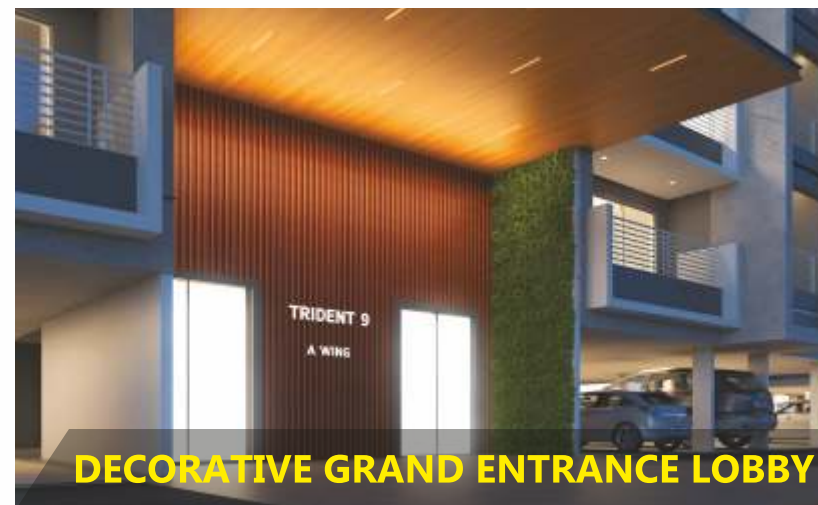

DECORATIVE GRAND ENTRANCE LOBBY

- | | | |
|--------------------|------------------------|------------------------------------|
| ▶ CC TV CAMERA | ▶ CHILDREN'S PLAY AREA | ▶ SOLAR SYSTEM |
| ▶ VIDEO DOOR PHONE | ▶ MOTHER'S DEN | ▶ RAIN WATER HARVESTING |
| ▶ INTERCOM | ▶ CELEBRATION ZONE | ▶ LIFT WITH BACKUP |
| ▶ PARTY LAWN AREA | ▶ FIRE FIGHTING SYSTEM | ▶ GENERATOR BACKUP IN COMMON AREAS |

ARTISTIC IMPRESSIONS



TOP-OF-THE-LINE SPECIFICATIONS FOR YOU-CENTRIC PLUSH LIVING

STRUCTURAL

- ▶ Seismic resistance R.C.C structure .
- ▶ Aesthetically designed elevation.

BRICK WORK

- ▶ 5" thick Eco friendly bricks

PLASTER

- ▶ External sand face plaster.
- ▶ Gypsum finish plaster for internal wall & ceilings.

DOORS

- ▶ Both sided laminated main door & bed room doors .
- ▶ Fully openable galvanized terrace doors.

WINDOWS

- ▶ 2/3 track Powder coated aluminium windows with mosquito nets.
- ▶ Marble sill frame for all window
- ▶ MS Grills All Window

FLOORING

- ▶ 600mm X 600mm Vitrified Tiles for all rooms.
- ▶ Antiskid ceramic flooring in all bathrooms, Terrace & Balcony

KITCHEN

- ▶ Granite platform with S.S. sink.
- ▶ Dado tiles upto lintel level above kitchen platform.
- ▶ Water Purifier provision in kitchen.
- ▶ Provision for exhaust fan in kitchen.
- ▶ Dry balcony with provision for washing machine

TOILETS

- ▶ Concealed plumbing with Chrome Polished fitting of jaguar.
- ▶ Premium quality Sanitary fitting in all toilet.
- ▶ Dado tiles upto lintel level all bathroom.
- ▶ Decorative granite door frames.
- ▶ Solar water system for each flat in common bedroom.
- ▶ Provision for Geyser in Master bedroom.
- ▶ Provision for exhaust fan in all toilets.

ELECTRIFICATION

- ▶ Concealed copper wiring with circuit breaker.
- ▶ Premium quality modular switches.
- ▶ T.V. Point in Living room & Master Bedroom.
- ▶ Provision for AC points in living and Master bedroom.
- ▶ Provision for Inverter.

ELEVATORS

- ▶ Premium quality with generator back-up

PAINTING

- ▶ Apex Paint for external walls.
- ▶ OBD paint for internal walls.



SPECIFICATION

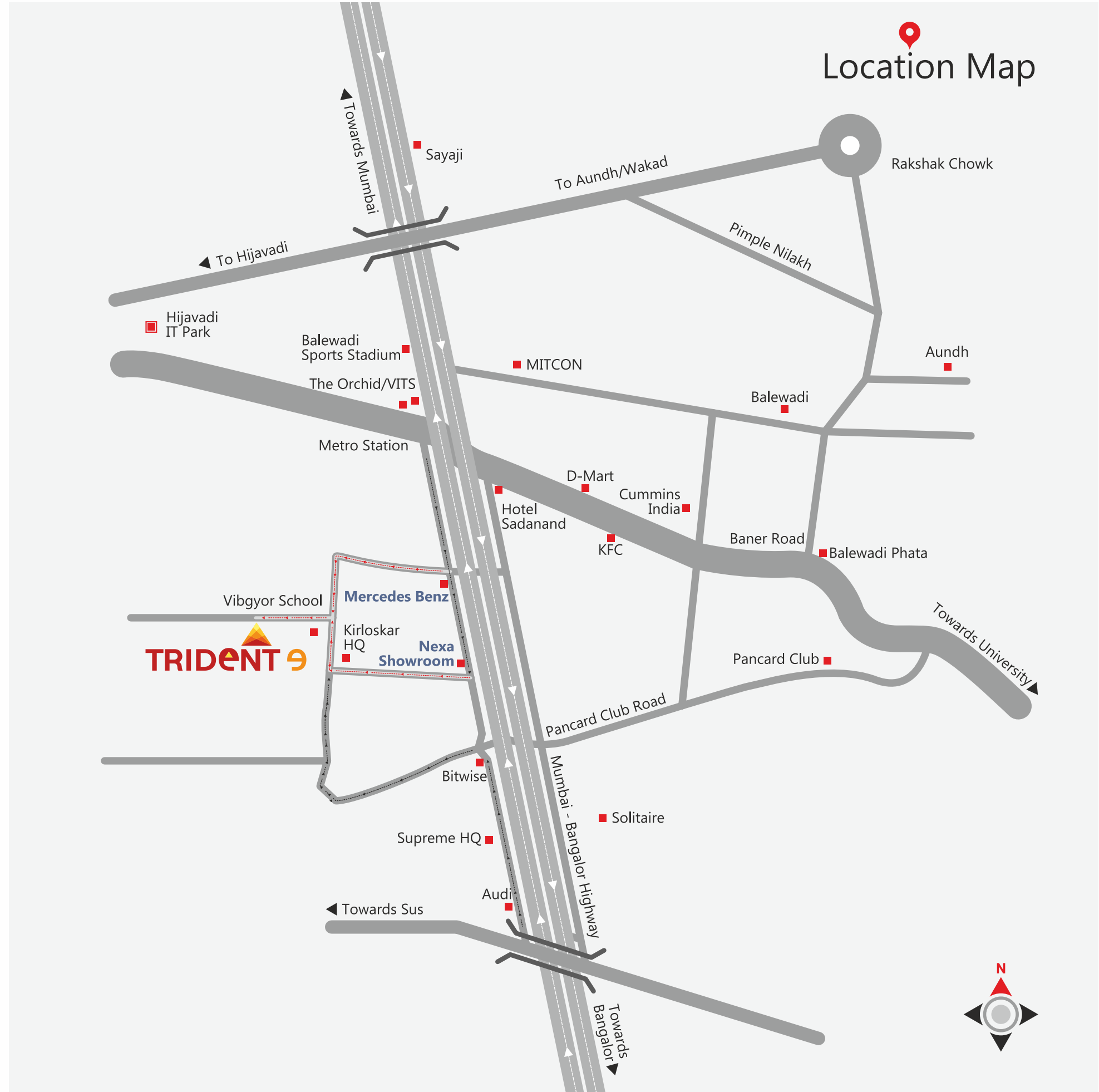

THE EPICENTER OF CONVENIENCE & CONNECTIVITY

The location is ideal in every aspect. It offers you a set of lifelong advantages. All that you need to celebrate a fabulous life with your loved ones, is within your easy reach! Be it schools, institutes, healthcare facilities, eatery joints or gymnasiums; all lifestyle conveniences are enviably close. Besides, nearness to bypass means easy access to all fast-developing suburbs like Wakad, Aundh, Pashan, Bavdhan etc.. And proximity to Hinjavadi IT hub and other global career opportunities is the icing on the cake!

Belong to this promising locale full of possibilities...

Location Details :

- ▶ Vibgyor School 50 mtr.
- ▶ Mhalunge maan Hi Tech City 200 mtr.
- ▶ Pune-Mumbai Bypass 800 mtr.
- ▶ Metro Station 1 km
- ▶ Balewadi Stadium 1 km
- ▶ Westside Shopping mall 1.2 km
- ▶ D-Mart 1.7 km
- ▶ Balewadi Hi Street 3.8 km
- ▶ Jupiter Hospital 4.4 km
- ▶ Hinjavadi Phase I 7 km
- ▶ Chandani Chowk 9.5 km
- ▶ Shivaji Nagar Bus Stand 12 km
- ▶ Pune Station 15 km
- ▶ Pune International Airport 22 km

- **CREDITS :**
- **ARCHITECT :** SUBHA ARCHITECT
- **RCC :** 3D PRIME
- **LEGAL :** ADV. SUNIL AWARE
- **BRANDING :** NOETIC DEVICES



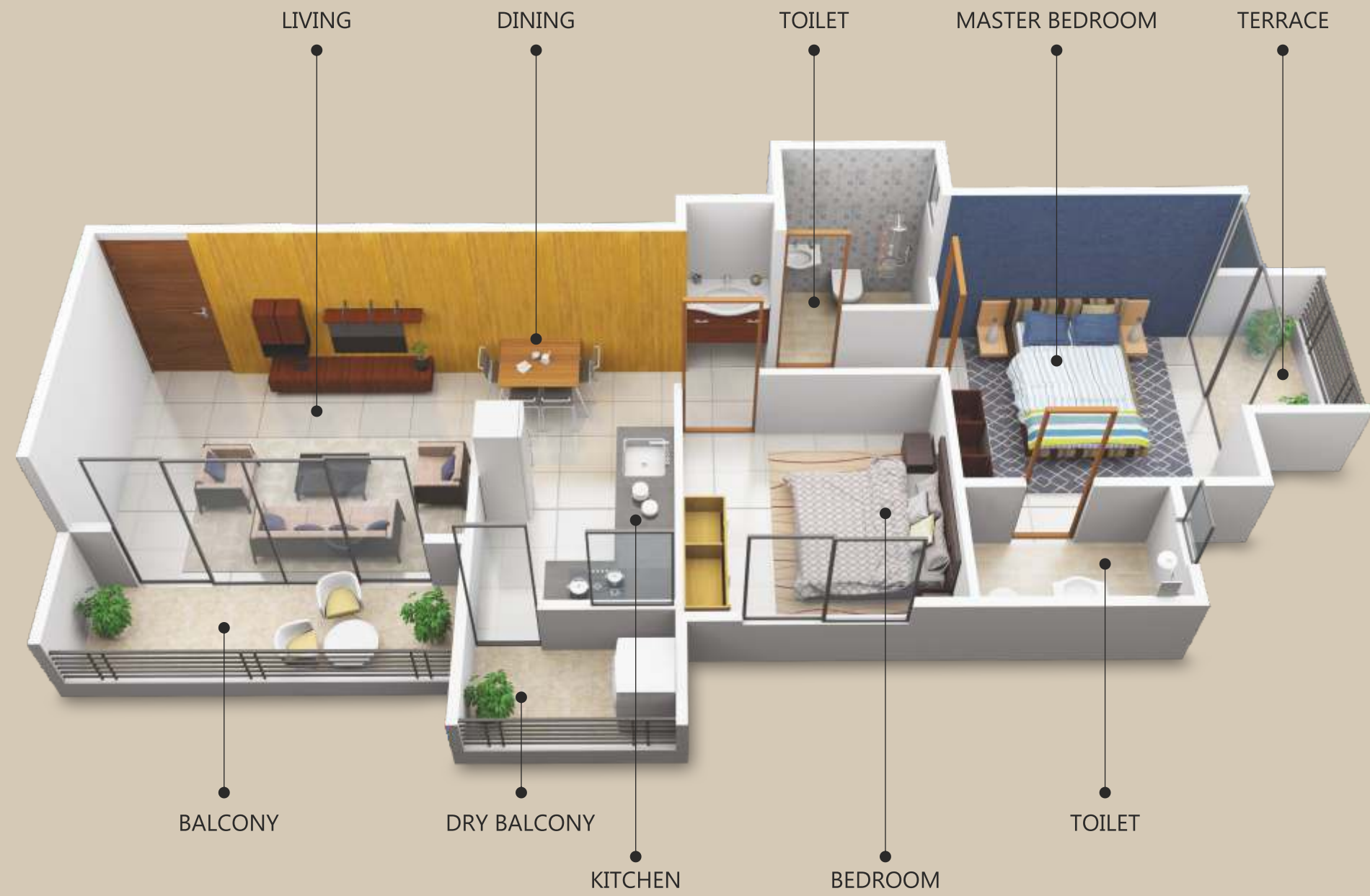

ARTISTIC IMPRESSIONS



ARTISTIC IMPRESSIONS



REGISTRATION NO
P52100024707
www.maharera.mahaonline.gov.in



A project by

Committed to build the best

Yashoda
Developers

JV with _____
Namdevrao Golande family

MEMBER OF



📍 **Site Add** : Sr. No. 28/1, Near Vibgyor School, Behind Mercedes Benz Showroom Baner, Sus, Pune, MH. 411021

📍 **Office Add** : The Pearl Society, B 104, Near Bharti vidyapeeth, Balewadi, Pune-411045

✉ **E** : yashodadevelopers9@gmail.com | 📞 **M** : +91 8575 909 909

Disclaimer : This brochure is purely conceptual and not a legal offering nor will it be part of the agreement. Nothing contained in this brochure will take precedence in the final agreement. Number of buildings, areas, amenities, specifications, floors, number of flats / units may be revised. Promoters reserve the right to amend the layout, plans, elevations, designs, specifications, amenities, etc. without prior notice.