



I & 2 BHK Apartments @ YEOLEWADI



The project has been registered via MahaRERA Registration No. P52100054760
& is available on the website <https://maharera.mahaonline.gov.in> under registered projects.





*Artistic Impression



*Artistic impression



*Artistic impression

LEGENDS

1. MAIN ENTRANCE
2. GAZEBO
3. PARTY LAWN
4. CLUB HOUSE
5. SWIMMING POOL
6. KIDS POOL
7. BASKET BALL RING
8. CHILDREN'S PLAY AREA
9. AMPHITHEATRE
10. SAND PIT AREA
11. YOGA/MEDITATION AREA





*Artistic impression



*Artistic impression

*Artistic Impression



1 BHK APARTMENT

LEGEND

- | | |
|-----------------|-------------|
| (A) Entrance | (F) Bath |
| (B) Living Room | (G) Toilet |
| (C) Dining Area | (H) Bedroom |
| (D) Kitchen | (I) Terrace |
| (E) Dry Terrace | |



LEGEND

- | | |
|-----------------|---|
| (A) Entrance | (F) Master Bedroom with attached toilet |
| (B) Living Room | (G) Bedroom |
| (C) Dining Area | (H) Bath |
| (D) Kitchen | (I) Terrace |
| (E) Dry Terrace | |

2 BHK APARTMENT (COMPACT)



2 BHK APARTMENT

LEGEND

- | | |
|---------------|---------------------------------------|
| A Entrance | F Master Bedroom with attached toilet |
| B Living Room | G Bedroom |
| C Dining Area | H Bath |
| D Kitchen | I Terrace |
| E Dry Terrace | |

SPECIFICATIONS in details...

R.C.C.

- Structure designed with earthquake resistant frame

ELECTRIFICATION

- Concealed electrical wiring
- Renowned modular switches
- A/C point in master bedroom
- Standard ISI multi strand wires with MCB

FLOORING

- Vitrified tiles
- Anti-skid tiles for terraces, dry balcony and toilets

KITCHEN

- Granite / marble platform
- Stainless steel sink
- Dado tiles up-to 4' height
- Water purifier provision
- Exhaust fan provision

TERRACE / BALCONY

- Provision for washing machine in dry balcony

DOORS

- Modular doors with CP fittings

WINDOWS

- Granite / marble window sills
- Aluminium powder coated windows with mosquito net
- Window grills
- Sliding door for terrace

BATHROOM

- Concealed plumbing
- Health faucet
- Bathroom glazing up-to 7' height
- Granite / marble door frames for bathrooms
- Solar heated water in master bathroom
- Geyser provision in common bathroom
- Exhaust fan provision

SPECIAL FEATURES

- Concrete road with trimix finish
- Fire fighting system
- Underground and overhead tanks
- P.O.P. / gypsum wall finish with oil bond distemper paint for interiors
- Acrylic emulsion paint for exteriors
- Anti termite treatment for the entire complex

CONVENIENCE

- Cable and telephone points in living room and master bedroom

SECURITY

- Video door phone
- CCTV cameras for selected common area
- Security cabin

POWER BACKUP

- Generator back-up facility for common areas, elevators & water pumps

EXCLUSIVITY

- Renowned elevators, 2 for each wing

ECO FRIENDLY FEATURES

- Solar water heating
- Rainwater harvesting
- Sewage treatment plant
- Organic waste converter

DISCLAIMER
This brochure is a purely conceptual representation and not a legal offering. All images in this brochure are merely for representation and not literal. The images are only indicative of furniture arrangement, furniture and accessories will not be provided by the developer. All plans are subject to accommodate the changes as per sanctioning authority.

WING - B
First Floor Plan

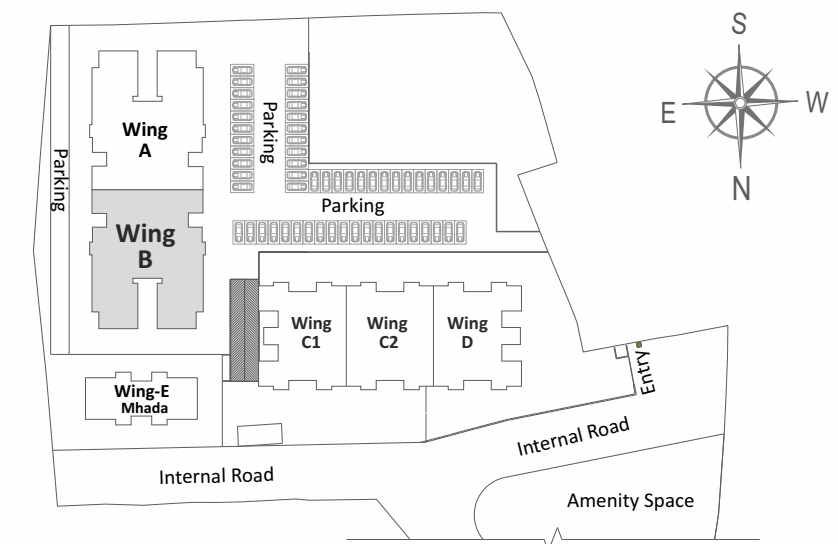
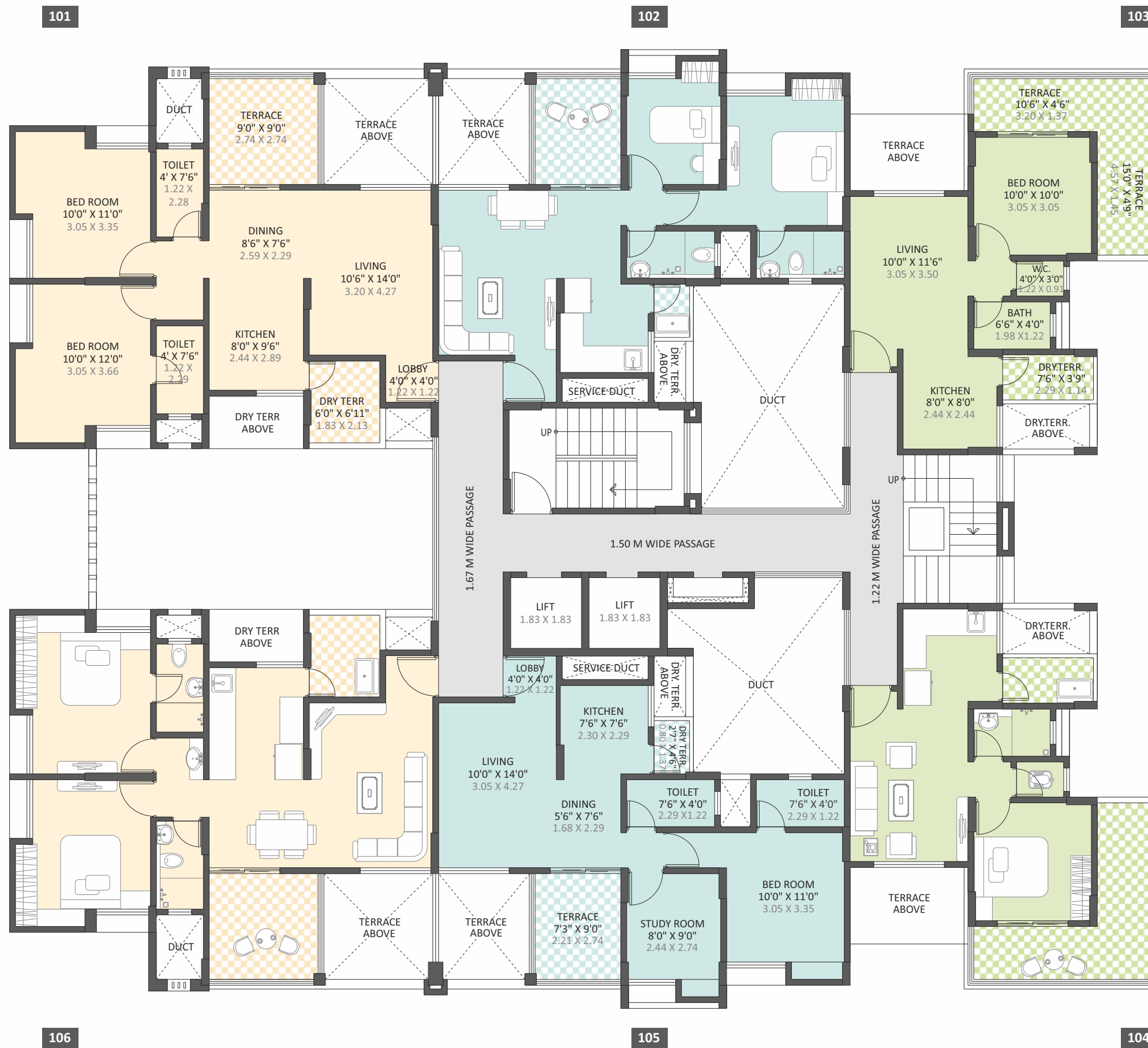

FLAT NO.	TYPE	CARPET AREA			TOTAL CARPET AREA	
		FLAT CARPET	TERRACE CARPET	DEFAULT TERRACE	SQ.MT.	SQ.FT.
101	2 BHK	65.05	11.60	–	76.65	825
102	2 BHK (C)	53.07	7.35	–	60.42	650
103	1 BHK	35.52	6.92	3.42	45.86	494
104	1 BHK	35.52	6.92	3.42	45.86	494
105	2 BHK (C)	53.07	7.35	–	60.42	650
106	2 BHK	65.05	11.60	–	76.65	825

WING - B
Typical 2nd, 4th, 6th & 10th Floor Plan

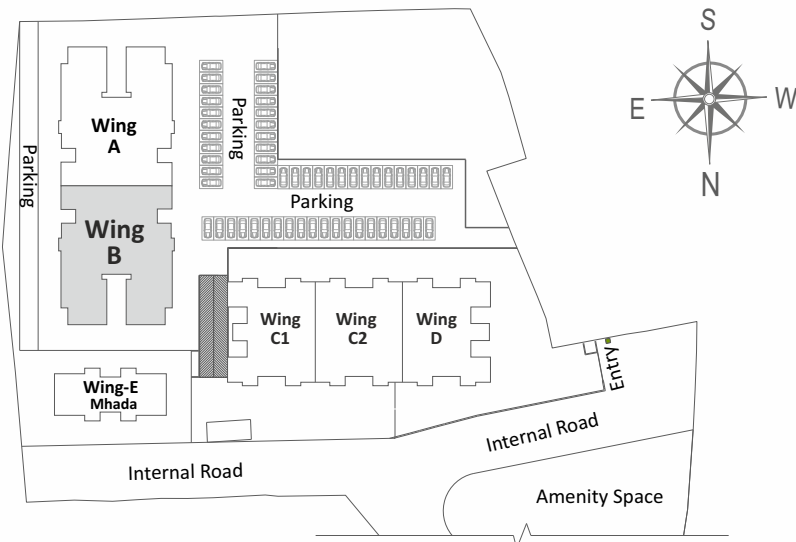

FLAT NO.	TYPE	CARPET AREA		TOTAL CARPET AREA	
		FLAT CARPET	TERRACE CARPET	SQ.MT.	SQ.FT.
201, 401, 601, 1001	2 BHK	64.77	10.88	75.65	814
202, 402, 602, 1002	2 BHK (C)	52.39	7.68	60.07	647
203, 403, 603, 1003	1 BHK	35.55	8.47	44.02	474
204, 404, 604, 1004	1 BHK	35.55	8.47	44.02	474
205, 405, 605, 1005	2 BHK (C)	52.39	7.68	60.07	647
206, 406, 606, 1006	2 BHK	64.77	10.88	75.65	814

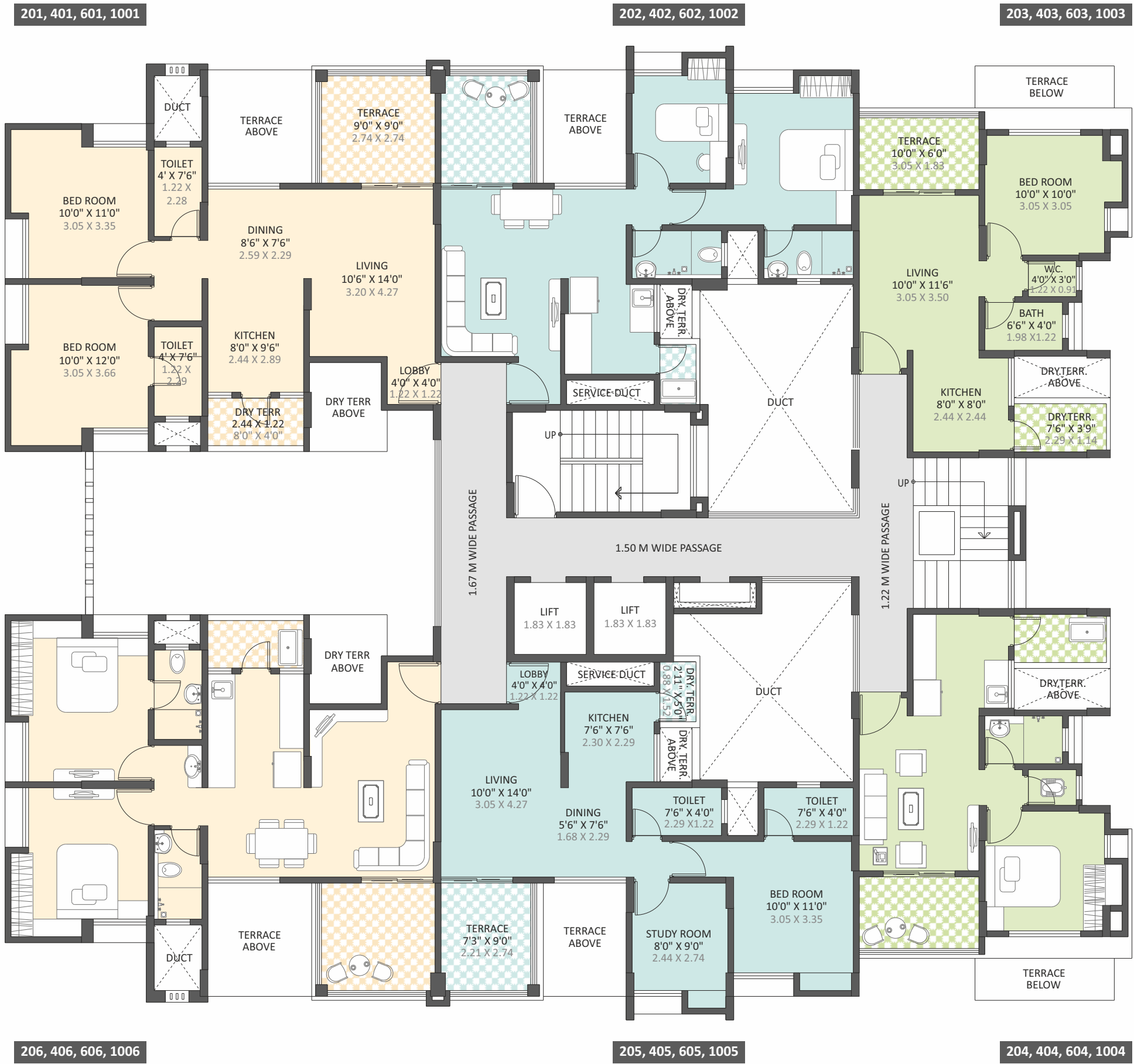

WING - B
Typical 3rd, 5th, 7th, 9th & 11th Floor Plan

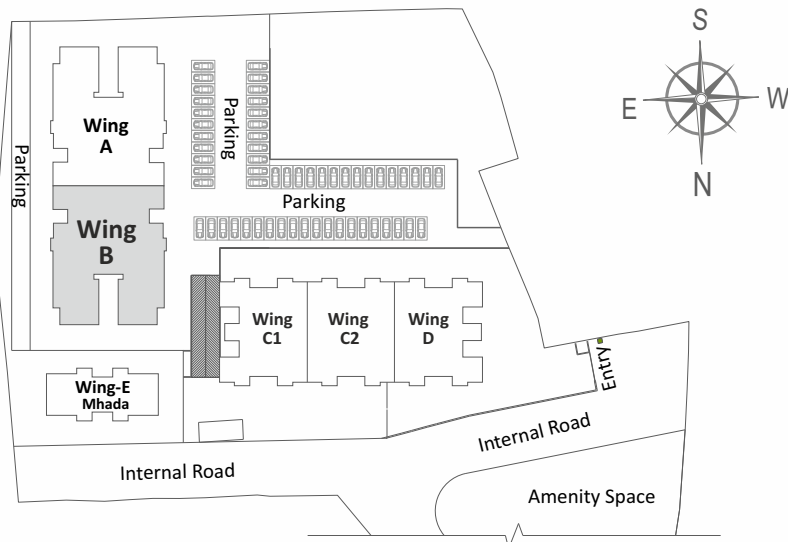

FLAT NO.	TYPE	CARPET AREA		TOTAL CARPET AREA	
		FLAT CARPET	TERRACE CARPET	SQ.MT.	SQ.FT.
301, 501, 701, 901, 1101	2 BHK	65.05	11.60	76.65	825
302, 502, 702, 902, 1102	2 BHK (C)	53.07	7.35	60.42	650
303, 503, 703, 903, 1103	1 BHK	35.52	6.92	42.44	457
304, 504, 704, 904, 1104	1 BHK	35.52	6.92	42.44	457
305, 505, 705, 905, 1105	2 BHK (C)	53.07	7.35	60.42	650
306, 506, 706, 906, 1106	2 BHK	65.05	11.60	76.65	825

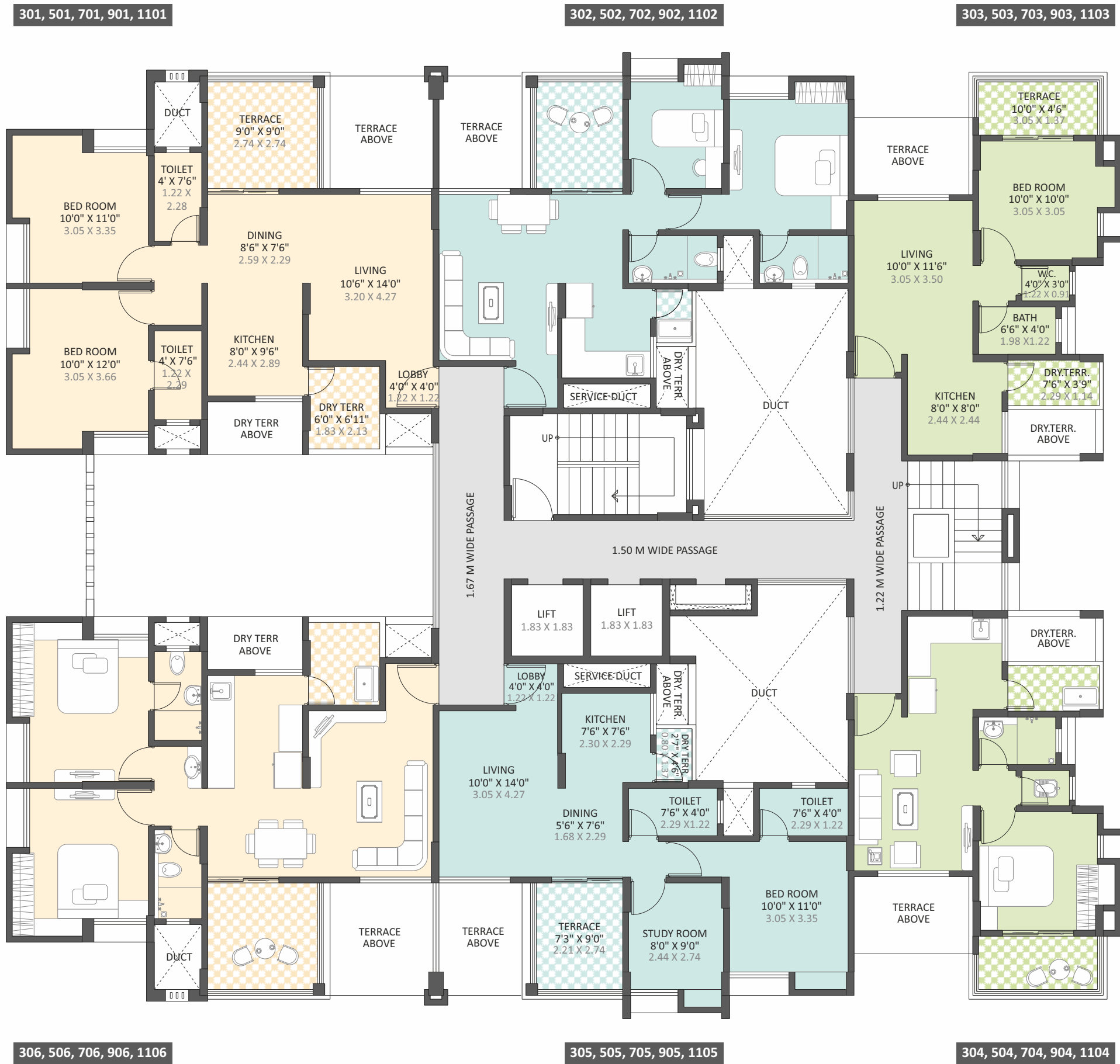

WING - B
8th Refuge Floor Plan

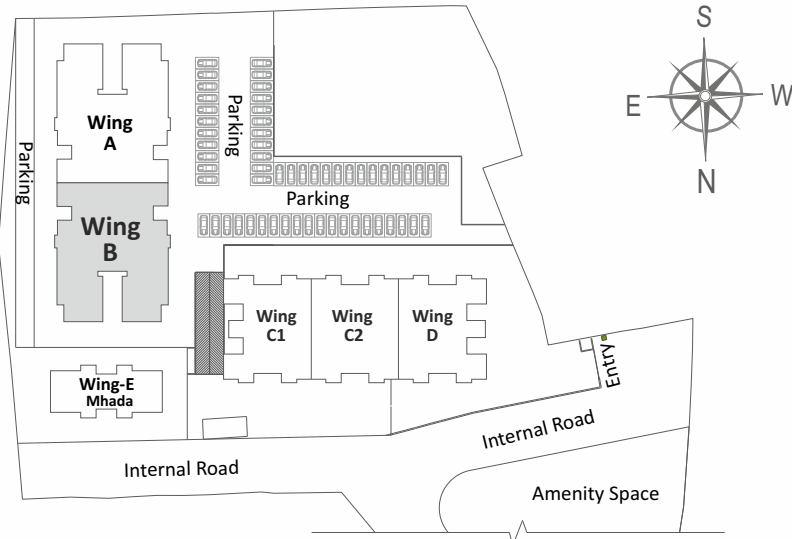

FLAT NO.	TYPE	CARPET AREA		TOTAL CARPET AREA	
		FLAT CARPET	TERRACE CARPET	SQ.MT.	SQ.FT.
801	2 BHK	64.77	10.88	75.65	814
802	2 BHK (C)	52.39	7.68	60.07	647
803	1 BHK	35.55	8.47	44.02	474
804	1 BHK	35.55	8.47	44.02	474
805	REFUGE AREA				
806	2 BHK	64.77	10.88	75.65	814

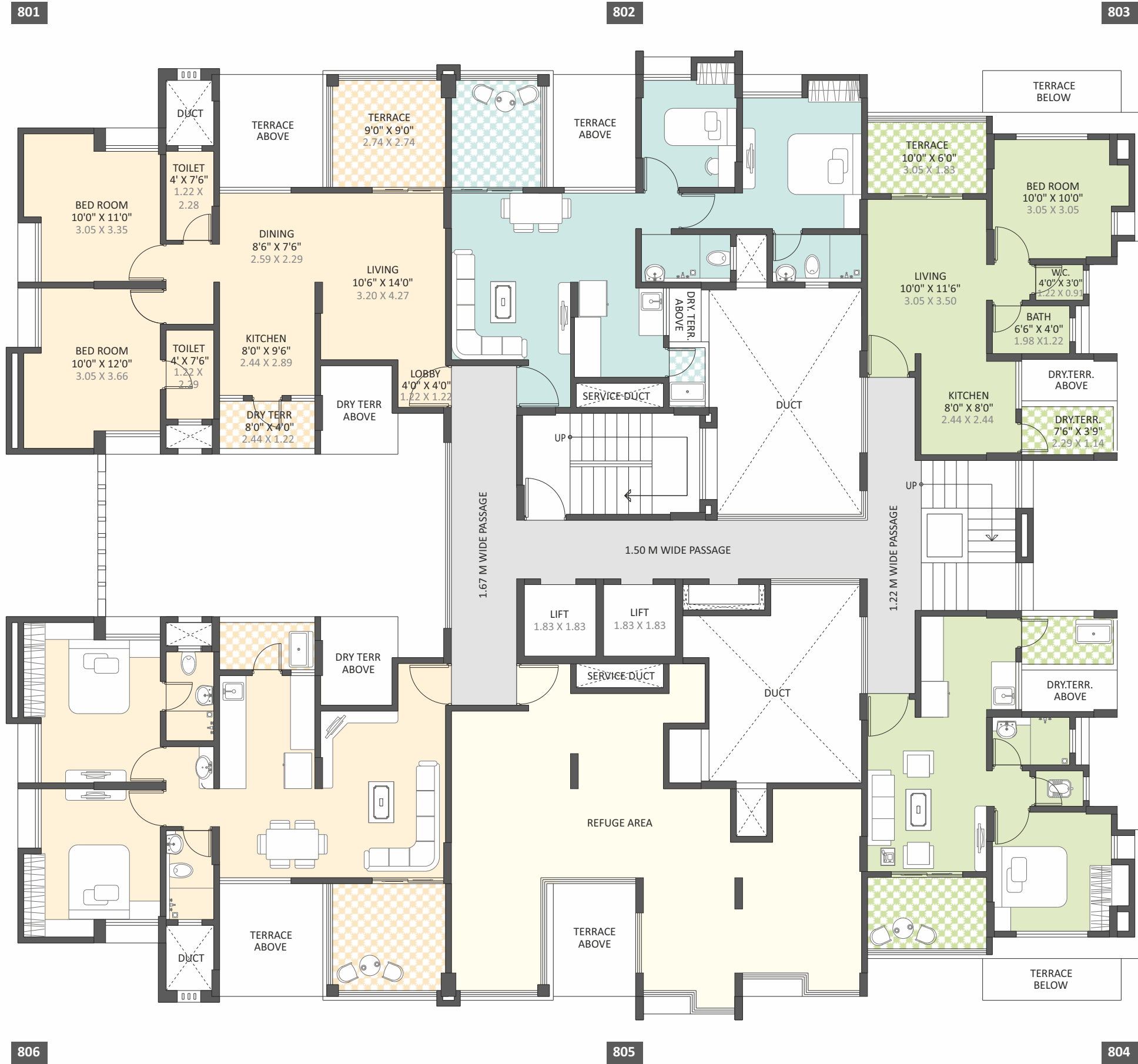

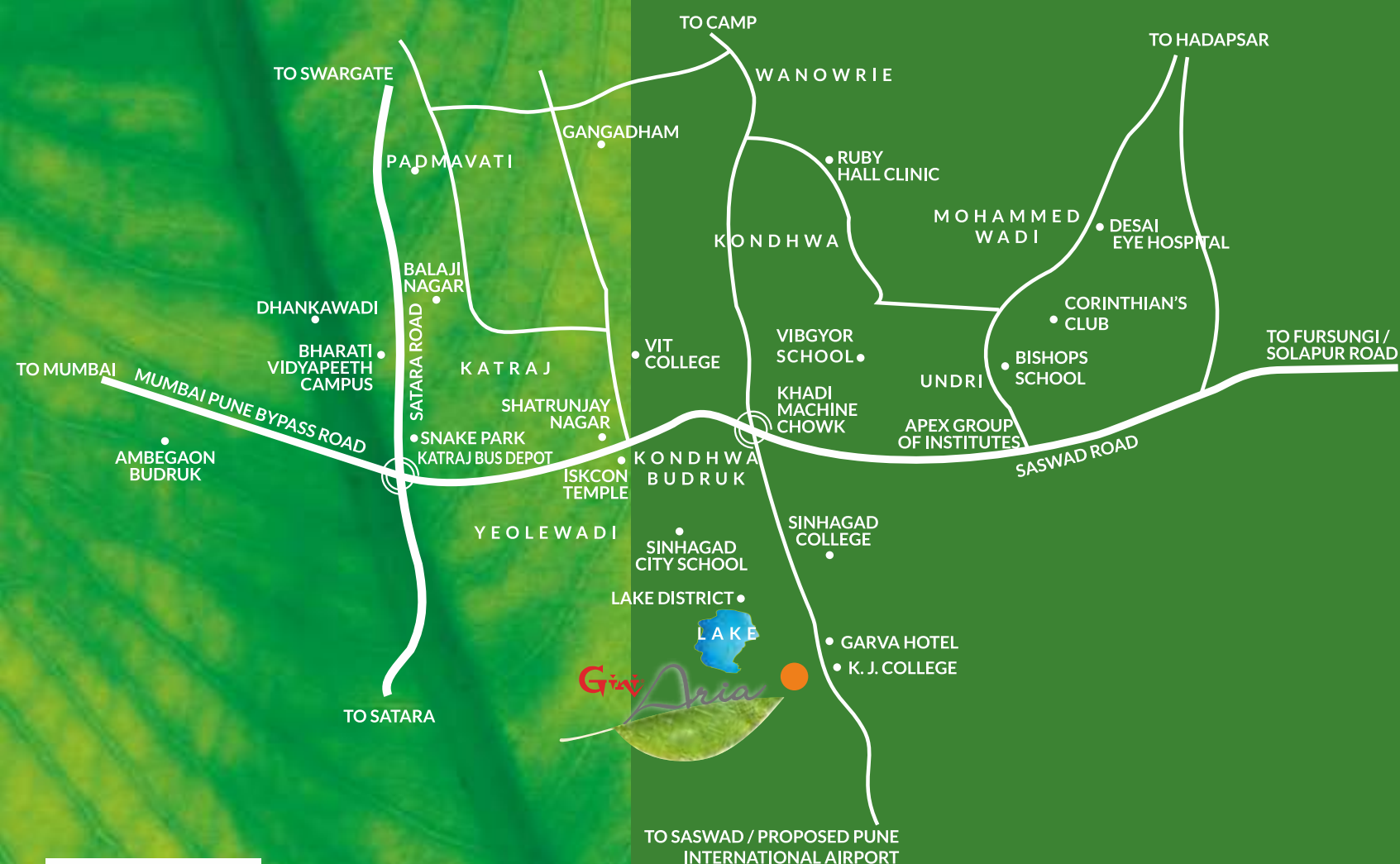

Location Map
Not to scale

SCHOOLS / COLLEGES UNIVERSITY

- Trinity College : 0.5 Km.
- Bishop School, Undri : 6.5 Km.
- RIMS International School: 7.5 Km.
- Delhi Public School: 8 Km.
- Bharti Vidyapeeth : 8.5 Km.
- Bishop School, Camp : 11 Km.
- Sinhgad College : 2 Km.

HOTEL & RESTAURANTS

- Hotel Garva: 0.1 Km.
- KFC/ Jyoti Hotel : 6.5 Km.
- Corinthians Club: 7.5 Km.
- ZK's: 7.5 Km
- Fort Jadhavgad: 27 Km.

IT PARKS

- S.P. Infocity, Fursungi: 14 Km.
- Magarpatta: 15.5 Km.
- Hinjewadi: 32.5 Km.

MALLS & ENTERTAINMENT

- D Mart Kondhwa: 4 Km
- Konark E-square: 5.5 Km.
- More Super Market, Kondhwa: 5.5 Km.
- Dorabjee Mall: 6.5 Km.
- Trendz Furniture: 5 Km.

HOSPITALS:

- Satyanand Hospital (Opp. Konark): 6 Km.
- Inamdar Hospital: 6.5 Km.
- Bharti Vidyapeeth Hospital (Medical College): 8.5 Km.
- Desai Hospital: 8.5 Km.
- Military Hospital: 8.5 Km.
- Ruby Hall Clinic (Wanjowrie): 9 Km.



GINI CONSTRUCTION PVT. LTD.

At Gini, we believe that the place of a true market leader lies in the hearts of satisfied customers. For us, excellence is achieved by competing with ourselves and by a complete dedication to our customers. It is this belief of ours, that has driven us to consistently deliver projects that are of superlative quality in every aspect.

Within 10 years, since we entered the real estate sector of Pune City in 2007, we have been able to create a legacy of innovative and futuristic landmarks. Since then we have built over 1 million sq ft of residential and commercial spaces in Mumbai, Ahmedabad and Pune. However, what gives us our biggest sense of pride is our relationship with the 1000+ happy families and many more satisfied customers. It is their happiness and support that motivates us to conquer new heights and achieve new milestones.



2007: GINI SANSKRUTI @ HADAPSAR

The place which encompasses the native and traditional architecture with a blend of nature. It's an integrated residential complex of 2BHK & 3BHK apartments adding up to 384 units.



2009: GINI BELLISSIMO @ DHANORI

A residential project spread across five acres, embracing the modern comforts. The complex has 2BHK & 2½ BHK Apartments and Penthouses adding up to 276 units.



SHOPS & OFFICES AT LOHEGAON

2011: GINI BELLINA @ LOHEGAON

Elegantly crafted apartments equipped with modern amenities and impressive features make a perfect dream home. The complex has spacious and airy 1 ½, 2 and 2 ½ BHK apartments adding up to 188 units.



2012: GINI VIVIANA @ BALEWADI

'Viviana' in Italian means vibrant and full of life. The complex houses 6 towers having spacious 2BHK, 2 ½ BHK & 3BHK apartments adding up to 226 units.



2012: Gini Lake Gardenz @ Ahmedabad

A luxurious residential complex of 3 BHK apartments and penthouses. The complex consists of four towers of 12 stories each, adding up to 88 units.



2014: Harlalka Heights @ Mumbai

A luxurious 16 Stories tower, adding up to 33 units.



- A PROJECT BY -
GINI CONSTRUCTION PVT. LTD.

SITE ADDRESS

Gini Aria, Survey no. 16/2/2A/1, Bopdeo Ghat Road (Saswad Road), Opp. K. J. College of Engineering, Yeolewadi, Pune - 411048

ADMIN OFFICE

3E, Gulmohar Apartment, 1st Floor, C - wing, 2420 East Street, Camp Pune - 411001.

CORPORATE OFFICE

421 Jogani Indl. Premises, J.R. Boricha Road, Off N.M. Joshi Marg, Lower Parel (E), Mumbai 400 011

For bookings contact: **7972768696**

email: aria.sales@giniconstructions.com | www.giniconstructions.com



The project has been registered via MahaRERA Registration No. P52100054760
& is available on the website <https://maharera.mahaonline.gov.in> under registered projects.

