



2BHK HAPPY HOMES
@Ambegaon(BK)

प्रगतीचं अंगण

श्री व्यंकटेश बिल्डकॉन

सादर करीत आहे तुमच्या परिवाराच्या उज्ज्वल भवितव्यासाठी
प्रगतीचं अंगण देणारा एक भव्य गृहप्रकल्प,
जिथे तुम्ही तुमच्या प्रियजनांसह अनुभवू शकाल **एक अभिरूचीसंपन्न जीवनशैली.**

आनंदमयी - आंबेगावातल्या प्राईम लोकेशनवर ९२ फ्लॅट्सचा गृहप्रकल्प!



संस्कृतीचं कोंदण

आनंदमयी

म्हणजे प्रगती, विश्वास अन् संस्कृतीचं देणं लाभलेलं सर्वांगसुंदर घर!
ज्यात व्यंकटेश बिल्डकॉनचे दर्जेदार बांधकाम व आधुनिक तंत्रज्ञान तर आहेच
शिवाय इंच-न्-इंच जागेचा योग्य वापर करून सांस्कृतिकदृष्ट्या परिपूर्ण डिझाईनसुद्धा आहे.
वास्तुशास्त्र आणि पर्यावरणाचा समतोल तर आहेच,
सोबत शहर आणि मुख्य रस्त्यासोबत कनेक्टीव्हिटीसुद्धा आहे.



विश्वासाचं बंधन

आनंदमयी फक्त गृहप्रकल्प नाही तर नव्या युगाची नवी जीवनशैली.
नव्या पिढीच्या विचारांसोबत त्यांना जोडणाऱ्या १० हून अधिक विलोभनीय सुखसुविधा
ज्या संपूर्ण परिवाराला चिरंतन विश्वासाच्या बंधनात बांधून ठेवतील...
आनंदमयी जीवन बहाल करतील आणि बजेट असे की तुम्ही म्हणाल "याहून सुंदर काय असावे!"



आनंदमयी - आंबेगावातल्या
प्राईम लोकेशनवर ९२ फ्लॅट्सचा
गृहप्रकल्प!



आनंदमयी ...
नव्या युगाची नवी जीवनशैली.

MASTER LAYOUT



KEYS:

- 1. PERGOLA
- 2. PATHWAY
- 3. PARTY LAWN (ARTIFICIAL)
- 4. STAGE
- 5. FEATURE WALL
- 6. KIDS PLAY AREA (RUBBER FLOORING)

- 7. SEATING
- 8. SENIOR CITIZEN SITOUT
- 9. YOGA AND MEDITATION HALL
- 10. SOCIETY OFFICE
- 11. INDOOR GYM
- 12. INDOOR GAMES ZONE
- 13. MULTIPURPOSE HALL



૧૦ હૂન અધિક વિલોભનીય સુખસુવિધા

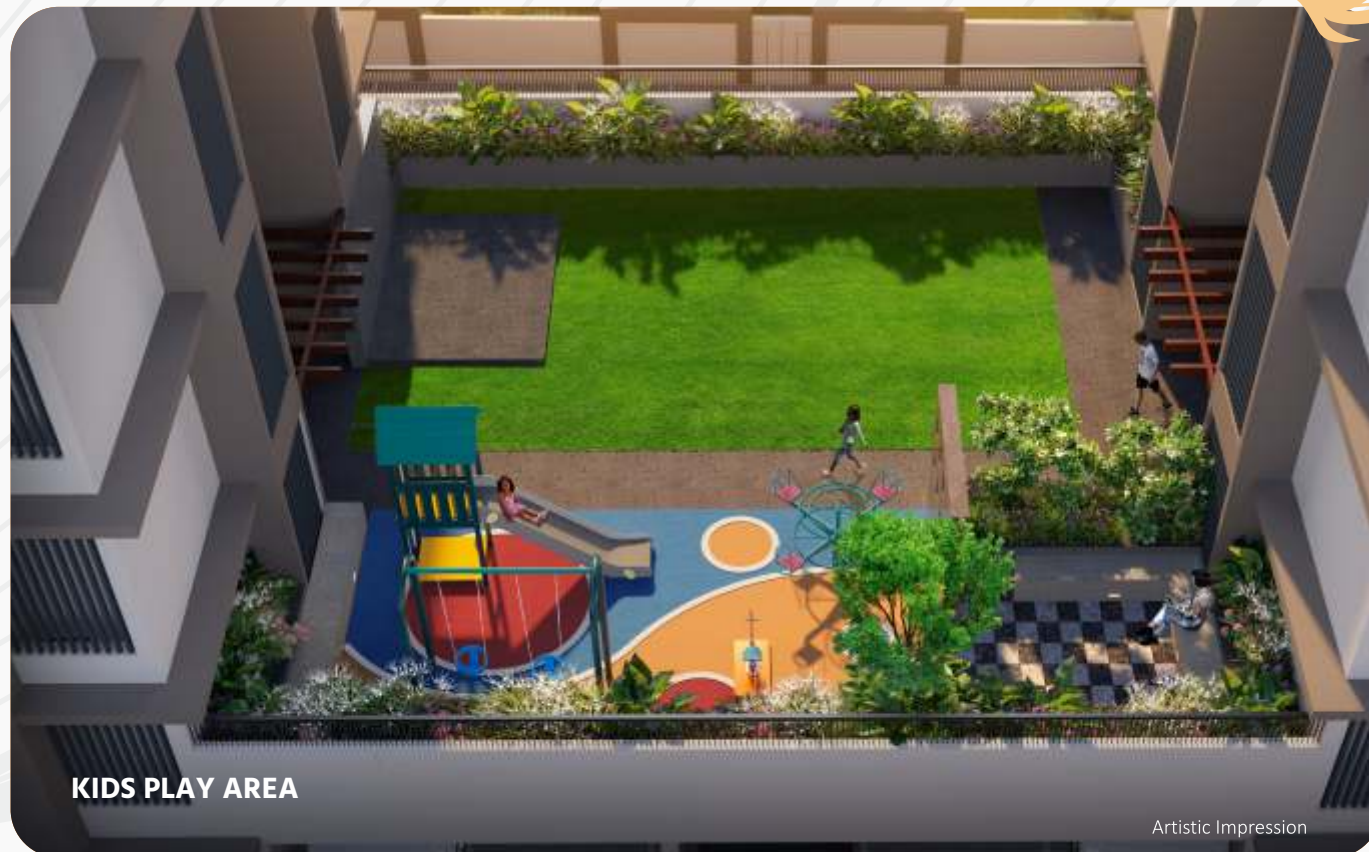

વિલોભનીય સુખસુવિધા

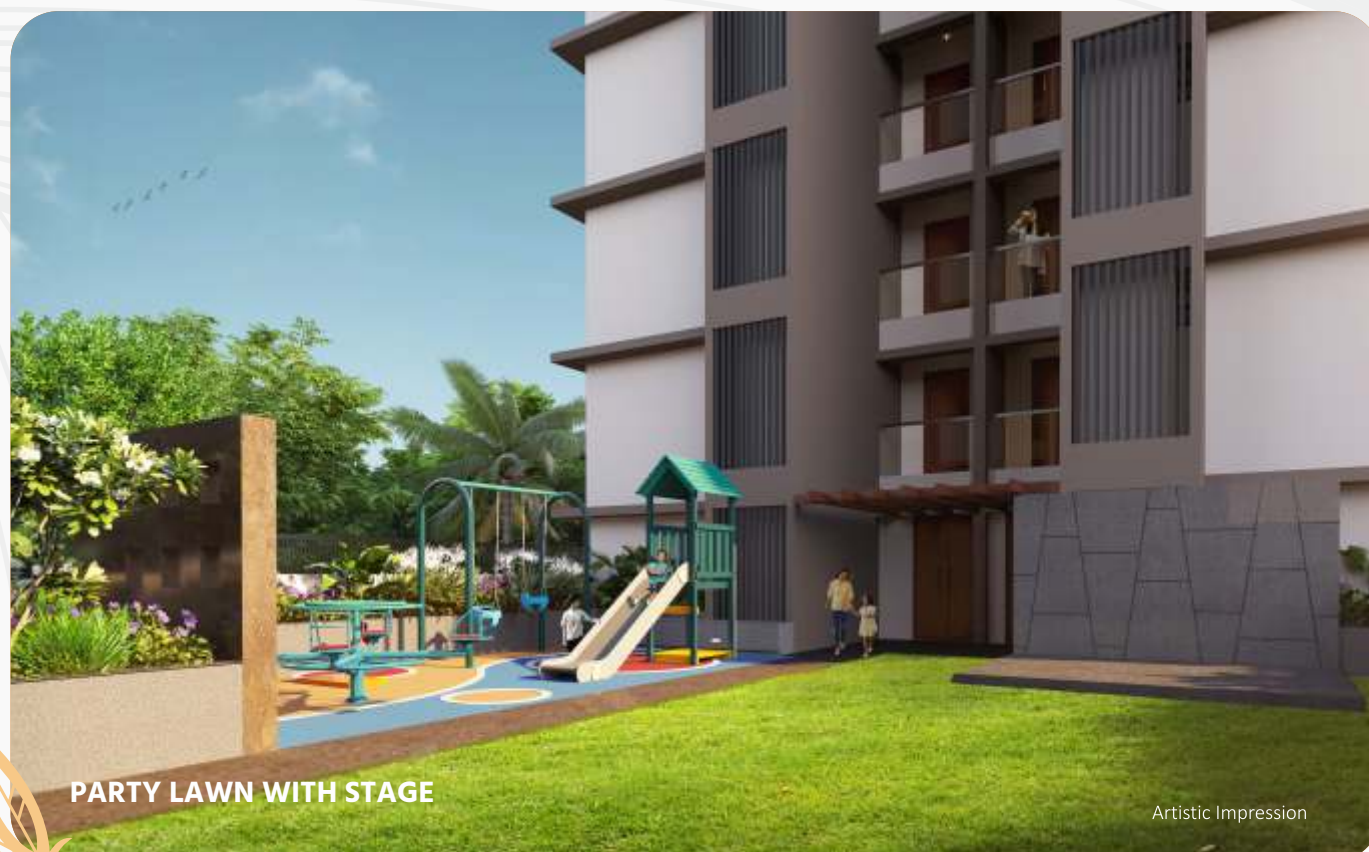

विलोभनीय सुखसुविधा



Amenities

- | | | | |
|--|--------------------------|--|--|
| | INDOOR GYM | | WELL DESIGNED ENTRANCE GATE |
| | YOGA AND MEDITATION HALL | | ELEGANT COMPOUND WALL |
| | MULTIPURPOSE HALL | | GENERATOR BACKUP FOR LIFT AND COMMON AREAS |
| | INDOOR GAMES ZONE | | RAIN WATER HARVESTING SYSTEM |
| | PARTY LAWN WITH STAGE | | SEWAGE TREATMENT PLANT (STP) |
| | KIDS PLAY AREA | | OWC PLANT |
| | SEATING AREA | | FIRE FIGHTING SYSTEM |
| | SENIOR CITIZEN SEATING | | |



SPECIFICATIONS

RCC CONSTRUCTION

- Designed as per Earthquake Resistance Norms.
- External 6" & Internal 5" walls of AAC (Autoclaved Aerated Concrete) Blocks.
- Gypsum Finish for Internal Walls & Sand Faced Plaster for External Walls.

DOORS & WINDOWS

- Wooden Door Frame to Main Door having Laminated Shutters with quality fittings.
- Aluminium Sliding Shutter with Mosquito Net for Balcony attached to Living Room.
- Aluminium Sliding Windows with Mosquito Net & MS Safety Grills.
- Granite Jams and Sills to Windows.
- Glass Railings for attached Balcony in Living.

FLOORING

- Vitrified Tiles of 600mm x 600mm for the entire flat with matching Skirting & 600 mm x 600mm Anti-skid Ceramic tiles for Common Passage & Lobbies.
- Designer Anti-skid Ceramic tiles for Balcony.
- Checkered tiles/Trimix Concrete in Parking area.
- Designer Dado up to 3'0" for Dry Balcony.

KITCHEN

- Granite Platform with Stainless Steel Sink.
- Glazed Tiles Dado up to Lintel level.
- Provision for Water Purifier.
- Provision for Exhaust Fan.

TOILET

- Designer Anti-skid Ceramic Flooring and Dado up to Lintel level.
- Provision for Geyser in Toilet.
- Provision for Exhaust Fan in Toilet.

ELECTRICAL

- Modular Electrical Switches with Concealed Copper Wiring.
- TV and Telephone Points in Living Room.
- Provision of Cable TV in Living Room.
- Video Door Phone with Intercom Facility.

PLUMBING & SANITATION

- Internal Concealed CPVC Plumbing with Jaquar or Equivalent.
- Sanitary Fitting of Cera or Equivalent Make.

PAINTING

- Internal Walls finished with Tractor Emulsion Paint.
- MS Grills finished with Oil Paint.
- External Walls finished with Superior Quality Apex Paint.

LIFT

- Two Lifts (Kone/OTIS/Schindler) for each building with Diesel Generator Power Back-up having capacity to carry 8 persons /10 persons.

FIRE FIGHTING SYSTEM

- Fire Fighting System for each building as approved by Fire Fighting Department of Pune Municipal Corporation and shall be maintained by the society.

WATER SOURCES

- Borewell
- P.M.C. / Local Authority
- Water Tanker (Chargeable)

2 BHK Cut Section



2 BHK Cut Section



Type 1 - 690 Sq.Ft. (Carpet Area)



Type 2 - 721 Sq.Ft. (Carpet Area)

आनंदमयी ...
एक अभिरुचीसंपन्न जीवनशैली.



LOCATION MAP

Connectivity

- Swargate Bus Depot - 9.4 KM
- Katraj Bus Depot - 5.9 KM
- Pune Railway Station - 13.9 KM
- Pune International Airport - 20.6 KM



Key Distances From Project:

Hospital	Bank	Schools & Collages	Malls & Multiplexes
• Navale Hospital	• Bank Of India	• Sinhgad Campus	• Fun Time Multiplex
• Sharad Hospital	• Bank of Maharashtra	• Podar International School	• Abhiruchi Mall
• Bharti Hospital	• ICICI Bank	• Orchid International School	• D-Mart
• Deenanath Mangeshkar Hospital			

आनंदमयी ...
संस्कृतीचं कोंदण



Artistic Impression

About Venkatesh Buildcon

SINCE **2000**
DELIVERING EXCELLENCE

5500+
HAPPY FAMILIES

6.5 MILLION
SQ. FT. AREA DEVELOPED

7.5 MILLION
SQ. FT. AREA DEVELOPING

AWARDS & ACHIEVEMENTS

- Suryadatta National Awards (2024) Excellence in uniting Maratha Entrepreneurs and the Real Estate Sector to our CMD
- Real Estate Icons of Pune (2022) by Times of India Presentation - Shree Venkatesh Buildcon Pvt. Ltd.
- Real Estate Awards (2022) by Lokmat & News 18- Certificate of Appreciation Presented to our CMD
- Top Trusted Brand (2021) by Pune Times Mirror to our Company - Shree Venkatesh Buildcon Pvt. Ltd.
- Promising Real Estate Developer (2021) by Times of India - Inspiring Men and Women of the Year to our CMD
- India's Leading Brand - Rising Star" (2021) by Fortune India Exchange
- Business Leader of the Year (2020) by Pride of Maharashtra SME (MIEDA) to our CMD
- Times Men of the Year (2020), West India by Times of India to our CMD
- Achievers of Maharashtra (2020) by Sakal Media Group to our CMD
- Icon of the Year (2019) by Sakal Premier Awards to our CMD



COMPLETED PROJECTS



1, 2 & 3 BHK (667 Flats & 6 Shops)
Ambegaon Khurd, Pune



2 & 3 BHK (256 Flats & 6 Shops)
Dhayari, Pune



2 & 3 BHK (186 Flats)
Dhayari, Pune



1 & 2 BHK (121 Flats & 6 Shops)
Ambegaon Khurd, Pune



1 & 2 BHK (174 Flats)
Ambegaon Khurd, Pune



2 BHK (377 Flats)
Keshavnagar, Pune



1, 2 & 3 BHK (968 Flats, 6 Shops & 22 Offices)
Keshavnagar, Mundhawa, Pune



1, 2 & 3 BHK (340 Flats & 8 Shops)
Loni Kalbhor, Pune



2 BHK (237 Flats)
Keshavnagar, Mundhwa, Pune

ONGOING PROJECTS



2, 3, 4 & 5 BHK Luxury Homes
(501 Flats, 20 Shops & 23 Offices)
Beside Rajaram Bridge, Sinhagad Road, Pune



2 & 3 BHK (87 Flats)
Bhusari Colony, Kothrud, Pune



2, 3 & 4 BHK Superlative Homes (600 Flats)
Near Patwardhan Baug, Erandwane, Pune



2, 3 BHK & 4 BHK Duplexes
(389 Flats, 3 Showrooms & 120 Offices)
Pimple Nilakh, Pune



Showrooms and Office Spaces
@ Balewadi, Pune



3 & 4 BHK Luxedoms
(172 Flats & 7 Showrooms)
Shivajinagar, Pune

UPCOMING PROJECTS

Vadgaon (bk)

Sinhagad Road

Ambegaon

Baner

Prabhat Road

A Project By:

VENKATESH BUILDCON

BY ANKUSH ASABE

CREDITS

Architect
**C'metric Designers &
Consulting Engineers**

Legal Advisor
Adv. Unmesh Deshpande

Landscape Designer
**Mr. Mahesh &
Mrs. Vaishali Chinchalkar**

Site Address: 9/2/3A P, 9/2/3A/3, 9/2/3A/4, 9/2/3A/5, 9/2/3A/6, 9/2/3A/7, 9/2/3A/8, 9/2/3B P
Adjacent to Sinhagad College, Ambegaon Budruk, Pune - 411046
Contact : **7420941097, 86055 22333** | Email: **sales@svbpl.in**

Corporate Office: 7th Floor, Vikram Monarch, Plot No. 490 A/1, Ganeshkhind Road,
Shivajinagar Bhamburda, Pune 411 016.
Contact: **020 25662397, 020 25667112** | **www.venkateshbuidcon.com** | **www.svbpl.in**



MahaRERA No.: P52100055046
<http://maharera.mahaonline.gov.in>

MEMBER:



CREDAI
PUNE METRO

Disclaimer: This brochure is purely conceptual and not a legal offering nor will be part of the agreement. Images shown are for representation purpose only. Number of floors and number of units may be revised. Developer reserves the rights to amend the layout, plans, elevation, colour schemes, specifications, amenities, etc. without any prior notice.