



Lekh Residency

Premium 2 Bedroom
Living Spaces

A boutique development
offering urban living



LEKH GROUP OF COMPANIES
Tradition of Trust

IN ASSOCIATION WITH
SHREE JAM HOSIERY WORKS PVT. LTD.

Project Distinctions

- Ground + 11 Storied Building
- Bright, Breezy, Spacious Abodes
- Multiple Terrace Amenities



Proposed Elevation

Thoughtfully Curated Bespoke Living

- Premium quality vitrified tiles
- Finest quality granite kitchen platform with designer ceramic wall tiles
- Superior Bathroom fittings, stylish WC, and Wash Basins
- Powder-coated aluminum sliding windows & an alluring main door
- Concealed copper wiring & modular switches



Representative Image

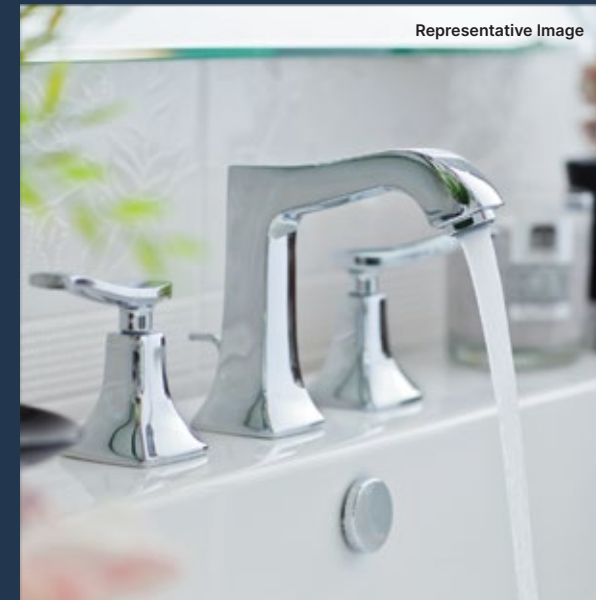

Representative Image

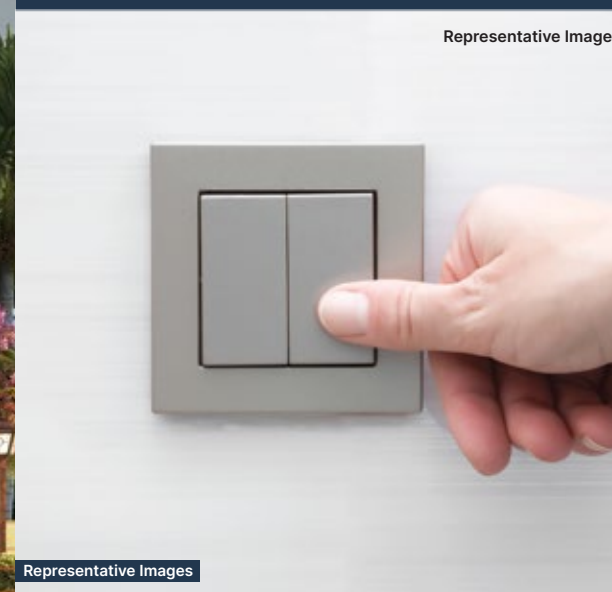

Representative Image

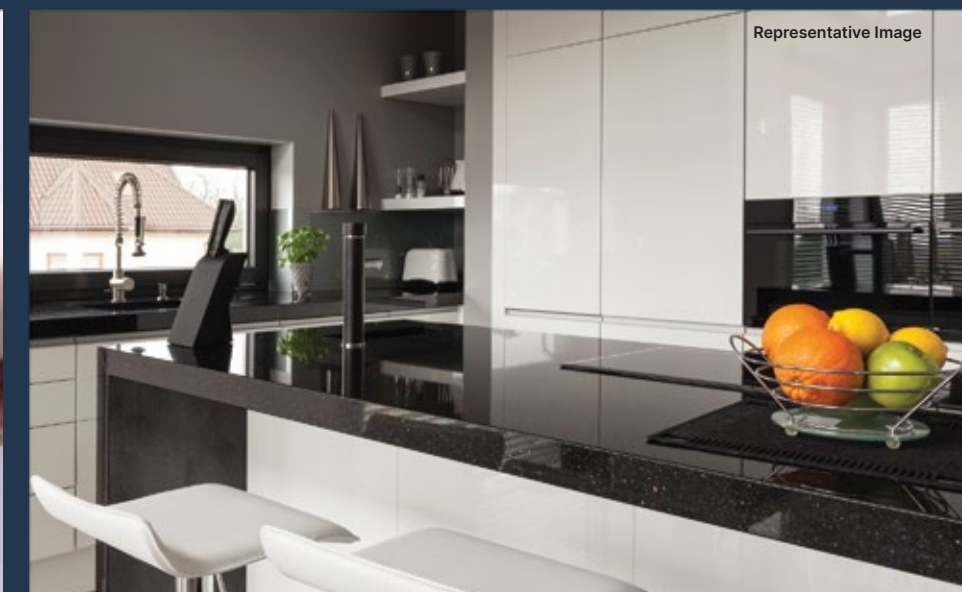

Representative Image

Representative Images

Everyday Elegance
— Redefined —



EV Charging
Provision



Rain Water
Harvesting



Vastu Compliant
Design



24*7 CCTV Security
& Power Backup

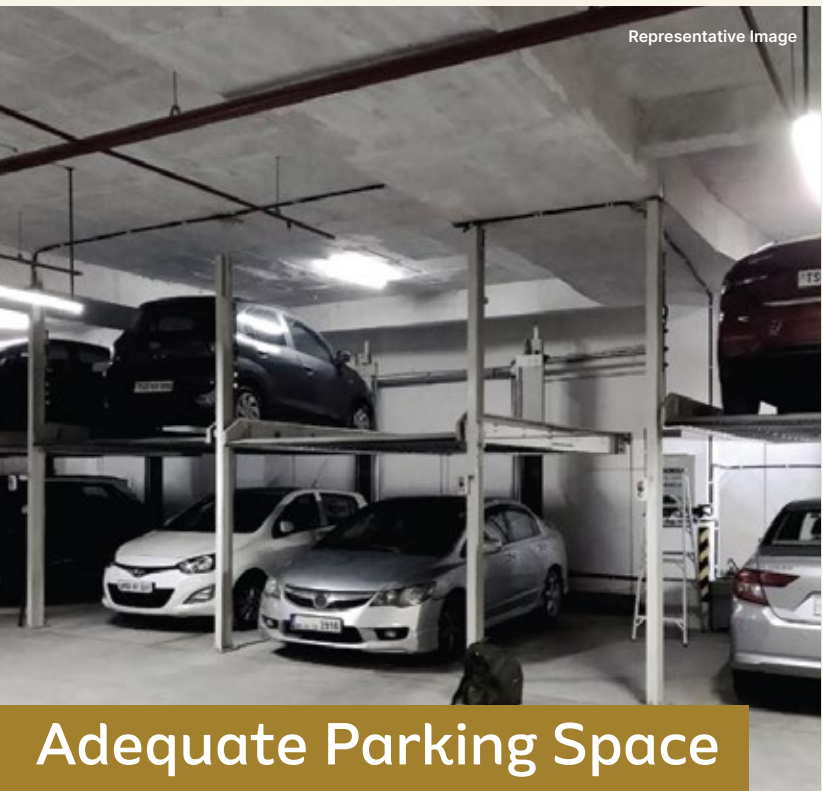

8th

Floor Plan

RERA Carpet Area

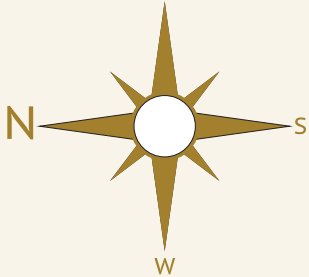

ROAD

Unit no.:	Rera Sq. Ft.
1	763 Sq. ft.
2	749 Sq. ft.
3	749 Sq. ft.
4	763 Sq. ft.

9th - 11th

Floor Plan

RERA Carpet Area

Exquisite Boutique Homes,

Exemplifying Superior Planning and Design

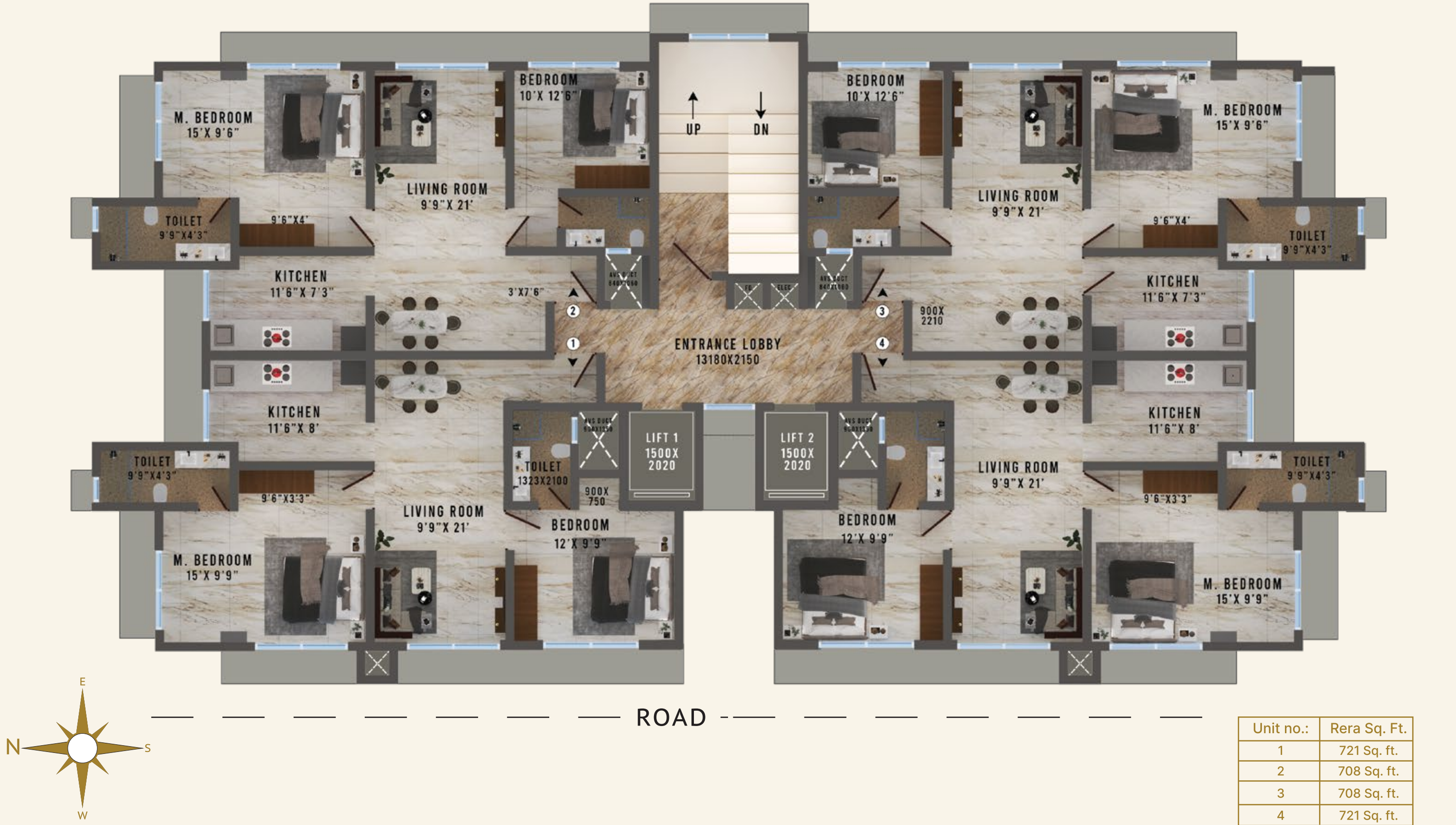

Spaces For Me Moments & We Moments



Seamless Connectivity

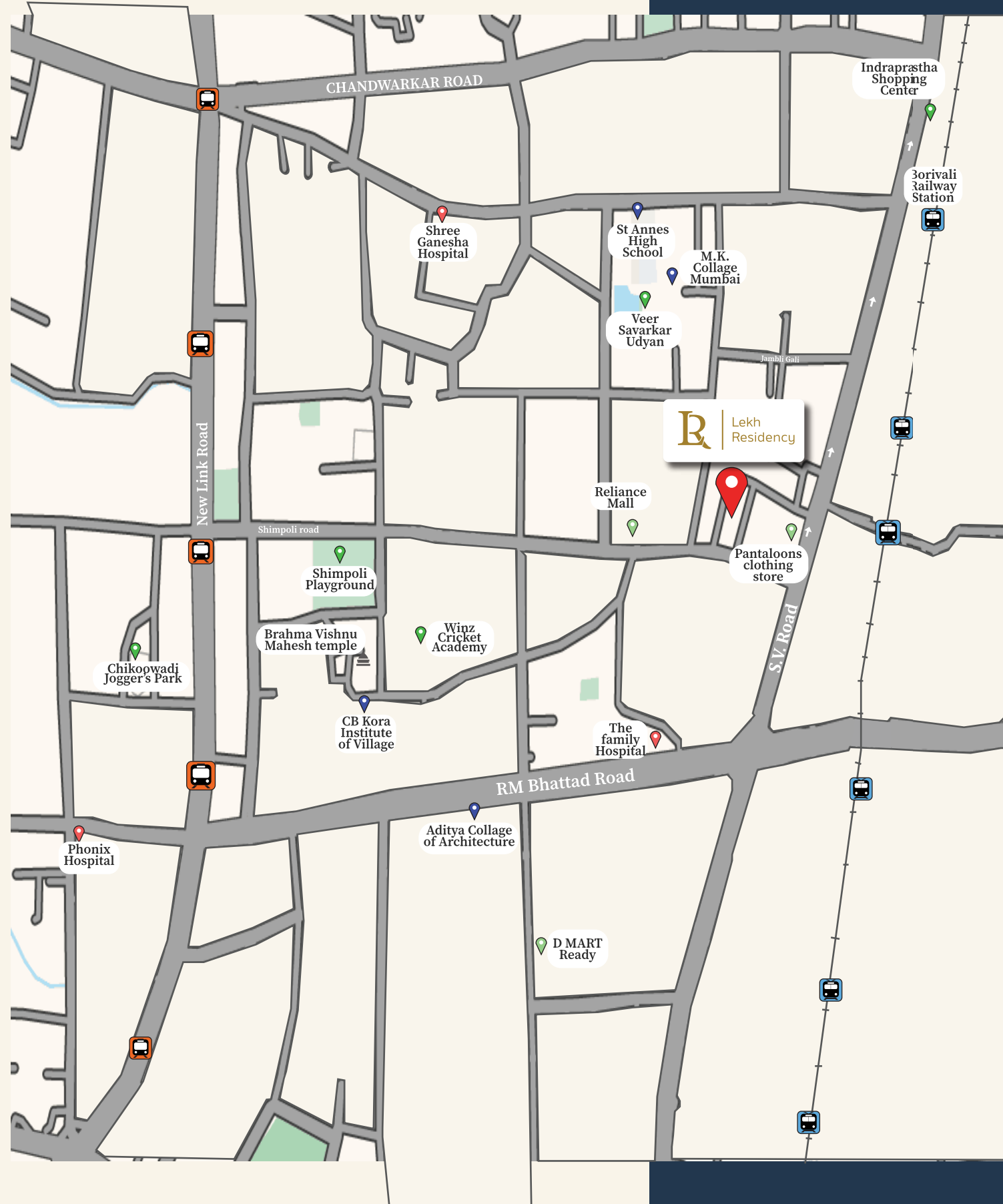

SV Road : 250 m / 1 min
Borivali Railway Station : 950 m / 3 min
Link Road : 1.2 km / 4 min
Metro Station : 2.1 km / 7 min



M K College Of Mumbai : 800 m / 3 min
St. Annes High School : 1.0 km / 4 min
Aditya College of Architecture : 1.2 km / 5 min



The Family Hospital : 800 m / 3 min
Shree Ganesha Hospital : 1.0 km / 5 min
Phoenix Hospital : 2 km / 6 min



Shri Ambaji Dham : 200 m / 1 min
Jain Derasar : 700 m / 3 min



Pantaloons : 230 m / 1 min
Reliance Mall : 550 m / 2min
Indraprastha Shopping Center: 1 km / 4 min
D-mart : 1.4 km / 5 min

About Us:

Lekh Group a Mumbai-based company that was established in 1975. The group focuses on the development of residential and commercial premises in Mumbai, Maharashtra & Saurashtra, Gujarat. The group redevelops societies, tenanted properties and procures vacant land to develop the property. The group is renowned for its experience in handling redevelopment projects with scores of projects undertaken & many more in the pipeline. We at Lekh Group are creating neighbourhoods that inspire quality living.

Our Past Associations



Meghdoot Residency
Vile Parle (East)



Radhe Krishna
Andheri (East)



Datta Niwas
Vile Parle (East)

A Project By:



LEKH GROUP OF COMPANIES
Tradition of Trust

Architects : Kapadia Consultants / Shri Ravindra Kapadia
Structural Consultants : Pravin Gala & Consultants Pvt Ltd / Mr Niyant Gala
Legal Advisor: I C Legal / Adv Bharat Jain
Project Co - Ordinators: Mr Jay D Rajda | Mr Hiten J Pabari

Site Address: Sales Lounge, Lekh Residency, FP No. 56, Shimpoli Cross Road No. 2, Off Shimpoli Road, Borivali (West), Mumbai - 400092

Office Address: Lekh Realty, 1st Floor, 2/4, Rajda Building, Old Hanuman 2nd Cross Lane, Dhirubhai Parikh Marg, Mumbai - 400002, India

MahaRERA Registration No: P51800052889 available at website: <https://maharera.mahaonline.gov.in/>

DISCLAIMER: This Advertisement/printed material does not constitute an offer or contract of any nature whatsoever between the promoters and the recipient. All transactions in this development shall be subject to and governed by the terms & conditions of the agreement for sale to be entered into between the parties. All internal dimensions for the carpet area are from unfinished wall surfaces. Minor variations up to (+/-) 3% in actual carpet areas may occur on account of site conditions/columns/finishes etc. In toilets, the carpet areas are inclusive of ledge walls (if any). Conversion: 1 sq. Mtr. = 10.764 sq. ft. 1 meter = 3.28 feet. This project is registered under the name Lekh Residency. *T&C Apply.

