

A PROJECT BY:



Swastik™
BUILDERS & DEVELOPERS



aasara
PROPERTIES

"PRISM CITY"

Sr. No. 502, 503, 504, Ganpatrao Kalaje Mala,
Airport Road, Charholi BK, Pune- 412105
E-mail : sales@prismcity.in | www.prismcity.in



Scan QR Code To
Download E-Brochure



MAHARERA Reg. No. Green: P52100053211
maharera.mahaonline.gov.in



Scan QR Code to Visit
Prism City Location



Contact: +91 777 000 4044 / 46

**4 BHK & 3 BHK ULTRA-LUXURIOUS HOMES
@ CHARHOLI, PCMC**

Note: The Promoter reserves the rights to utilize any increase in F.S.I. / T.D.R. / D.R. / F.A.R. / Paid F.S.I. that will be sanctioned in its building plans by PCMC or any concerned authority which will be used to the benefit of the Promoter during or after construction of the building mentioned in this brochure. The project images used in the brochure are computer rendered graphics intended for representational purposes only and should not be construed as any promise by the Developer. The brochure is purely conceptual and not a legal offering. All Visuals, Photographs & Views used in this brochure are artist's impression. Architect/Developers shall have right to change or revise the scheme or any details herein & any such changes or revision will be binding to all. The Developer reserves the right to amend the layout, parking layouts, plans, colour schemes, elevations, specifications and amenities. Please note Enclosed Balcony is vary flat to flat refer Blue Print.

www.brandbandmedia.com



PRISM CITY



G

Garden flats
at ground floor



R

Rooftop
Amenities



E

Elite
Lifestyle



E

Extra Large
Homes



N

No Vehicle Zone
On Ground Floor



One in a Million
Experience!

Truly exceptional! Prism City, Green's 4 BHK & 3 BHK ultra-luxurious homes at Charholi redefine opulence and offer an unparalleled living experience. From sprawling apartments nestling amidst lush greenery to sleek modern amenities with breath-taking city views, Prism City represents architectural brilliance and exquisite design.



The epitome of
**Opulence &
Extravagance Awaits**

Step into Prism City, Green, and you will indulge in homes that reflect majesty and luxury. 4 BHK & 3 BHK ultra-luxurious homes of Prism City, Green, are masterpieces & designed to enhance your aesthetics and elevate your living experience. A sense of awe washes over you as you immerse yourself in the lavish surroundings. Every detail is thoughtfully curated to create an ambiance of unparalleled elegance. In Prism City, Green, every aspect of life is to complete your desire for the extraordinary.



luxury
homes

spacious



Drowning in Coziness & Brimming With Spaciousness

The largest 4 BHK & 3 BHK homes ensure an unparalleled lifestyle experience, encouraging you to create a paradise that embodies your home aesthetics. With 4 BHK & 3 BHK spacious homes for all your belongings, you'll never have to worry about messy or confined living spaces. Our homes define what it means to live spaciously. Revel in the luxury of high-end finishes and premium furnishings that enrich your everyday living experience. Say goodbye to compromise and hello to a lifestyle that offers the most spaciousness.



PRISM CITY GREEN



Elevate Your Lifestyle

To The World Above

Prism City, Green's exclusive rooftop amenities, represents the concept of luxury living. Upgrade your lifestyle to heights with these offerings, which provide an unmatched experience. A stylishly arranged rooftop area offers spectacular panoramic views of the city skyline, creating an ideal setting for socializing with friends or enjoying a romantic evening under the stars. Prism City, Green's rooftop amenities embrace luxury living by providing a superior experience that combines comfort, style, and convenience.



Your Gateway To The Desirable Lifestyle

With its impeccable urban planning and thoughtful design, Prism City, Green offers an array of amenities that serve as a gateway to a desirable lifestyle. The beautifully landscaped gardens provide serene spaces for relaxation and rejuvenation. The fitness centre is equipped with top-of-the-line equipment, catering to health-conscious individuals who seek an active lifestyle. The vibrant community centre hosts social events and gatherings, fostering a strong sense of belonging among neighbours. With its commitment to enhancing the quality of life, Prism City, Green's amenities truly elevate the living experience and pave the way for a desirable lifestyle.

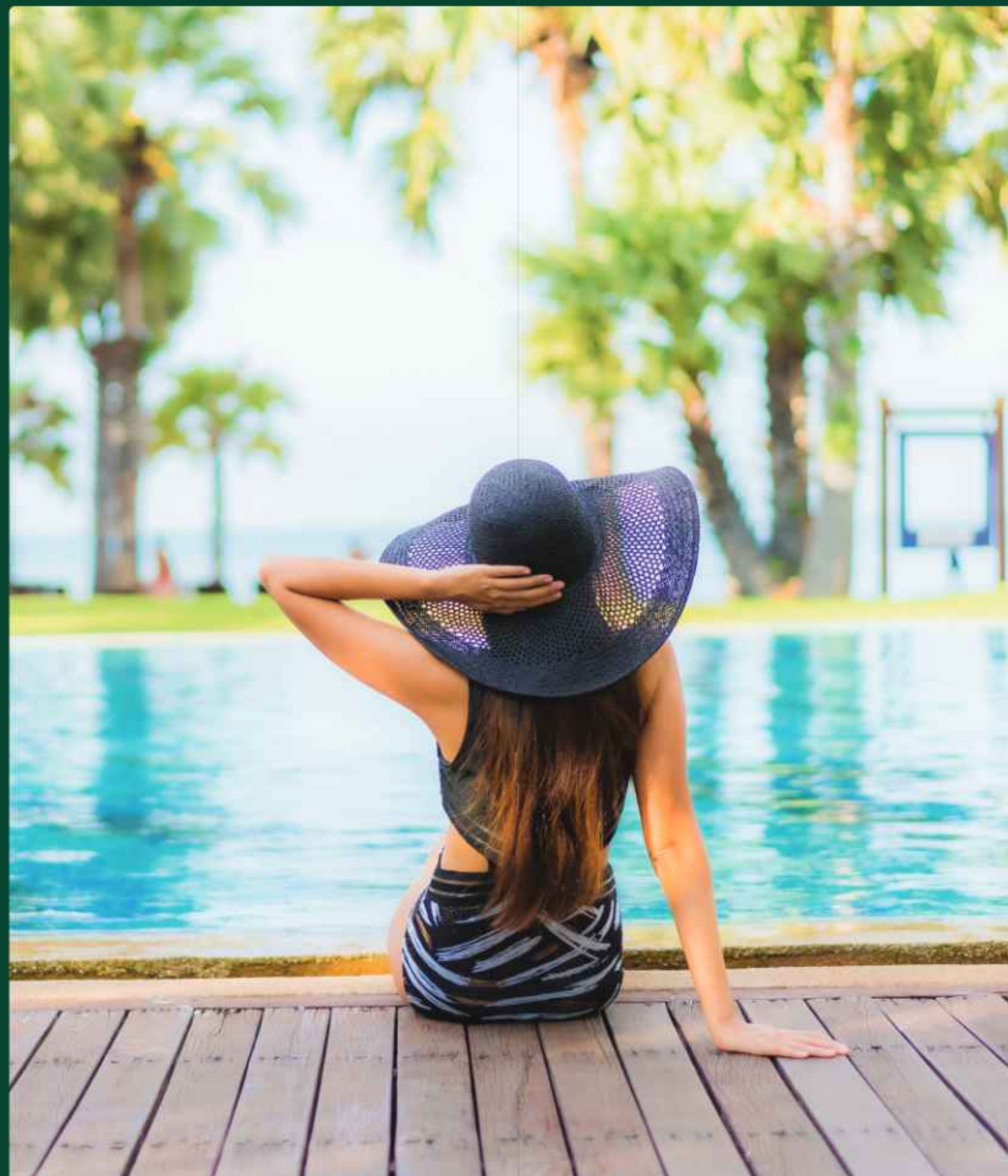

Entry:

- Attractive entrance gate with security cabin
- Attractive & Designer entrance lobby
- Attractive nameplate on main door & at entrance lobby



Internal Roads:

- Internal roads with trimix/block finish
- Streetlights with LED/CFL fittings
- Trimix/Chequered tiles in a covered parking area



Common Amenities:

- Generator back - up for common lighting & pumps
- Fire fighting system
- Energy-efficient common lighting



Security:

- 24x7 security
- CCTV surveillance cameras at the main gate & Common Areas



Environmental Responsibility:

- Rainwater harvesting
- Solar water in Master Toilet
- Tree Plantation



Garden:

- Beautifully designed landscape garden
- Kid's play area with play equipment's
- Sit-out for senior citizens
- Flag hoisting & party deck with waterfall
- Gazebo
- Jogging track
- Multi-purpose court
- Bonfire area
- Yoga Deck
- Provision for cafeteria & barbeque counter with sit out
- Flower bed with sit out
- Fully equipped A/C gym
- Open Gym
- Swimming Pool

amenities



Embrace The Fully Relaxed Lifestyle

Prism City, Green offers carefully designed 4 BHK & 3 BHK ultra-luxurious homes to embody beauty and comfort. Step into a world where relaxation is paramount and embrace the essence of tranquillity that permeates every corner. With a focus on quality expertise and attention to detail, we have created an oasis where you can live a fully relaxed life. Discover the world of elegance and comfort at Prism City Green, your gateway to a life of pure bliss.



Structure:

- Attractive main door with wooden frame.
- External plaster will be sand-finished and internal walls will be gypsum finished.

Flooring:

- 4X6 Vitrified tiles in all rooms with skirting.
- Anti-skid tiles for all attached balconies & bathrooms.

Bathroom & Toilet:

- Dado up to lintel level in all bathrooms.
- Diverter with concealed plumbing.
- Premium range exhaust fan.
- CP & sanitary fittings of premium range.
- False ceilings in all bathrooms with lights.

Kitchen:

- Granite top kitchen platform with stainless steel sink and designer tiles up to 2' Ft. level.

Electrical:

- Concealed wiring with standard ISI makes wires and branded switches with sufficient electric points.
- Provision for AC point in all bedrooms and living room.

Doors & Windows:

- Main Door - Decorative both side laminated flush doors.
- Internal Doors- Laminated flush doors.
- Toilet Doors - Fibre Reinforced plastic / laminated flush doors.
- Door eye on the main door.
- Three track sliding doors with mosquito net for Living balcony & windows.
- Digital lock on Main door.
- Full Glass partition with windows in master bedroom.

Painting:

- Oil bond distemper paint in all rooms.
- Water-resistant paint on external walls.

specifications

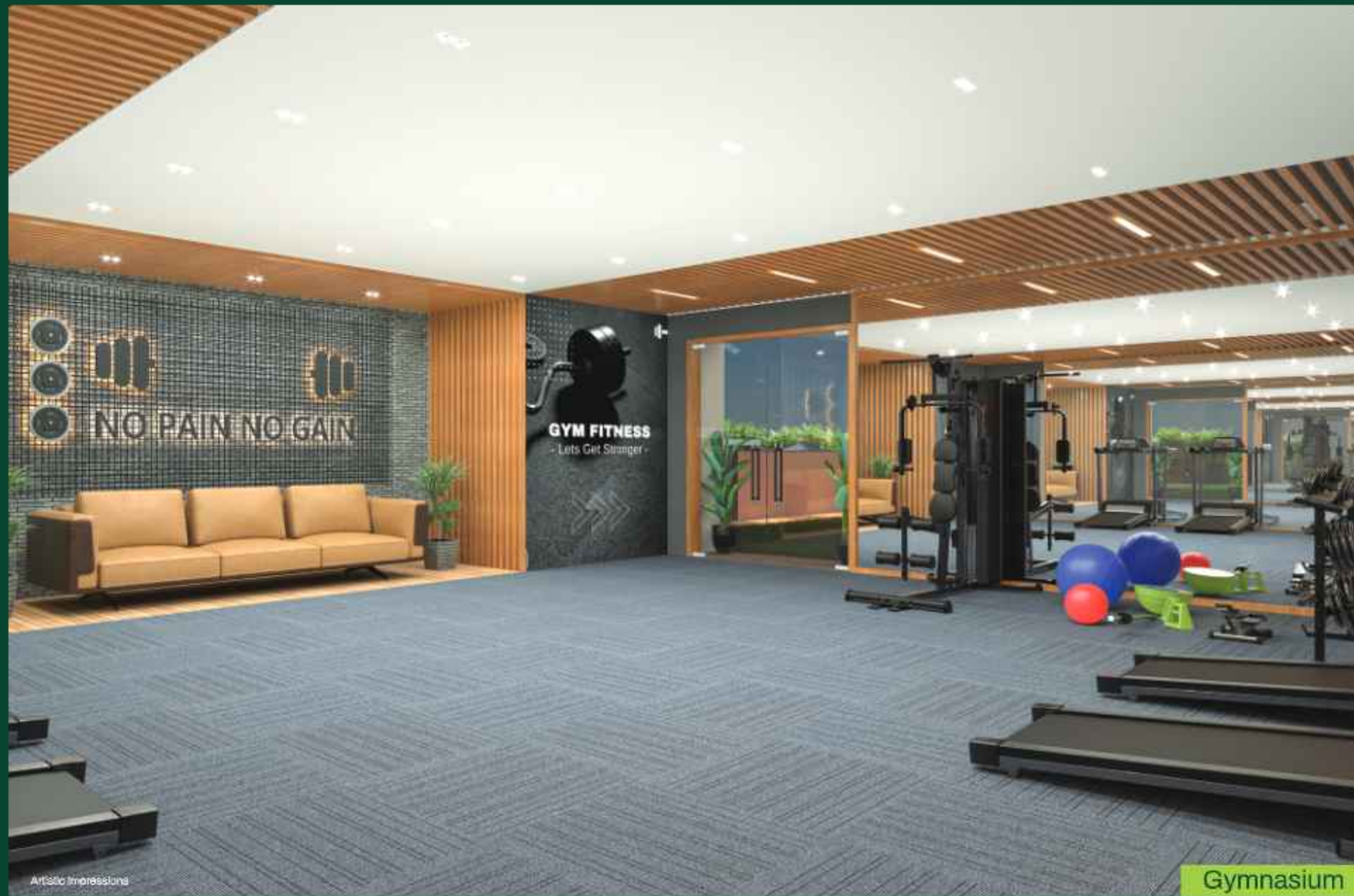

Gymnasium



Entrance Lobby



Swimming Pool

Reasons To Own Prism City

01

Walk-in
Wardrobe
Concept

02

Roof
Top
Amenities

03

Digital
Lock On
Main Door

04

Full
Window
Concept

05

Well
Planned
Layout

06

Ample
Parking
Space

07

Ground
Floor With
No Vehicle Zone

08

Separate Society
Formation For
Each Building

09

Easy
Connectivity
To Pune Airport

10

Separate
Amenities For
Each Building

11

Covered
Swimming
Pool

12

Extra
Large
Flats



Rooftop Amenities

- 1 Semi Covered Party Area
- 2 Flag Hoisting & Party Deck
- 3 Senior Citizen Sitting
- 4 Jogging Track
- 5 Yoga Deck
- 6 Sitting Area
- 7 Gymnasium
- 8 Open Gym
- 9 Multipurpose Court
- 10 Play Area
- 11 Children's Play Area
- 12 Gazebo





Gazebo



rooftop amenities

Multipurpose Court



Sitting Area



Flag Hoisting & Party Deck





Quality is The Base of Our Sustenance!

We strive to ensure that every aspect of our construction reflects the utmost quality. From the foundation to the finishing touches, we precisely select materials that meet the highest standards. Our commitment to quality is unwavering, as we understand that it is the foundation of our customers' happiness and long-term security. We take pride in delivering sturdy structures and homes that bring joy and contentment for a lifetime. By prioritizing quality, we ensure our customers can rely on us for their happiness and peace of mind.



Timely
Delivery



Quality
Construction



Good
Architecture



Happy
Customers



Fastest Selling Project of Charholi

We are proud to have received the Big Impact Award from Big FM, which acknowledges our efforts in delivering exceptional homes. Prism City has garnered immense popularity, becoming the fastest-selling project in Charholi with the largest carpet area. We remain committed to pushing boundaries and creating homes that redefine luxury living. This recognition further motivates us to continue pushing boundaries and setting new benchmarks in the construction industry.





Artistic Impressions



Garden View Homes, Ground Floor

Perfectly landscaped homes for you!

Experience the serenity of nature right at your doorstep, as Prism City Green's perfectly landscaped ground-floor garden homes offer an escape to relaxation. Begin your mornings with the gentle caress of the Sunrays. Breathe in the fragrant blooms and listen to the symphony of chirping birds. Experience the joy of gardening and watch your plants flourish under your care, nurturing and fostering precious memories of you with your family and loved ones.



Artistic Impressions

Ground Floor Plan



Typical Floor Plan

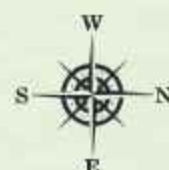
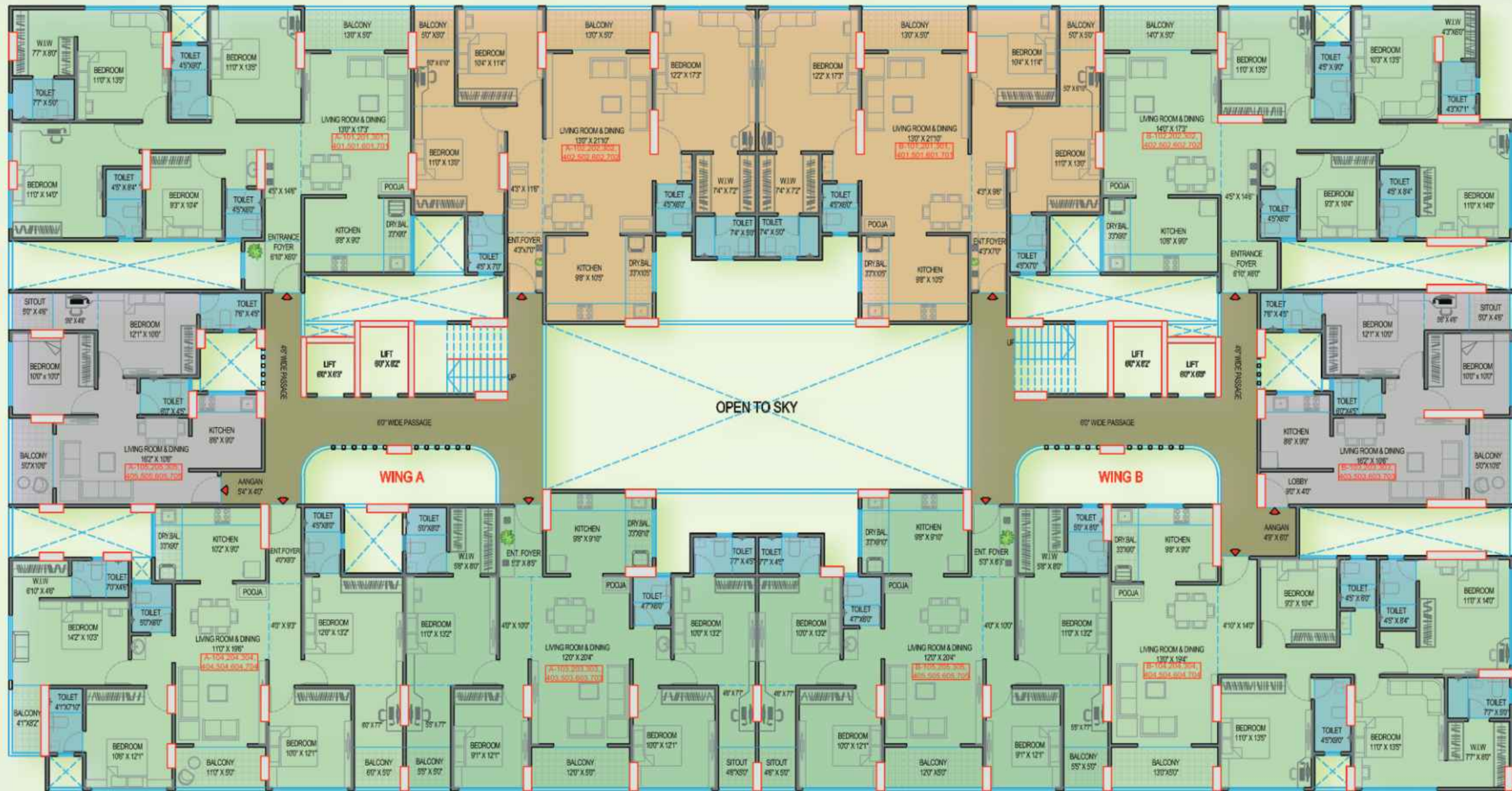

3 BHK & 4 BHK



3 BHK Carpet Area 1327 sq.ft



4 BHK Carpet Area 1426 sq.ft

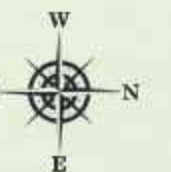
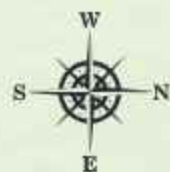

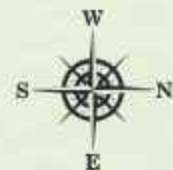

4 BHK Carpet Area 1392 sq.ft

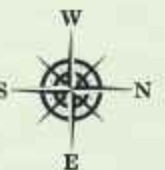

4 BHK Carpet Area 1400 sq.ft



4 BHK Carpet Area 1409 sq.ft



4 BHK Carpet Area 1400 sq.ft

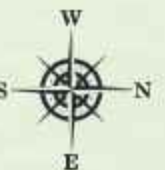
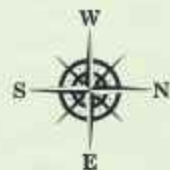



The Prism of Limitlessly Developing Future

With its strategic location and easy accessibility, Prism City offers a promising future for its people. The vibrant neighbourhood is well connected to city locations, providing seamless connectivity for both work and leisure. Situated in the suburbs of Lohegoan, Dhanori, Viman Nagar, Moshi, Dighi, and Pimple Saudagar, this progressive residential area appeals to the younger generation seeking a modern lifestyle. Charholi's infrastructure is constantly evolving, ensuring limitless opportunities for growth and development. Whether it's educational institutions, healthcare facilities, or recreational conveniences, Prism City has it all within reach. The future of Prism City shines bright with endless possibilities.



Location Advantages



IT HUBS

Yerwada (Commerzone IT Park) - 12.9Km
EON-IT Park - 16.4 Km
Kalyani Nagar - 13.5 Km
Hinjewadi IT Park - 21.9 Km
Talwade IT Park - 13.4 Km

HOSPITAL & MEDICALS

Deokar Hospital - 1.7 Km
Om Hospital - 0.3 Km
Medicals - 0.5 km
KK Care Hospital - 3.2 Km
PCMC Hospital - 9.1 Km
Rode Hospital - 2.1 Km

MIDC AREA

Bhosari MIDC - 7.0 Km
Chakan MIDC - 15.5 Km
Markal MIDC - 11.0 Km

SCHOOL & COLLEGES

Apex International School - 0.0 Km
RKL Galaxy School - 1.5 Km
Radcliffe School - 1.5 Km
D.Y. Patil School College - 6.7 Km
AIT College - 6.6 Km
MIT College - 4 Km
Kidzee School - 1 Km
Shree Wagheshwar Vidyalyaya - 2.9 Km

PLACES TO KNOW

Pune Airport - 10.0 Km
Pune Station - 20.0 Km
Shivaji Nagar - 18.9 Km
Viman Nagar - 15.7 Km
Vishrantwadi - 10.5 Km
Nashik Phata - 12.4 Km
Nagar Road - 15.7 Km
Bhosari - 6.9 Km
Big Bazaar, Vishrantwadi - 11.1 Km
Phoenix Market City - 15.8 Km

ESSENTIAL SERVICES

Petrol pump - 2.0 km
Laundry - 0.5 km
Grocery Stores - 0.5 km
Vegetable Market - 1 Km

BANKS

HDFC Bank - 2.0 Km
Union Bank - 3.5 Km
Bank of Maharashtra - 1.0 Km
ICICI Bank - 2 Km
PDCC Bank - 2 Km



Scan QR Code to Visit
Prism City Location

Location Map

