

C.No. 19966 / 25 / 2022 .

REF.NO.: 25 OF P.S., CHENNAMPALLY G.P.

T.L.P.NO. 111 / 2022 / H



CAUTION:-
THIS LAYOUT IS LEGALLY VALID ONLY ON ITS RELEASE/ APPROVAL BY THE CONCERNED GRAMPANCHAYAT UNDER SECTION 113(b) TELANGANA PANCHAYAT RAJ ACT 2018 (Act no 5 / 2018) AS COMMENCED WIDE G.O.Ms.No.22 PR & RD Dt.18-04-2018 AND UNDER RULE 11 (3)OF G.O.67 PR & RD, DT: 26-02-2002 ON FULLFILMENT OF ALL LAYOUT CONDITIONS. ANY TRANSACTIONS PRIOR TO THE ABOVE IS ILLEGAL.

CHENNAMPALLY GRAMPANCHAYAT

EXTRACT OF VILLAGE MAP

SITE U/R :

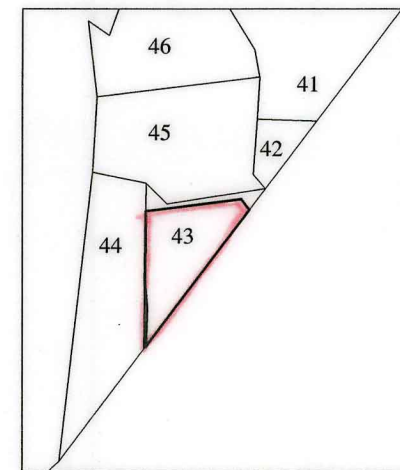

REFERENCE:

LAYOUT BOUNDARY
EXISTING ROADS
PROPOSED ROADS
MORTGAGE AREA

AREA STATEMENT:

LAYOUT AREA	Ac.7.00 CENTS.	33880.00 SQ.YDS.
SITE RESERVED FOR OPEN SPACE (PARK) (10.00%)	Ac.0.70 CENTS.	3388.00 SQ.YDS.
ROADS AREA (30.47%)	Ac. 2.133 CENTS.	10323.72 SQ.YDS.
PLOTTED AREA (59.53%)	Ac.4.167 CENTS.	20168.28 SQ.YDS.
MORTGAGE AREA (15.98%) ON PLOTTED AREA (FROM PLOT NO.'S 57 TO 66)	Ac. 0.666 CENTS.	3223.44 SQ.YDS.
NUMBER OF PLOTS	67	

CHENNAMPALLY GRAMPANCHAYAT

DRAFT TECHNICAL LAYOUT PATTERN FOR RESIDENTIAL PLOTS IN SY.No's.43/P SITUATED AT CHENNAMPALLY GRAM PANCHAYAT , AMANGAL MANDAL , RANGAREDDY DISTRICT.

SCALE :- 100 FEET TO AN INCH

11/4/2022
A.D.M.

01/04/2022
T.P.A.(i/c)

01/04/2022
DEPUTY DIRECTOR

01/4/2022
JOINT DIRECTOR

B.Arch., M.U.R.P.,A.I.T.P.
DIRECTOR OF TOWN & COUNTRY PLANNING
GOVT. OF TELANGANA, HYDERABAD