

B- BUILDING (TOWER456)													
Floor Name	Gross Built Area (Sq.ft)	Deductions From Gross BUA/Area (Sq.ft)	Total Built Up Area (Sq.ft)	Deductions (Area in Sq. ft.)						Proposed FRR Area (Sq.ft)	Total FRR Area (Sq.ft)	Tmt (No.)	Carpet Area other than Treatment
				StarCase	Lift	Lift Machine	Void	Parking	Rest.				
Floor Terrace	221.01	0.00	221.01	115.00	0.00	105.11	0.00	0.00	0.00	0.00	0.00	0.00	0.00
Floor Terrace	1765.14	179.89	1585.25	168.00	46.85	0.00	0.00	0.00	1351.53	1351.53	0.00	0.00	0.00
Fourteenth Floor	1765.12	127.62	1637.50	168.00	46.84	0.00	0.00	0.00	1403.76	1403.76	07	0.00	0.00
Thirteenth Floor	2937.66	237.13	2700.53	172.70	46.85	0.00	0.00	0.00	2474.12	2474.12	08	0.00	0.00
Twelfth Floor	2937.67	170.72	2768.95	185.00	46.85	0.00	0.00	0.00	2537.40	2537.40	15	0.00	0.00
Tenth Floor	2947.25	170.56	2776.69	98.26	46.85	0.00	0.00	0.00	2631.58	2631.58	16	0.00	0.00
Ninth Floor	2947.25	170.56	2776.69	98.26	46.85	0.00	0.00	0.00	2631.58	2631.58	16	0.00	0.00
Eighth Floor	2947.25	170.56	2776.69	98.26	46.85	0.00	0.00	0.00	2631.58	2631.58	16	0.00	0.00
Seventh Floor	2947.25	170.56	2776.69	98.26	46.85	0.00	0.00	0.00	2631.58	2631.58	16	0.00	0.00
Sixth Floor	2947.25	170.56	2776.69	98.26	46.85	0.00	0.00	0.00	2631.58	2631.58	16	0.00	0.00
Fifth Floor	2947.25	170.56	2776.69	98.26	46.85	0.00	0.00	0.00	2631.58	2631.58	16	0.00	0.00
Fourth Floor	2947.25	170.56	2776.69	98.26	46.85	0.00	0.00	0.00	2631.58	2631.58	16	0.00	0.00
Third Floor	2947.25	170.56	2776.69	98.26	46.85	0.00	0.00	0.00	2631.58	2631.58	16	0.00	0.00
Second Floor	2947.02	170.56	2776.66	98.26	46.85	0.00	0.00	0.00	2631.35	2631.35	15	0.00	0.00
First Floor	2909.92	173.29	2736.63	98.26	46.85	0.00	160.97	0.00	2430.55	2430.55	15	0.00	0.00
Ground Floor	5584.40	214.26	5370.14	98.26	46.80	0.00	0.00	4703.98	5211.10	5211.10	00	599.10	0.00
Total	47593.19	2608.48	44984.70	2031.08	749.54	105.11	160.97	4703.98	37034.03	37034.03	205	599.10	0.00
Total of Same Blocks													
Total	47593.19	2608.48	44984.70	2031.08	749.54	105.11	160.97	4703.98	37034.03	37034.03	205	599.10	0.00

Block		Deductions From Gross BUA/area		Total Built Up Area (Sq.mt)		Deductions (Area in Sq.mt)					
Sl. No.	Block	No. of Semi Bldg	Gross Built Up Area (Sq.mt)	Deductions From Gross BUA/area (Sq.mt)	Total Built Up Area (Sq.mt)	StairCase	Lift	LR/ Railing	Void	SubStructure	R
BUILDING 1 (TOWER12)	BLOCK 1 (TOWER12)	1	73994.32	2910.59	70983.73	2409.06	942.94	105.11	160.81	0.00	79
			47953.19	2808.48	44144.71	2031.08	7489.54	10.00	160.97	0.00	
			2904.10	0.00	2904.10	0.00	0.00	0.00	0.00	0.00	
			124061.61	5719.07	118682.54	4371.17	11068.28	213.82	1150.32	255.42	79
BUILDING 2 (TOWER16)	BLOCK 2 (TOWER16)	1	2904.10	0.00	2904.10	0.00	0.00	0.00	0.00	0.00	
			124061.61	5719.07	118682.54	4371.17	11068.28	213.82	1150.32	255.42	79
			2904.10	0.00	2904.10	0.00	0.00	0.00	0.00	0.00	
			124061.61	5719.07	118682.54	4371.17	11068.28	213.82	1150.32	255.42	79
BUILDING 3 (TOWER16)	BLOCK 3 (TOWER16)	1	2904.10	0.00	2904.10	0.00	0.00	0.00	0.00	0.00	
			124061.61	5719.07	118682.54	4371.17	11068.28	213.82	1150.32	255.42	79
			2904.10	0.00	2904.10	0.00	0.00	0.00	0.00	0.00	
			124061.61	5719.07	118682.54	4371.17	11068.28	213.82	1150.32	255.42	79
BUILDING 4 (TOWER16)	BLOCK 4 (TOWER16)	1	2904.10	0.00	2904.10	0.00	0.00	0.00	0.00	0.00	
			124061.61	5719.07	118682.54	4371.17	11068.28	213.82	1150.32	255.42	79
			2904.10	0.00	2904.10	0.00	0.00	0.00	0.00	0.00	
			124061.61	5719.07	118682.54	4371.17	11068.28	213.82	1150.32	255.42	79
BUILDING 5 (TOWER16)	BLOCK 5 (TOWER16)	1	2904.10	0.00	2904.10	0.00	0.00	0.00	0.00	0.00	
			124061.61	5719.07	118682.54	4371.17	11068.28	213.82	1150.32	255.42	79
			2904.10	0.00	2904.10	0.00	0.00	0.00	0.00	0.00	
			124061.61	5719.07	118682.54	4371.17	11068.28	213.82	1150.32	255.42	79
BUILDING 6 (TOWER16)	BLOCK 6 (TOWER16)	1	2904.10	0.00	2904.10	0.00	0.00	0.00	0.00	0.00	
			124061.61	5719.07	118682.54	4371.17	11068.28	213.82	1150.32	255.42	79
			2904.10	0.00	2904.10	0.00	0.00	0.00	0.00	0.00	
			124061.61	5719.07	118682.54	4371.17	11068.28	213.82	1150.32	255.42	79
BUILDING 7 (TOWER16)	BLOCK 7 (TOWER16)	1	2904.10	0.00	2904.10	0.00	0.00	0.00	0.00	0.00	
			124061.61	5719.07	118682.54	4371.17	11068.28	213.82	1150.32	255.42	79
			2904.10	0.00	2904.10	0.00	0.00	0.00	0.00	0.00	
			124061.61	5719.07	118682.54	4371.17	11068.28	213.82	1150.32	255.42	79
BUILDING 8 (TOWER16)	BLOCK 8 (TOWER16)	1	2904.10	0.00	2904.10	0.00	0.00	0.00	0.00	0.00	
			124061.61	5719.07	118682.54	4371.17	11068.28	213.82	1150.32	255.42	79
			2904.10	0.00	2904.10	0.00	0.00	0.00	0.00	0.00	
			124061.61	5719.07	118682.54	4371.17	11068.28	213.82	1150.32	255.42	79

SITE PLAN
SCALE 1:400

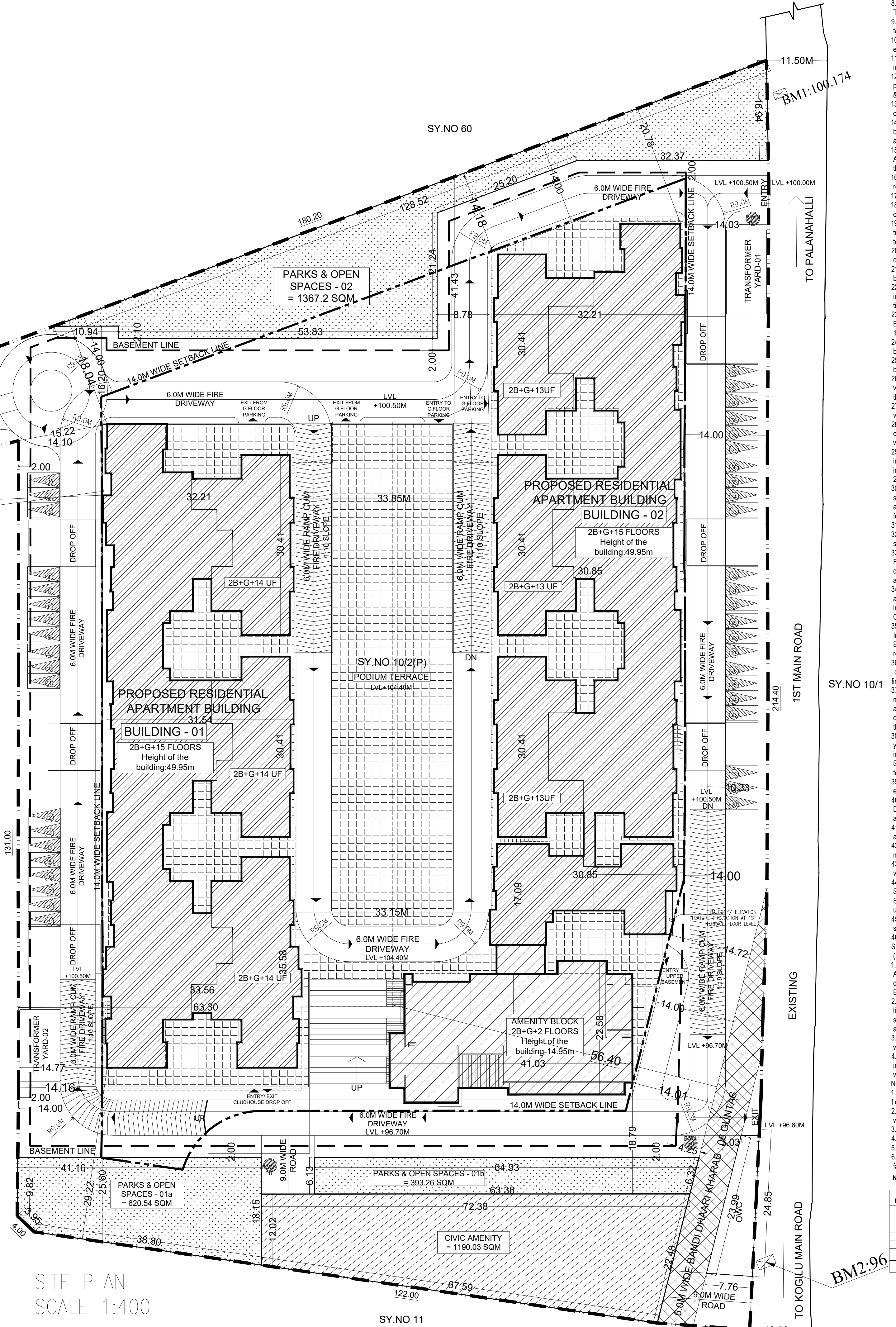

AREA STATEMENT (BBMP)		VERSION NO: 1.0.15 VERSION DATE: 19/02/2023	
PROJECT DETAIL:			
Authority: BBMP		Plot Use: Residential	
Project No: PB/24/56925-24		Plot Location: Apartment	
Application Type: General		Land Use: Zone: Residential (Altan)	
Proposed type: Building Permission		P&S/Plot No: 100/P/23(1A) AND 23(2A)	
Nature of Sanction: NEW		City Survey No: 100/P/23(1A) AND 23(2A)	
Location: RMC-18		Kata No: (As per Sheet of plan): 114/187/26220	
Building Line Specified as per Z.R. 2A		Plot Area/Sheet of the property: 15694.34 SQ. METER, YELAHANKA HOBLI	
Zone: Yelahanka			
Ward: Ward-001			
Planning District: 307-Yelahanka			
AREA DETAILS		SQ. MT.	
AREA OF PLOT (Minimum)		(A)	
NET AREA OF PLOT		(A) Deductions	
Deduction for Balance Plot Area			
Total		1190.02	
BALANCE AREA OF PLOT		(A) Deductions	
Coverage Area		2265.148	
Permissible Coverage area (50.00 %)		1130.264	
Permitted Coverage area (49.67 %)		1121.510	
Achieved Net Coverage area (165.67 %)		1123.150	
Balance coverage area left (0.33 %)		0.74	
FAR CHECK			
Permissible F.A.R. as per zoning regulation 2015 (3.25)		73484.07	
Additional F.A.R within Ring Road (I for semi-attached plot -)		0.00	
Allowable Total FAR (65% of Perm.FAR)		4780.00	
Premium FAR within Permitted Total Impose Zone (-)		0.00	
Total Perm. FAR cover (3.25)		7348.07	
Additional FAR (100.00 %)		7349.46	
Permitted FAR (4.25)		7349.46	
Achieved Net FAR Area (3.25)		7349.46	
Balance FAR Area (0.00)		0.41	
BUILT UP AREA CHECK			
Built up Plot Area		11869.23	
Sanctioned Area Add in BUA (Lapad/Li)		0.00	
Achieved Built Up Area		11869.24	

Vehicle Type	Reqd.		Achieved	
	No.	Area (Sq.mt.)	No.	Area (Sq.mt.)
Car	416	5720.00	533	7328.75
Visitor's Car Parking	42	577.50	0	0.00
Amenities Car Parking	35	481.25		7328.75
Total Car	458-35=493	6778.75	533	7328.75
Two/Wheeler	-	577.50	0	0.00
Other Parking	-	-	-	30319.68
Total		7356.25		37648.43

UNIT TYPE	UNIT BJA	CARPET	UNIT COUNT
UNIT TYPE-A	33 11	26 26	
UNIT TYPE-B&B1	40 73	32 91	35
UNIT TYPE-C	2827+M	123 58	104 29
UNIT TYPE-D&D1	2827+M+PD	146 18	127 69
UNIT TYPE-E&E1	3837+M	157 96	131 69
UNIT TYPE-F&F1	3837+M+PD	160 36	162 51
UNIT TYPE-G&G1	3837+M+PD	193 73	155 34
UNIT TYPE-H&H1	4847+PD+M	225 06	191 92
UNIT TYPE-J&J1		290 59	236 18
UNIT TYPE-K&K1	5857+2PD+M+M	346 78	275 02
UNIT TYPE-L&L1		408 55	321 49
TOTAL			379
CONVERSION FACTOR 1 SQM= 10.764 SFT			
UNIT AREAS FOR UNIT G.G1&K1 K1 AREA AVERAGE OF UNIT AREAS AT DIFFERENT LOCATION IN THE PERGEOT			

CONVERSION FACTOR 1 SQM= 10.764 SFT	0.0
UNIT AREAS FOR UNIT G.G1&K.K1 AREA AVERAGE OF UNIT AREAS AT DIFFERENT LOCATION IN THE PROJECT	

<p>OWNER'S ADDRESS WITH ID NUMBER & CONTACT NUMBER : MIS BRIGADE TETRARCH PRIVATE LIMITED. AUTHORIZED SIGNATORY GPA HOLDER FOR MIS BANGALORE CERAMICS No 29th and 30th floor WORLD TRADE CENTRE BRIGADE GRACE CAMPUS, No 251 D-Raykumar Road,Bangalore - 560055.</p>	<p>OWNER'S ADDRESS WITH ID NUMBER & CONTACT NUMBER : MIS BRIGADE TETRARCH PRIVATE LIMITED. AUTHORIZED SIGNATORY GPA HOLDER FOR MIS BANGALORE CERAMICS No 29th and 30th floor WORLD TRADE CENTRE BRIGADE GRACE CAMPUS, No 251 D-Raykumar Road,Bangalore - 560055.</p>	<p>OWNER'S ADDRESS WITH ID NUMBER & CONTACT NUMBER : MIS BRIGADE TETRARCH PRIVATE LIMITED. AUTHORIZED SIGNATORY GPA HOLDER FOR MIS BANGALORE CERAMICS No 29th and 30th floor WORLD TRADE CENTRE BRIGADE GRACE CAMPUS, No 251 D-Raykumar Road,Bangalore - 560055.</p>
<p>ARCHITECT/ENGINEER SUPERVISOR : ABHAY ITTY ZACHARIAH RC06BL3-6-A-2027-09-10 NO.65 ASLEY PARK, OFF BURTON ROAD, BANGALORE.</p>	<p>ARCHITECT/ENGINEER SUPERVISOR : ABHAY ITTY ZACHARIAH RC06BL3-6-A-2027-09-10 NO.65 ASLEY PARK, OFF BURTON ROAD, BANGALORE.</p>	<p>ARCHITECT/ENGINEER SUPERVISOR : ABHAY ITTY ZACHARIAH RC06BL3-6-A-2027-09-10 NO.65 ASLEY PARK, OFF BURTON ROAD, BANGALORE.</p>
<p>PROJECT TITLE : PROPOSED RESIDENTIAL APARTMENT @BOMP KATHA No.1141/307/262/200 @ No. 100/1P/23/116 AND 23/27A, YENKATA VILLAGE,YELHANAKA HOBLI DEMPEGOWDA, WARD No.1,BANGALORE.</p>	<p>PROJECT TITLE : PROPOSED RESIDENTIAL APARTMENT @BOMP KATHA No.1141/307/262/200 @ No. 100/1P/23/116 AND 23/27A, YENKATA VILLAGE,YELHANAKA HOBLI DEMPEGOWDA, WARD No.1,BANGALORE.</p>	<p>PROJECT TITLE : PROPOSED RESIDENTIAL APARTMENT @BOMP KATHA No.1141/307/262/200 @ No. 100/1P/23/116 AND 23/27A, YENKATA VILLAGE,YELHANAKA HOBLI DEMPEGOWDA, WARD No.1,BANGALORE.</p>
<p>DRAWING TITLE : SITE PLAN.</p>	<p>DRAWING TITLE : SITE PLAN.</p>	<p>DRAWING TITLE : SITE PLAN.</p>
<p>SHEET NO : 1</p>	<p>SHEET NO : 1</p>	<p>SHEET NO : 1</p>

This approval of Building plan/ Modified plan is valid for two years from the date of issue of plan and building licence by the competent authority.

HO – NORTH