

Sanctioned No. B.P./PCNTDA/Ravet/213/25
 Subject to conditions mentioned in the
 Office Order No.
 even dated 29/08/25



Pimpri
 Date: 29/08/2025

Executive Engineer
 Building Permission and Unauthorised Building
 Construction Control Department
 Pimpri Chinchwad Municipal Corporation
 Pimpri-411 018.

PARKING STATEMENT :-		
FLOORS	CAR	SCOOTER
REQUIRED PARKING	71	128
PROPOSED PARKING		
BASEMENT-02	59	69
BASEMENT-01	57	69
GROUND PARKING	14	15
PROPOSED PARKING	130	153



BASMENT LEVEL 01 FLOOR PLAN

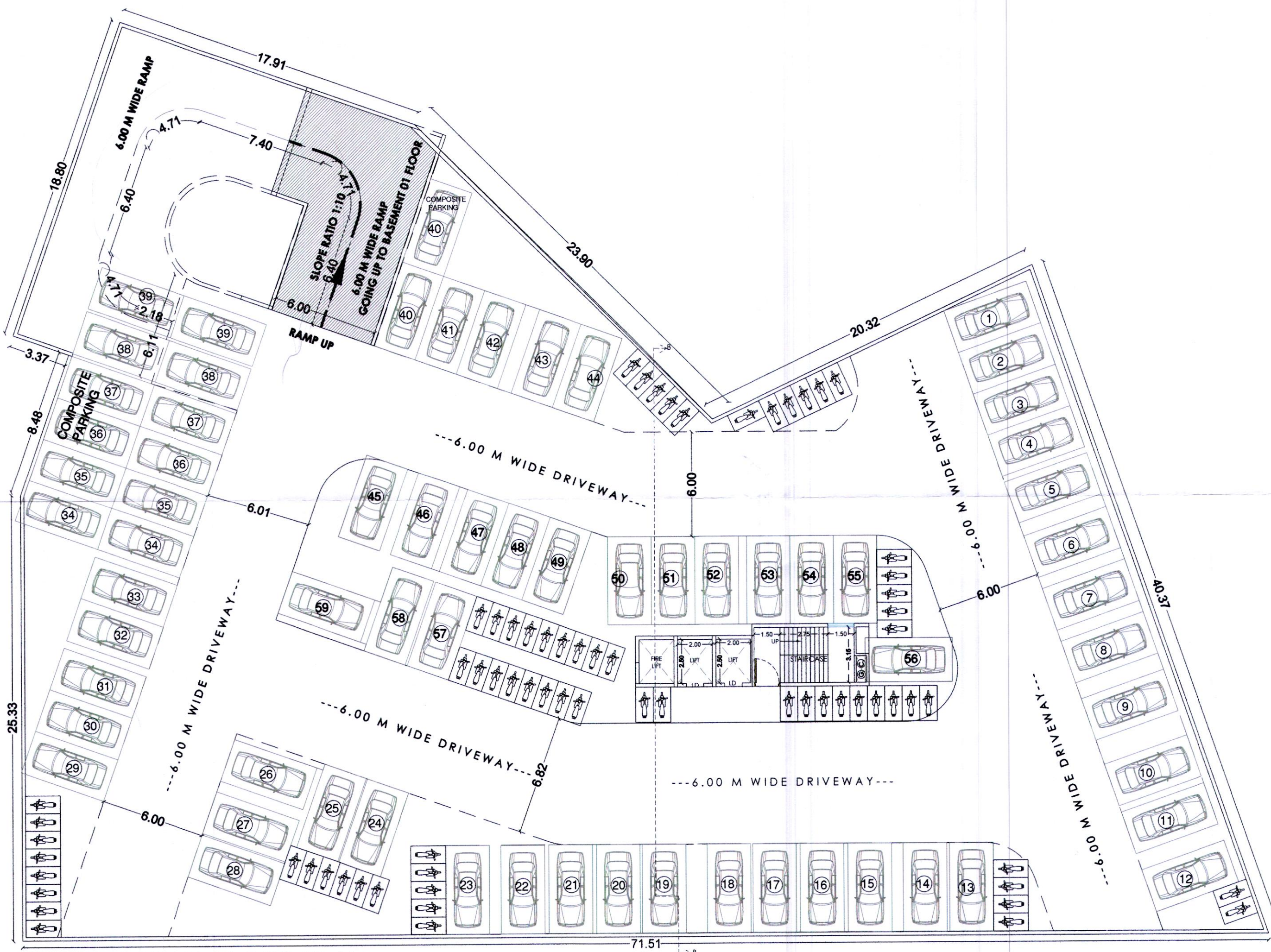

BASMENT LEVEL 02 FLOOR PLAN

H. OWNER'S /DEVELOPER NAME AND SIGNATURE :-

KRISHNA RAMA REALTORS THOUGH
 MR. KAPIL AGARWAL & OTHERS

Owner's SIGN.

I. PROJECT NAME :- RESIDENTIAL/COMMERCIAL

VILLAGE :- RAVET, TAL :- HAVELI, DIST :- PUNE

AR. SHEKHAR NAHAR

SECTOR.NO. :- 32A PLOT NO- 18,19,20,21,24

H.No. :-

P.No. :-

Discrepancy :- REGULAR TRACK

ARCON

ASSOCIATES

ARCHITECTS + PLANNERS + INTERIOR DESIGNERS
 SAFALYA BUNGALOW, BESIDE KHANDASH MARATHA MANDAL
 KANCH GHAR CHOWK, SECTOR 24, MIDC-PRADHAKARAN,
 PUNE - 44. HELLO : 020-27650921 L 9767978037 / 9890723478

ARCHITECT'S SIGN.



SCALE	DRG.NO.	DRAWN BY	CHECKED BY
1:100		MR. SAM	AR. SHEKHAR
INWARD NO.	DATE		
	12.08.2025		
KEY NO.	SHEET NO.		
	02/09		